

Excellent Integrated System Limited

Stocking Distributor

Click to view price, real time Inventory, Delivery & Lifecycle Information:

[Amphenol RF](#)
[112536](#)

For any questions, you can email us directly:

sales@integrated-circuit.com



REV.	DATE	DESCRIPTION
A	06/13/97	CHANGE PIN LOCATIONS TO 12.7 SQ.
B	11/11/97	REDIMENSION/ ADD 50 ohms TO DESCRIPTION
C	11/20/98	ADD MOUNTING DIMENSIONS

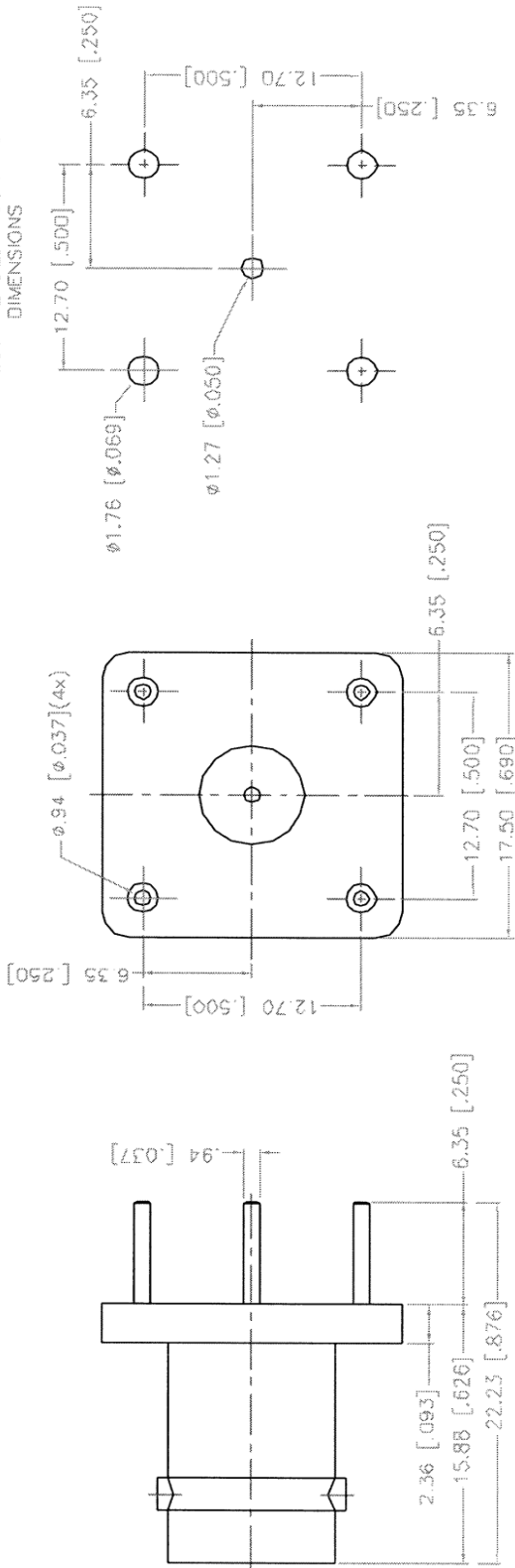

DESCRIPTION	MATERIAL	FINISH	UNLESS OTHERWISE SPECIFIED DIMENSIONS ARE IN MILLIMETERS DIMENSIONS IN () ARE IN INCHES FOR CUSTOMER REFERENCE ONLY	APPROVALS	DATE
1 BODY	BRASS	NICKEL	UNLESS OTHERWISE SPECIFIED TOLERANCES FOR MILLIMETERS ARE: 0.5-6 = ± 0.2 6-30 = ± 0.4 30-120 = ± 0.6 120-315 = ± 1 315-1000 = ± 1.6 1000-2000 = ± 2.4	DRAWN G.R.S.	11/20/98
2 INSULATOR	TEFLON	NATURAL		CHECKED	
3 CONTACT PIN	PHOS. BRONZE	GOLD		ISSUED	
4					
5					
6					
7					
8			DO NOT SCALE DRAWING		

Connex Connector Corporation	
TITLE	BNC P.C. MOUNT RECEPTACLE JACK - 50 ohms
SIZE	A
FSCM NO.	99001
DWG. NO.	112536.DWG
REV.	C
SCALE	NA
PART NO.	112536
SHEET	1 OF 1