

Excellent Integrated System Limited

Stocking Distributor

Click to view price, real time Inventory, Delivery & Lifecycle Information:

[Amphenol RF](#)
[122108](#)

For any questions, you can email us directly:

sales@integrated-circuit.com

REV.	DATE	ECR NO.	DESCRIPTION
A	12/23/02	-	MODIFY CONTACT PIN LENGTH TO 12.25mm
B	07/16/08	-	MODIFY CONTACT PIN LENGTH TO 12.40mm

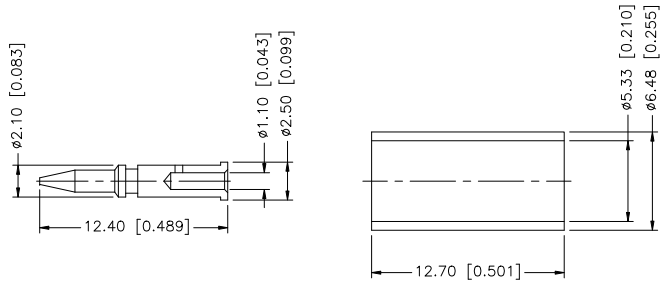
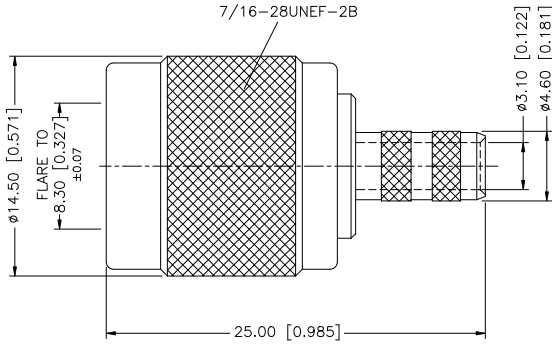
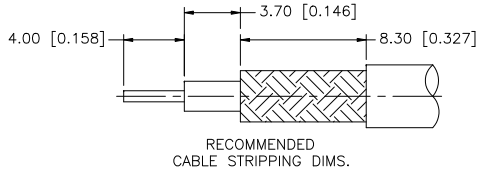

NOTE:

1. CRIMPED FERRULE HEX CRIMP SIZE .213" [5.41]
2. CRIMPED CONTACT PIN HEX CRIMP SIZE .068" [1.73]

DESCRIPTION	MATERIAL	FINISH	QTY	DO NOT SCALE DRAWING	APPROVALS	DATE	Amphenol Connex								
8					DRAWN	G.R.S.	07/16/08	PART DESCRIPTION TNC STRAIGHT CRIMP PLUG-CAPTIVE CONTACT (FOR RG-58/U CABLE)							
7					CHECKED										
6					ISSUED			PART NO. 122108							
5	FERRULE	BRASS	NICKEL	1	SHEET	1 OF 1									
4	GASKET	RUBBER	RED	1	CAD FILE C:/122/122108.DWG			DWG. NO.	122108.DWG	REV.	B	SIZE	A	SCALE	NA
3	INSULATOR	DELTRIN	NATURAL	1											
2	CONTACT PIN	BRASS	GOLD	1											
1	SHELL/BODY	BRASS	NICKEL	1											

UNLESS OTHERWISE SPECIFIED DIMENSIONS ARE IN MILLIMETERS. DIMENSIONS IN [] ARE IN INCHES AND FOR CUSTOMER REFERENCE ONLY.

UNLESS OTHERWISE SPECIFIED TOLERANCES FOR MILLIMETERS ARE:
 0.5 - 8mm ± 0.20mm
 8 - 30mm ± 0.40mm
 30 - 120mm ± 0.50mm

UNLESS OTHERWISE SPECIFIED TOLERANCES FOR INCHES ARE:
 .020 - .315 = ± 0.007"
 .315 - 1.180 = ± 0.015"
 1.180 - 4.724 = ± 0.020"