

## **Excellent Integrated System Limited**

Stocking Distributor

Click to view price, real time Inventory, Delivery & Lifecycle Information:

[Amphenol RF](#)  
[122416](#)

For any questions, you can email us directly:

[sales@integrated-circuit.com](mailto:sales@integrated-circuit.com)

REV.	DATE	ECR NO.	DESCRIPTION
A	04/05/03	-	UPDATE DRAWING FORMAT
B	08/04/08	-	REVISE PART DESCRIPTION FROM "JACK" TO "PLUG"

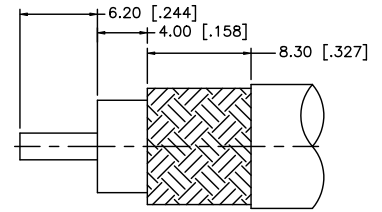
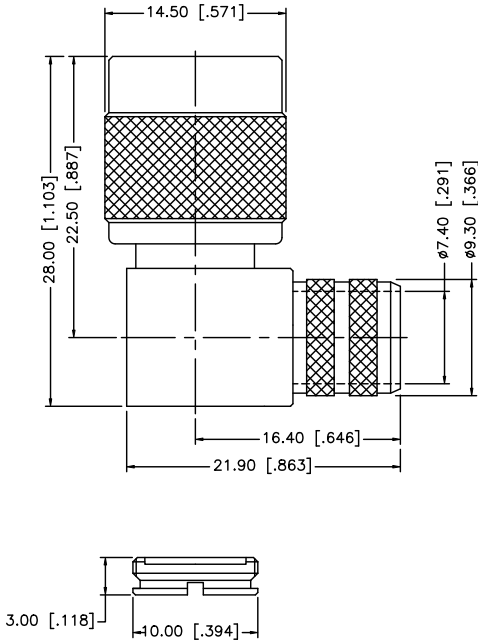

RECOMMENDED  
CABLE STRIPPING DIM'S

DESCRIPTION	MATERIAL	FINISH	QTY	APPROVALS	DATE	Amphenol Connex
8						
7				DRAWN GRS	08/04/08	
6	COVER	BRASS	NICKEL	1	CHECKED	PART NO. <b>122416</b>
5	FERRULE	COPPER	NICKEL	1	ISSUED	
4	GASKET	RUBBER	RED	1	SHEET 1 OF 1	DWG. NO. 122416.DWG
3	CONTACT PIN	BRASS	GOLD	1		
2	INSULATOR	PTFE	NATURAL	1		REV. B
1	HOUSING/BODY	BRASS	NICKEL	1		SIZE A
DO NOT SCALE DRAWING				CAD FILE C:/122/122416.DWG		SCALE NA

UNLESS OTHERWISE SPECIFIED DIMENSIONS ARE IN MILLIMETERS. DIMENSIONS IN [ ] ARE IN INCHES AND FOR CUSTOMER REFERENCE ONLY.

UNLESS OTHERWISE SPECIFIED TOLERANCES FOR MILLIMETERS ARE:  
 0.5 - 8mm ± 0.20mm  
 8 - 30mm ± 0.40mm  
 30 - 120mm ± 0.50mm

UNLESS OTHERWISE SPECIFIED TOLERANCES FOR INCHES ARE:  
 .020 - .315 = ± 0.007"  
 .315 - 1.180 = ± 0.015"  
 1.180 - 4.724 = ± 0.020"