

Excellent Integrated System Limited

Stocking Distributor

Click to view price, real time Inventory, Delivery & Lifecycle Information:

[Amphenol RF](#)
[132168](#)

For any questions, you can email us directly:

sales@integrated-circuit.com

REV.	DATE	DESCRIPTION
A	11/26/03	UPDATE DRAWING FORMAT

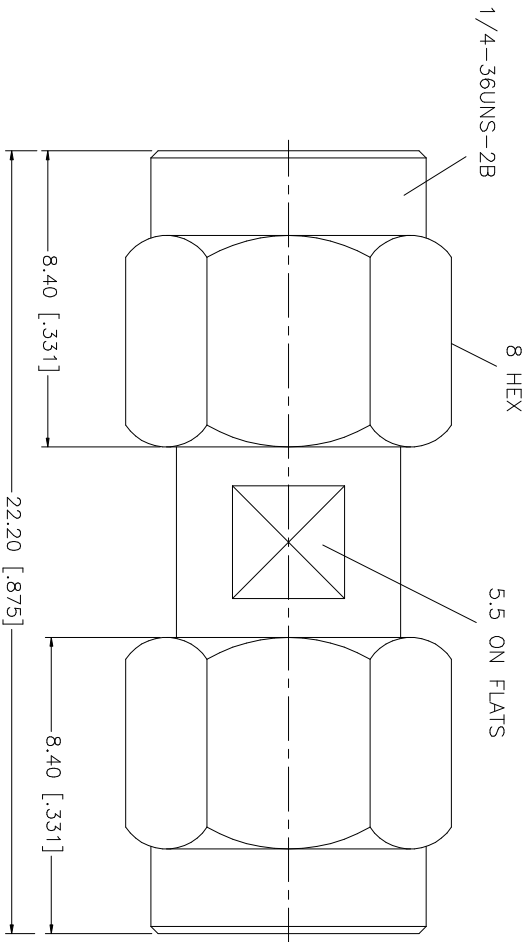

QTY	DESCRIPTION	MATERIAL	FINISH	QTY	UNLESS OTHERWISE SPECIFIED DIMENSIONS ARE IN MILLIMETERS DIMENSIONS IN [] ARE IN INCHES AND FOR CUSTOMER REFERENCE ONLY.	UNLESS OTHERWISE SPECIFIED TOLERANCES FOR MILLIMETERS ARE:	UNLESS OTHERWISE SPECIFIED TOLERANCES FOR INCHES ARE:	APPROVALS	DATE	PART DESCRIPTION							
1	CONTACT PIN	BER.COPPER	GOLD	1	0.5 - 8mm ± 0.20mm	.020 - .315 = ± 0.007"		DRAWN	11/26/03	Amphenol Connex SMA PLUG ADAPTER PART NO. 132168							
1	INSULATOR	TEFLON	NATURAL	1	8 - 30mm ± 0.40mm	.315 - 1.180 = ± 0.015"		CHECKED									
1	BODY	BRASS	GOLD	1	30 - 120mm ± 0.50mm	1.180 - 4.724 = ± 0.020"		ISSUED									
								SHEET	1 OF 1								
	DESCRIPTION	MATERIAL	FINISH	QTY	DO NOT SCALE DRAWING			CAD FILE	C:/132/132168.DWG	DWG. NO.	132168.DWG	REV.	A	SIZE	A	SCALE	NA