

Excellent Integrated System Limited

Stocking Distributor

Click to view price, real time Inventory, Delivery & Lifecycle Information:

[Amphenol RF](#)
[132169RP](#)

For any questions, you can email us directly:

sales@integrated-circuit.com

REV.	DATE	DESCRIPTION
NC	04/06/03	INITIAL RELEASE

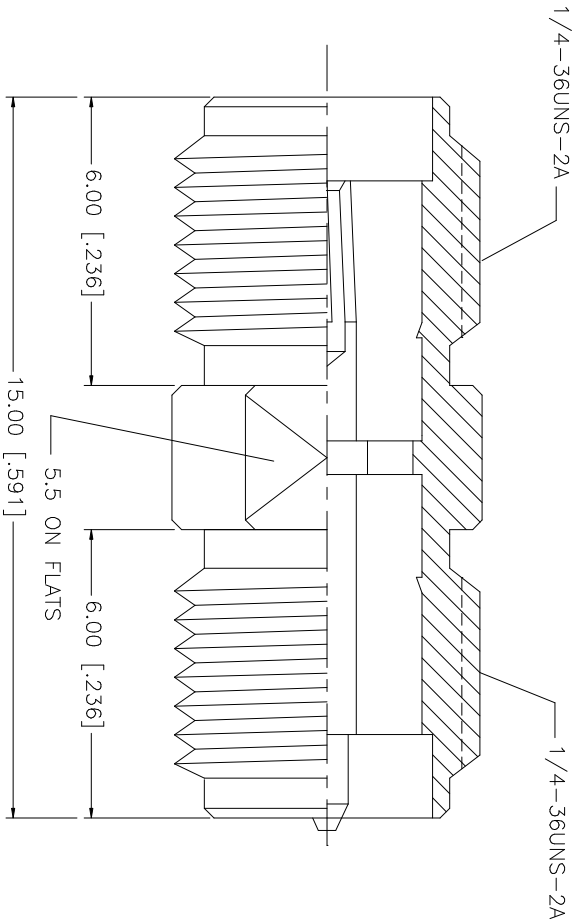

8					UNLESS OTHERWISE SPECIFIED DIMENSIONS ARE IN MILLIMETERS. DIMENSIONS IN [] ARE IN INCHES AND FOR CUSTOMER REFERENCE ONLY.	APPROVALS	DATE	<div>Amphenol Connex</div> <div>PART DESCRIPTION</div> <div>SMA JACK TO REVERSE POLARITY JACK ADAPTER</div> <div>PART NO. 132169RP</div>							
7						DRAWN	G.R.S.		04/06/03						
6						CHECKED									
5						ISSUED									
4						SHEET	1 OF 1								
3	CONTACT PIN	BER. COPPER	GOLD	1	UNLESS OTHERWISE SPECIFIED TOLERANCES FOR INCHES ARE: .020 - .315 = ± 0.007" .315 - 1.180 = ± 0.015" 1.180 - 4.724 = ± 0.020"			DWG. NO.	132169RP.DWG	REV.	NC	SIZE	A	SCALE	NA
2	INSULATOR	TEFLON	NATURAL	1					PART NO.						
1	HOUSING/BODY	BRASS	GOLD	1											
	DESCRIPTION	MATERIAL	FINISH	QTY	DO NOT SCALE DRAWING	CAD FILE	C:/132/132169RP.DWG								