

Excellent Integrated System Limited

Stocking Distributor

Click to view price, real time Inventory, Delivery & Lifecycle Information:

[Amphenol RF](#)
[142138-75](#)

For any questions, you can email us directly:

sales@integrated-circuit.com

REV.	DATE	DESCRIPTION
A	05/01/04	UPDATE DRAWING FORMAT

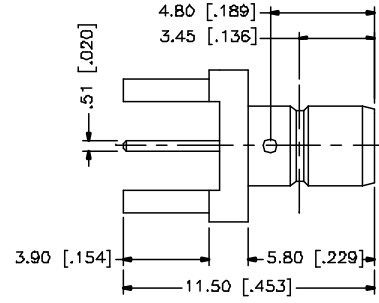
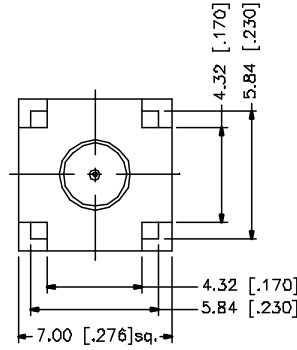
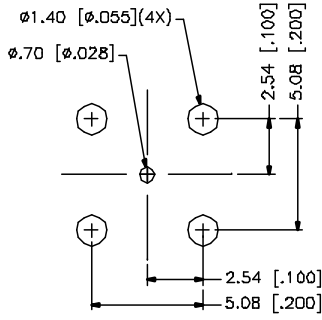

8				<small>UNLESS OTHERWISE SPECIFIED DIMENSIONS ARE IN MILLIMETERS. DIMENSIONS IN [] ARE IN INCHES AND FOR CUSTOMER REFERENCE ONLY.</small> <small>UNLESS OTHERWISE SPECIFIED TOLERANCES FOR MILLIMETERS ARE:</small> 0.5 - 3mm ± 0.20mm 3 - 30mm ± 0.40mm 30 - 120mm ± 0.50mm <small>UNLESS OTHERWISE SPECIFIED TOLERANCES FOR INCHES ARE:</small> .020 - .315 = ± 0.007" .315 - 1.180 = ± 0.015" 1.180 - 4.724 = ± 0.020"	APPROVALS	DATE	<h1 style="color: blue; margin: 0;">Amphenol Connex</h1>		
7			DRAWN		G.R.S.	05/01/04		SMB P.C. MOUNTING JACK - MINI 75ohm	
6			CHECKED						
5			ISSUED						
4			SHEET		1 OF 1				
3	CONTACT PIN	BRASS	GOLD		1				PART NO.
2	INSULATOR	TEFLON	NATURAL		1				142138-75
1	HOUSING/BODY	BRASS	GOLD		1				
	DESCRIPTION	MATERIAL	FINISH	QTY	DD NOT SCALE DRAWING	C:/142/142138-75.DWG	DWG. NO. 142138-75.DWG REV. A SIZE A SCALE NA		