

Excellent Integrated System Limited

Stocking Distributor

Click to view price, real time Inventory, Delivery & Lifecycle Information:

[NKK Switches](#)

[MB2011SB1W01-DA](#)

For any questions, you can email us directly:

sales@integrated-circuit.com

Large Bushing Miniature Pushbuttons

Series MB2000

TYPICAL SWITCH ORDERING EXAMPLE

MB 2011 S B1 W 01 — D A

Poles & Circuits

| | | | |
|------|------|----|------|
| 2011 | SPDT | ON | (ON) |
| 2065 | SPDT | ON | ON |
| 2061 | DPDT | ON | (ON) |
| 2085 | DPDT | ON | ON |
| 2181 | 4PDT | ON | (ON) |
| 2185 | 4PDT | ON | ON |

() = Momentary

Plunger Type

| | |
|---|---------------------------|
| S | Plunger for Screw-on Caps |
|---|---------------------------|

Bushings

| | |
|----|------------------------------------------|
| B1 | .472" (12.0mm) Threaded with Keyway |
| B3 | .472" (12.0mm) Threaded w/Splashproof |

Contact Materials & Ratings

| | |
|---|------------------------------------------------|
| W | Silver Rated 6A @ 125V AC & 3A @ 250V AC |
| G | Gold Rated 0.4VA max @ 28V AC/DC max |

Terminals

| | |
|----|----------------------------|
| 01 | Solder Lug * |
| 02 | Quick Connect |
| 03 | .250" (6.35mm) Straight PC |
| 05 | .425" (10.8mm) Wirewrap |
| 06 | .750" (19.05mm) Wirewrap |
| 07 | .964" (24.5mm) Wirewrap |
| 08 | 1.062" (27.0mm) Wirewrap |

Caps

| | |
|---|-------------------------|
| B | .315" (8.0mm) Diameter |
| C | .394" (10.0mm) Diameter |
| D | .520" (13.2mm) Diameter |
| E | .748" (19.0mm) Diameter |

Cap Colors

| | |
|----|--------|
| A | Black |
| B | White |
| C | Red |
| *D | Amber |
| *E | Yellow |
| F | Green |
| *G | Blue |
| *H | Gray |

* Not available with cap code E

* Wire harness & cable assemblies offered only in Americas

IMPORTANT:



Switches are supplied without UL, cULus & CSA marking unless specified. **UL, cULus & CSA recognized only when ordered with marking on the switch.** Specific models, ratings, & ordering instructions are noted on General Specifications page.

DESCRIPTION FOR TYPICAL ORDERING EXAMPLE

MB2011SB1W01-DA

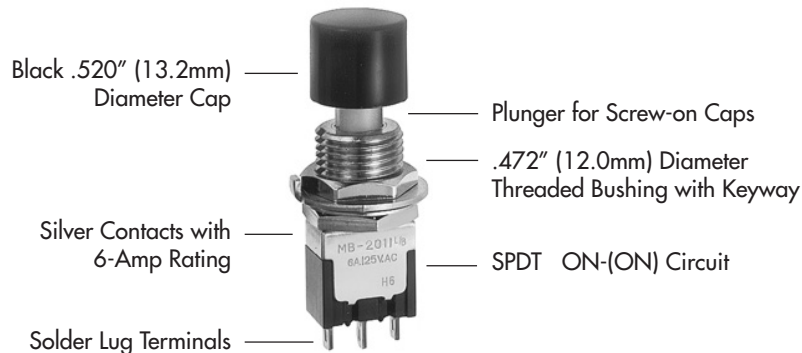

Supplement
Accessories
Indicators
Touch
Tilt
Tactiles
Slides
Rotaries
Keylocks
Programmable Illuminated PB
Pushbuttons
Rockers
Toggles

Series MB2000

Large Bushing Miniature Pushbuttons

Toggles

Rockers

Pushbuttons

Illuminated PB

Programmable

Keylocks

Rotaries

Slides

Tactiles

Tilt





Touch

Indicators

Accessories

Supplement

POLES & CIRCUITS

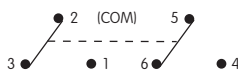
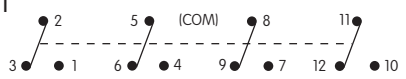
| Pole | Model | Plunger Position () = Momentary | | Connected Terminals | | Throw & Switch Schematics |
|------|--------|----------------------------------------------------------------------------------------------------|-------------------------------------------------------------------------------------------|----------------------------------------------------------------------------------------------------|-------------------------------------------------------------------------------------------|---------------------------------------------------------------------------------------------|
| | | Normal  Keyway | Down  | Normal  Keyway | Down  | |
| SP | MB2011 | ON | (ON) | 2-3 | 2-1 | SPDT  |
| | MB2065 | ON | ON | | | |
| DP | MB2061 | ON | (ON) | 2-3 5-6 | 2-1 5-4 | DPDT  |
| | MB2085 | ON | ON | | | |
| 4P | MB2181 | ON | (ON) | 2-3 5-6 8-9 11-12 | 2-1 5-4 8-7 11-10 | 4PDT  |
| | MB2185 | ON | ON | | | |

PLUNGER TYPE

S

Plunger for Screw-on Caps
Plunger is plastic for B1 bushing.

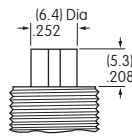

Plunger is metal for B3 bushing.

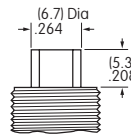

On alternate action models, after transferring circuit, the plunger returns to its original position, and does not latch down.

BUSHINGS

B1

.472" (12.0mm) Diameter Threaded with Keyway

Maximum Panel Thickness with Standard Hardware: .217" (5.5mm)

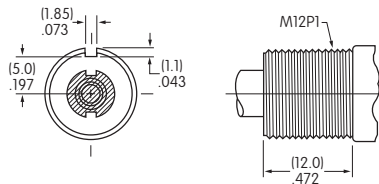

B3

.472" (12.0mm) Diameter Threaded Splashproof

Maximum Panel Thickness with Standard Hardware: .217" (5.5mm)

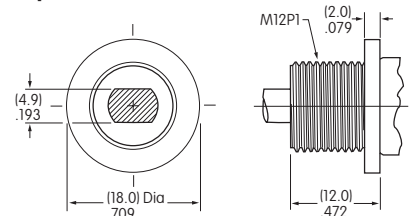

Panel Cutouts

For B1 Bushing with Keyway

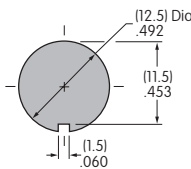

For B1 Bushing with Locking Ring

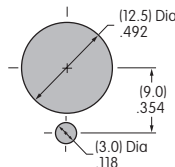

For B3 Bushing without Keyway

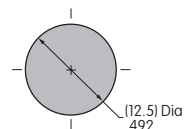

CONTACT MATERIALS & RATINGS

W

Silver over Silver

Power Level

6A @ 125V AC & 3A @ 250V AC

G

Gold over Brass or Copper

Logic Level

0.4VA maximum @ 28V AC/DC maximum

Note: Complete explanation of operating range in Supplement section.

Large Bushing Miniature Pushbuttons

Series MB2000

TERMINALS

01 Solder Lug

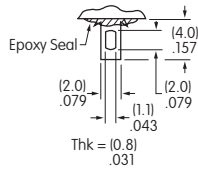

02 .062" (1.57mm) Wide Quick Connect

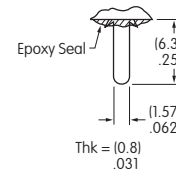

03 .250" (6.35mm) Straight PC

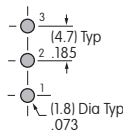
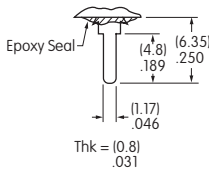

Single Pole

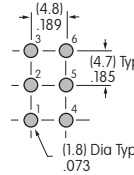

Double Pole

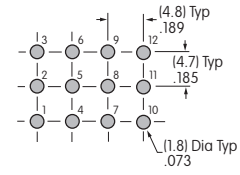

Four Pole

05 .425" (10.8mm) Wirewrap or Extended PC

06 .750" (19.05mm) Wirewrap or Extended PC

07 .964" (24.5mm) Wirewrap or Extended PC

08 1.062" (27.0mm) Wirewrap or Extended PC

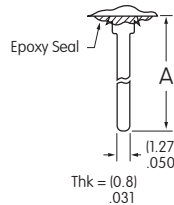

If using as extended PC terminal, refer to the above footprints.

Dimension A = terminal lengths as shown beside the terminal codes at the left.

CAPS & CAP COLORS

B AT078
.315" (8.0mm)
Diameter Screw-on Cap

C AT079
.394" (10.0mm)
Diameter Screw-on Cap

D AT414
.520" (13.2mm)
Diameter Screw-on Cap

E AT412
.748" (19.0mm)
Diameter Screw-on Cap

Material:
Polystyrene
Finish:
Glossy



Material:
Polystyrene
Finish:
Glossy



Material:
PBT
Finish:
Glossy



Material:
Polystyrene
Finish:
Glossy



Colors Available:
A B C E F G H

Colors Available:
A B C E F G H

Colors Available:
A B C D E F G H

Colors Available:
A B C F

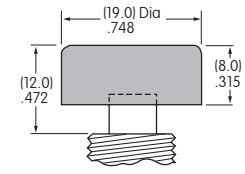
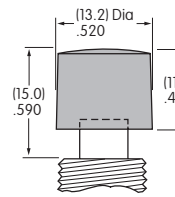
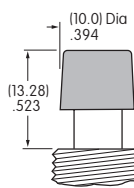
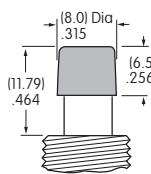

Cap Color
Codes:

- A** Black
- B** White
- C** Red
- D** Amber
- E** Yellow
- F** Green
- G** Blue
- H** Gray

Toggles
Rockers
Pushbuttons
Illuminated PB
Programmable
Keylocks
Rotaries
Slides
Tactiles
Tilt
Touch
Indicators
Accessories
Supplement

Series MB2000

Large Bushing Miniature Pushbuttons

TYPICAL SWITCH DIMENSIONS

Solder Lug

Single Pole

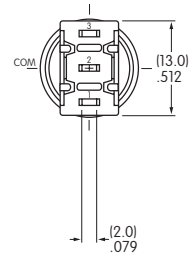
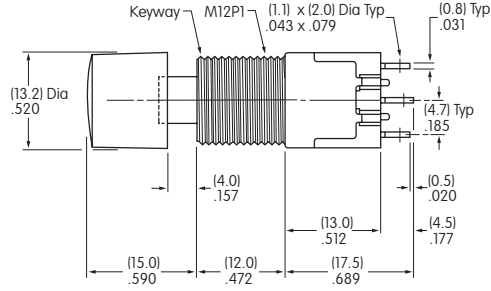
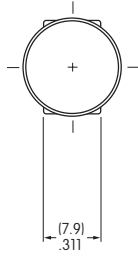

MB2011SB1W01-DA

Solder Lug

Double Pole

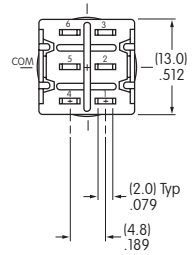
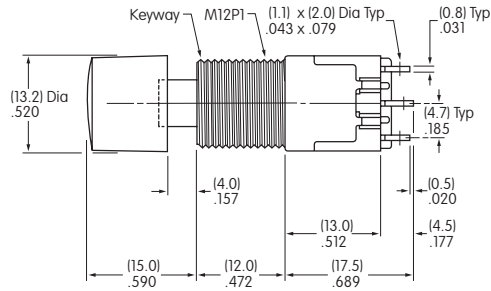
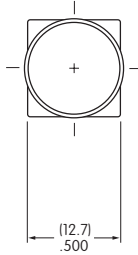

MB2061SB1W01-DA

Solder Lug

Four Pole

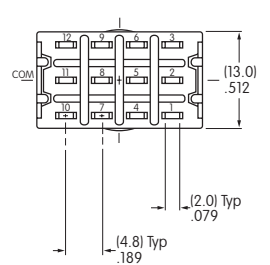
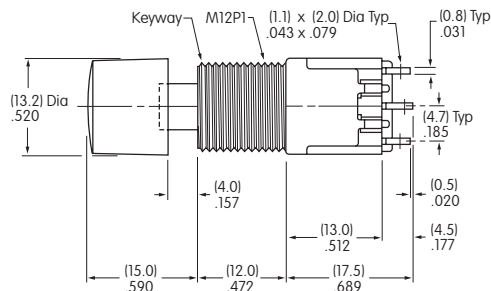
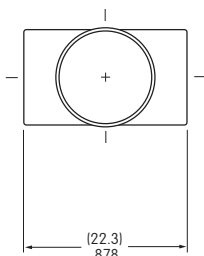

MB2181SB1W01-DA

Toggles

Rockers

Pushbuttons

Illuminated PB

Programmable

Keylocks

Rotaries

Slides

Tactiles

Tilt

Touch

Indicators

Accessories

Supplement

Large Bushing Miniature Pushbuttons

Series MB2000

HARDWARE

Standard Hardware for B1 Bushing

**AT503M
Hex Face Nut**

Material:
Brass with Chrome plating

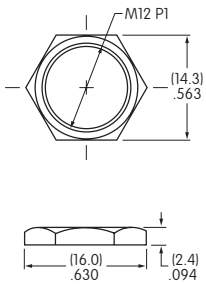

**AT508
Lockwasher**

Material:
Steel with Zinc/Chromate

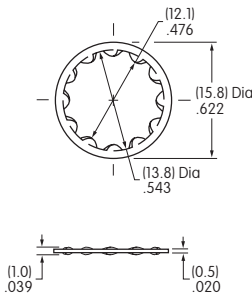

**AT527M
Hex Nut**

Material:
Steel with Nickel plating

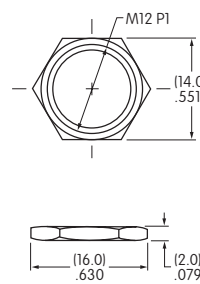

**AT506M
Locking Ring**

Material:
Steel with Zinc/Chromate

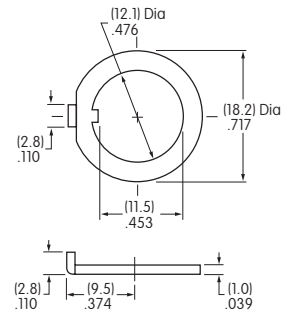

Standard Hardware for B3 Bushing

**AT503M
Hex Face Nut**

Material:
Brass with Chrome plating

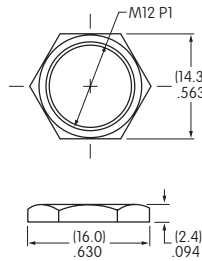

**AT401P
O-ring**

Material:
Nitrile butadiene rubber

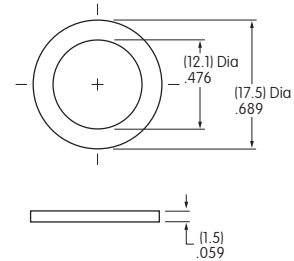

Optional Splashproof Boot for B1 Bushing

**AT4043
Splashproof Boot**

Material: Silicone Rubber
 Operating Life: 10,000 for momentary
 30,000 for alternate action

When using a splashproof boot, no cap is required.

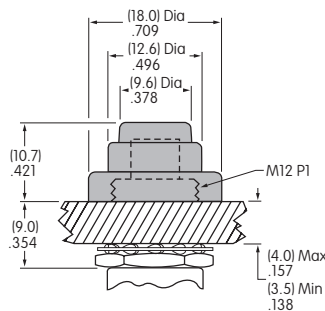

Toggles
Rocker
Pushbuttons
Illuminated PB
Keylocks
Rotaries
Slides
Tactiles
Tilt
Touch
Indicators
Accessories
Supplement

Series MB2000

Large Bushing Miniature Pushbuttons

CUSTOM ASSEMBLY ORDERING EXAMPLE

The MB2000 pushbutton series offers flexibility to accommodate a variety of applications. Using a basic large bushing model, different accessories can be assembled onto the switch to achieve the mounting variations shown on the following two pages.

- These switches have:
- 12mm diameter threaded bushing with keyway
 - Silver contacts
 - 6-Amp rating
 - Solder lug terminals

Other 12mm bushing options can be used; see details in preceding Large Bushing Ordering tables.

MB2011

SB1W01

4

C

A

| Poles & Circuits | | | |
|------------------|------|----|------|
| 2011 | SPDT | ON | (ON) |
| 2065 | SPDT | ON | ON |
| 2061 | DPDT | ON | (ON) |
| 2085 | DPDT | ON | ON |
| 4-pole available | | | |
| () = Momentary | | | |

| Mounter Shapes For Shroud | |
|---------------------------|-------------|
| 4 | Round |
| 5 | Rectangular |

| Cap Colors For Shroud | |
|-----------------------|-------|
| A | Black |
| B | White |
| C | Red |
| F | Green |
| G | Blue |
| H | Gray |

| Mounter Colors For Shroud | |
|---------------------------|-------|
| A | Black |
| B | White |
| H | Gray |

| Cap Colors For Snap-In | |
|------------------------|-------|
| A | Black |
| B | White |
| C | Red |
| F | Green |



Round Shroud
MB2011SB1W01-4C-A



Rectangular Shroud
MB2011SB1W01-5C-A

See custom assemblies on following pages.

Large Bushing Miniature Pushbuttons

Series MB2000

MOUNTER SHAPES FOR SHROUDS

4 AT455 Round

Material: Polycarbonate
 Colors: A B H



5 AT453 Rectangular

Material: Polycarbonate
 Colors: A B H



CAPS & CAP COLORS FOR SHROUDS

AT454 Round Insert Cap

Material: Polycarbonate
 Colors: A B C F G H



AT452 Rectangular Insert Cap

Material: Polycarbonate
 Colors: A B C F G H

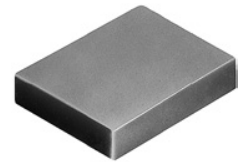

AT080 Screw Adaptor for Insert Caps

Material: Brass



Color Codes:

A Black **B** White **C** Red **F** Green **G** Blue **H** Gray

Supplement
 Accessories
 Indicators
 Touch
 Tilt
 Tactiles
 Slides
 Rotaries
 Keylocks
 Programmable Illuminated PB
 Pushbuttons
 Rockers
 Toggles

Series MB2000

Large Bushing Miniature Pushbuttons

CUSTOM ASSEMBLY WITH ROUND SHROUD



MB2011SB1W01-4C-A

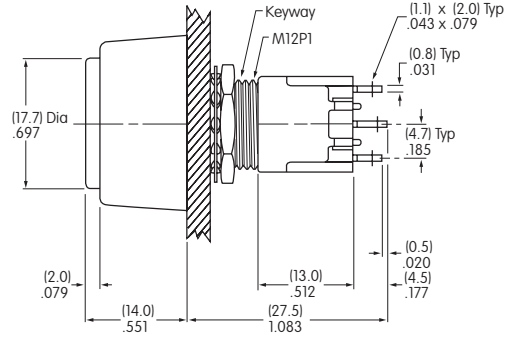
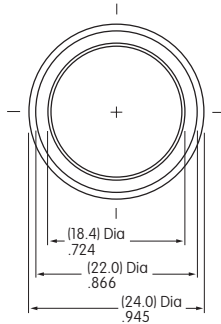

Single Pole

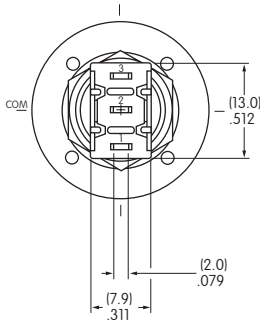

Double Pole

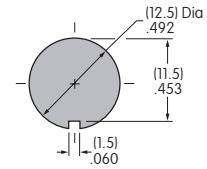
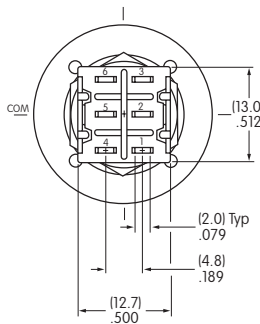

Effective Panel Thickness:
.217" (5.5mm) maximum

CUSTOM ASSEMBLY WITH RECTANGULAR SHROUD



MB2011SB1W01-5C-A

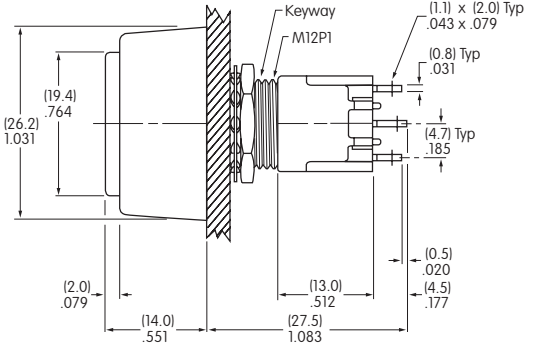
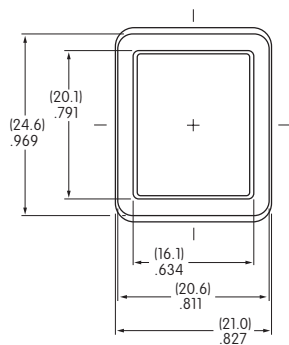

Single Pole

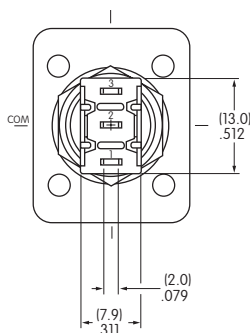

Double Pole

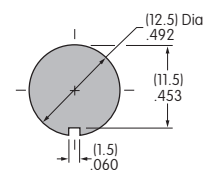
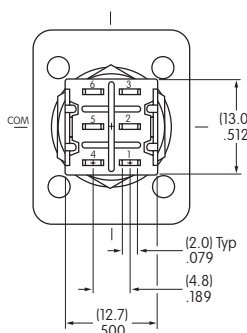

Effective Panel Thickness:
.217" (5.5mm) maximum

Notes
