

Excellent Integrated System Limited

Stocking Distributor

Click to view price, real time Inventory, Delivery & Lifecycle Information:

[NKK Switches](#)
[AT517A](#)

For any questions, you can email us directly:
sales@integrated-circuit.com

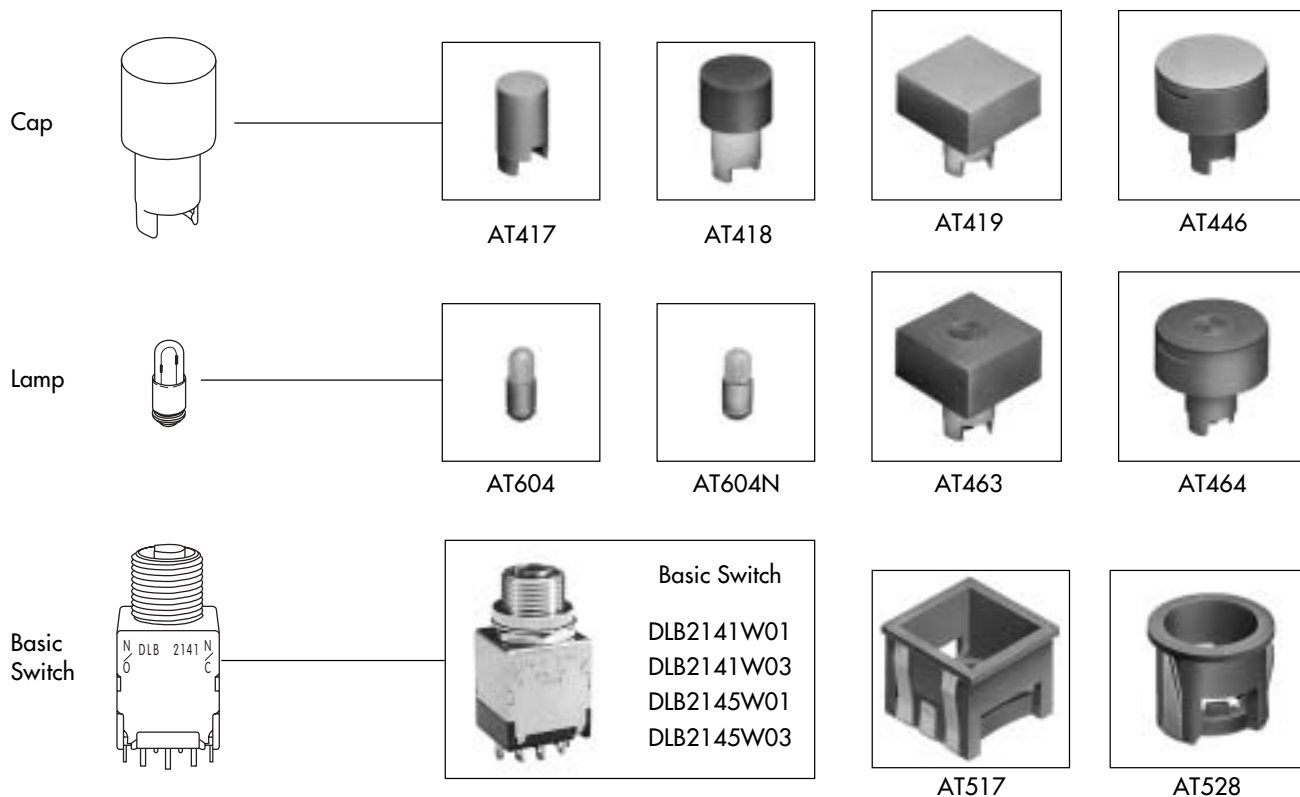

GENERAL SPECIFICATIONS

Electrical Capacity (Resistive Load)

Power Level (Silver Contacts): 5A @ 125V AC or 3A @ 250V AC or 30V DC

Other Ratings

- Contact Resistance:** 10 milliohms maximum
- Insulation Resistance:** 200 megohms minimum @ 500V DC
- Dielectric Strength:** 1,000V AC minimum between contacts; 1,500V AC minimum between contacts & case
- Mechanical Life:** 30,000 operations minimum
- Electrical Life:** 10,000 operations minimum
- Nominal Operating Force:** 1,300 grams for momentary; 1,200 grams for alternate action
- Travel:** 1.0mm (.039") pretravel; 4.0mm (.157") overtravel; 5.0mm (.196") total travel





Materials & Finishes

- Caps:** Polycarbonate
- Plunger:** Polyacetal resin
- Bushing:** Brass with chrome plating
- Housing:** Steel, chromate over zinc
- Movable Contact:** Silver
- Stationary Contacts:** Silver with silver plating
- Base:** Phenolic resin
- Common Terminals:** Copper with silver plating
- End Terminals:** Copper with silver plating
- Lamp Terminals:** Brass with nickel plating

Standards & Certifications

UL Recognized: All models recognized at 5A @ 125V AC; UL File No. E44145
 Add "/U" to end of part number to order UL mark on switch.

BASIC SWITCH

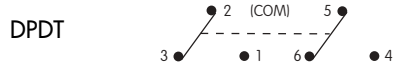
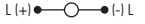
		Plunger Position () = Momentary		Connected Terminals		Terminals
Model	Pole	Normal  Keyway	Down 	Normal  Keyway	Down 	Terminal numbers are not actually on the switch.
DLB2141W01 DLB2141W03 DLB2145W01 DLB2145W03	DP	ON ON ON ON	(ON) (ON) ON ON	2-3 5-6	2-1 5-4	Solder Lug Straight PC Solder Lug Straight PC
Throw & Power/Lamp Schematics		 				Lamp circuit is isolated and requires external power source.

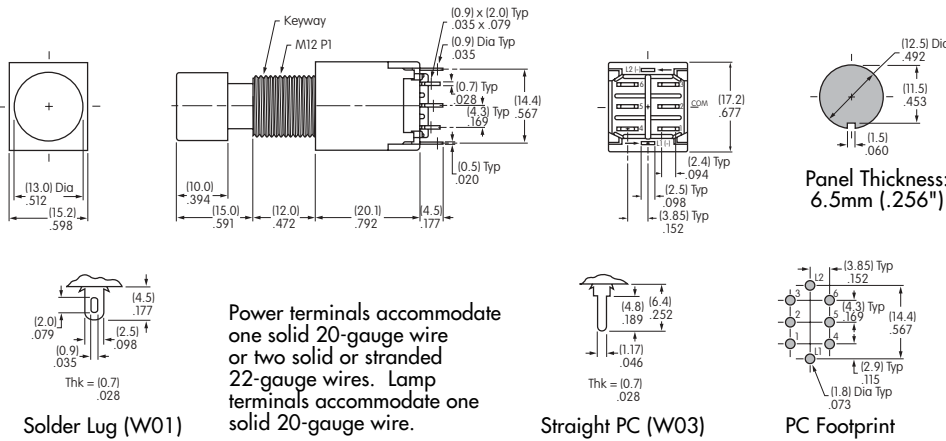

LAMPS & ELECTRICAL SPECIFICATIONS

Electrical specifications are determined at a basic temperature of 25°C. Lamp circuit is independent of switch operation. The ballast resistor calculation and more lamp detail are shown in the Supplement; see Supplement Index (page Z1).

Incandescent & Neon Lamps for Caps AT419, AT417, AT418, & AT446

Part Number	Lamp Type	Voltage	Current	Endurance	
AT604-6V	Incandescent	6V	200mA	1,000 hours	T-1 3/4 Midget Groove Base 
AT604-14V	Incandescent	14V	80mA	750 hours	
AT604-28V	Incandescent	28V	40mA	1,000 hours	
AT604N	Neon	110V	1.5mA	10,000 hours	

Use Neon with AT417 & AT418 white caps only. Recommended Resistors: 33K ohms for 110V AC; 100K ohms for 220V AC

Single Element LED in Spot Illuminated Black Opaque Cap

Part Number	LED Color & Cap Description	Forward Peak Current	Continuous Fwd Current	Forward Voltage	Reverse Peak Voltage	Current Reduction Above 25°C
AT463C	Red LED in Square Cap	35mA	25mA	1.65V	3V	0.57mA/°C
AT463F	Green LED in Square Cap	30mA	20mA	2V	3V	0.43mA/°C
AT464C	Red LED in Round Cap	35mA	25mA	1.65V	3V	0.57mA/°C
AT464F	Green LED in Round Cap	30mA	20mA	2V	3V	0.43mA/°C

AT463

Can be combined with Square Mounter AT517.

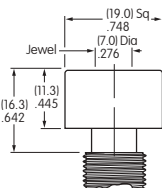





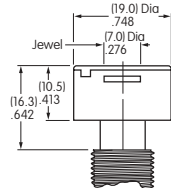

AT464

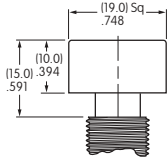
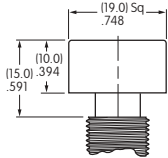
Can be combined with Round Mounter AT528.

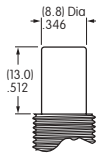
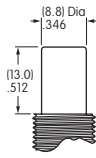

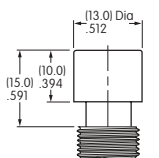
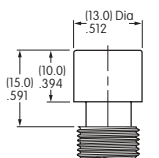
CAP TYPES & COLORS

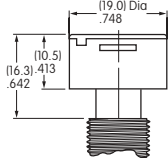
			Part Number	Cap	Color
AT419  	Can be used with Square Mounter		AT419B	.748" Square	White
			AT419C	.748" Square	Red
			AT419D	.748" Square	Orange
			AT419E	.748" Square	Yellow
			AT419F	.748" Square	Green
			AT419G	.748" Square	Blue
AT417  			AT417B	.346" Diameter	White
			AT417C	.346" Diameter	Red
			AT417D	.346" Diameter	Orange
			AT417E	.346" Diameter	Yellow
			AT417F	.346" Diameter	Green
			AT417G	.346" Diameter	Blue
AT418  			AT418B	.512" Diameter	White
			AT418C	.512" Diameter	Red
			AT418D	.512" Diameter	Orange
			AT418E	.512" Diameter	Yellow
			AT418F	.512" Diameter	Green
			AT418G	.512" Diameter	Blue
AT446  Lens Holder	Can be used with Round Mounter		AT446	.748" Diameter	
Black opaque holder; white, red, green, & blue translucent lenses are provided.					

OPTIONAL SNAP-IN MOUNTERS

AT517A

Mounter for Square Caps

Provided with assembly instructions

Material: Fiberglass reinforced nylon

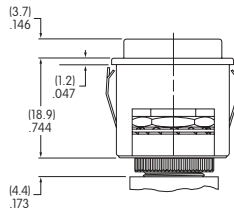

Panel Cutout



DLB2145W01 with Cap AT419 & Square Mounter

Panel Thickness: 1.0 ~ 4.0mm (.039 ~ .157")

AT528A

Mounter for .748" Round Caps

Provided with assembly hardware and instructions

Material: Fiberglass reinforced nylon

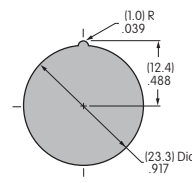
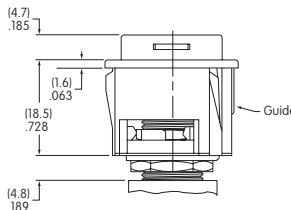

Panel Cutout



DLB2145W01 with Cap AT446 & Round Mounter

Panel Thickness: 1.0 ~ 4.0mm (.039 ~ .157")