

Excellent Integrated System Limited

Stocking Distributor

Click to view price, real time Inventory, Delivery & Lifecycle Information:

[E-Switch](#)
[TL3303F160QG](#)

For any questions, you can email us directly:

sales@integrated-circuit.com

SHEET 1 OF 1

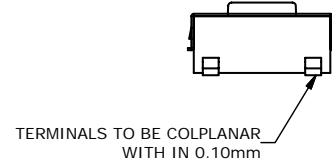
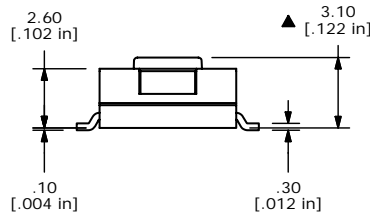
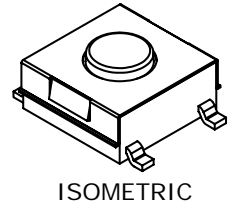
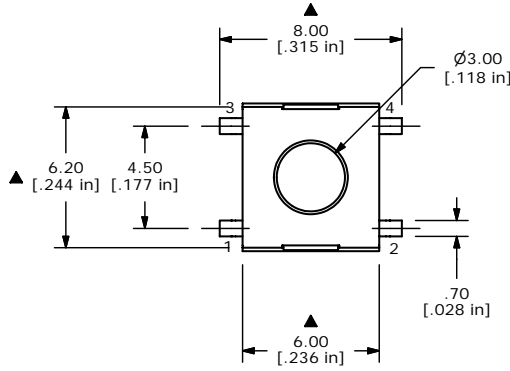
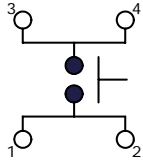
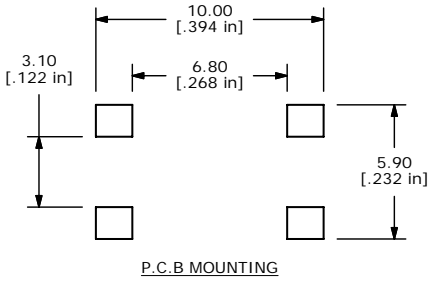

- NOTES:
1. ALL DIMENSIONS IN MM [INCH]
 2. GENERAL TOLERANCE: X.X=±0.4
X.XX=±0.25
 3. TERMINAL NUMBERS FOR REF ONLY.
 4. TRAVEL: 0.25mm +0.2/-0.1
 5. RATING: 50mA, 12VDC
 6. OPERATING FORCE: 160±50gf
 7. CONTACT RESISTANCE: 100M OHM MAX.
 - ▲ 8. ACTUATOR COLOR: IVORY
 9. ▲DENOTES CRITICAL PARAMETER
 - ▲10. PACKAGING: TAPE AND REEL 1,500 PCS PER
 - ▲11. 2002/95/EC (ROHS) COMPLIANT

C	17037	FIXED ACTUATOR COLOR	2/27/07	TN
B	15915	REVISED REDRAWN	3/29/06	PH
REV	PCR NO	DESCRIPTION	DATE	BY

THE INFORMATION CONTAINED IN THIS DOCUMENT IS PROPRIETARY TO E-SWITCH AND IS NOT TO BE COPIED OR TRANSFERRED

E-SWITCH®

TITLE TL3303F160QG				
SCALE 4:1	DATE 2/27/2007	DR TN	DWG P010428	REV C