

Excellent Integrated System Limited

Stocking Distributor

Click to view price, real time Inventory, Delivery & Lifecycle Information:

[Honeywell Sensing and Productivity Solutions](#)
[FRN91-12BB](#)

For any questions, you can email us directly:

sales@integrated-circuit.com

FO-55111-B
HONEYWELL
PART NUMBER

REV	DOCUMENT	CHANGED BY	CHECK
A	0016296	LKM 24OCT05	VA

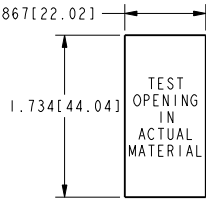
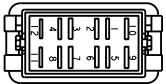
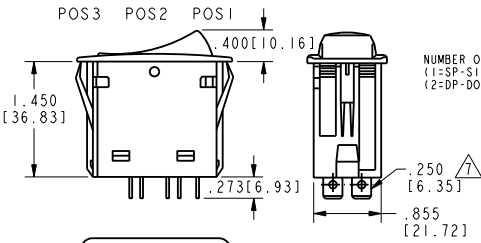
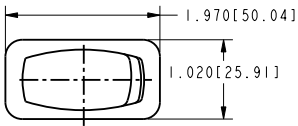

ACTUATOR COLOR (B=BLACK, G=GRAY, R=RED, W=WHITE)
CIRCUITRY (SEE TABLE)

NUMBER OF POLES
(1=SP-SINGLE POLE, USES TERMINAL 1-2-4)
(2=DP-DOUBLE POLE, USES TERMINALS 1-2-4 AND 5-6-8)

TERMINAL STYLE

CIRCUIT MADE WITH ROCKER IN			
	POSITION 3 (1&2, 5&6)	POSITION 2	POSITION 1 (2&4, 6&8)
1	ON	OFF	ON
2	OFF	NONE	ON
3	ON	NONE	ON
4	(OFF)	NONE	ON
5	(ON)	OFF	ON
6	OFF	NONE	(ON)
7	(ON)	OFF	(ON)
8	(ON)	NONE	ON

DESIGN UNITS: INCH		DRAWN	CR	13 JUN 05
TOLERANCES UNLESS NOTED:		CHECK	RJ	13 JUN 05
NO PLACE	X ± 0.040	THIS DRAWING COVERS A PROPRIETARY ITEM AND IS THE PROPERTY OF HONEYWELL. THIS DRAWING IS NOT TO BE COPIED OR USED WITHOUT THE PERMISSION OF HONEYWELL.		
ONE PLACE	.X ± 0.030	INTERPRET PER ASME Y14.5M-1994 OTHER HONEYWELL ENGINEERING STANDARDS MAY APPLY		
TWO PLACE	.XX ± 0.015			
THREE PLACE	.XXX ± 0.015			
FOUR PLACE	.XXXX ± 0.005			
ANGLES	X ±	2		

THIRD ANGLE PROJECTION



Pro/ENGINEER 2D

ELECTRICAL RATING & APPROVALS	
FOR .250 WIDE TABS: 20A, 12V	
FOR .187 WIDE TABS: 15A, 12V	

- NOTES
- OPERATING TEMPERATURE RANGE: -40°F TO +185°F (-40°C TO +86°C)
 - ELECTRICAL LIFE: 50,000 CYCLES MOMENTARY, 100,000 CYCLES MAINTAINED.
 - MECHANICAL LIFE: 250,000 CYCLES MIN SEE DIAGRAM FOR CATALOGING SCHEME PARENTHESES DENOTE MOMENTARY ACTION
 - SEALED TO IP67
 - TERMINAL WIDTH AND ELECTRICAL RATING DEPENDENT ON STYLE SELECTED

Honeywell

SWITCH, ROCKER

SIZE	TYPE	DRAWING NAME	REV
B	I	FRN SERIES CHART 1	A

SCALE NTS SHEET 1 OF 1