

REVISIONS				
SYM	ZONE	ECN, ERN NO.	DATE	APPRD.
A		PROPOSAL	2005/01/31	L.CHAN
B		UPDATE DRAWING	2015/03/12	L.CHAN
C		UPDATE DIMENSIONS	2016/02/02	L.CHAN
D		CORRECT PLATING	2016/04/27	L.CHAN

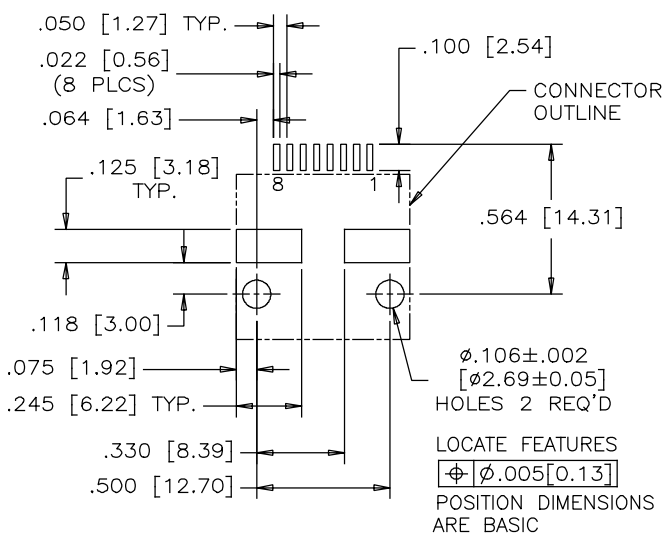

RECOMMENDED P.C.B. LAYOUT  
(COMPONENT SIDE OF BOARD)

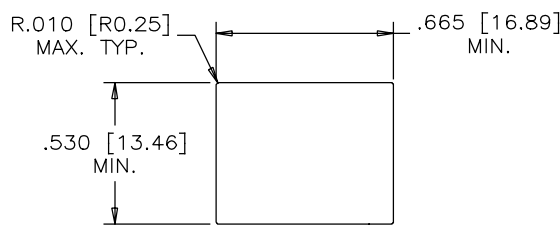

RECOMMENDED PANEL CUTOUT



**MATERIALS:**  
PLASTIC HOUSING: ENGINEERING THERMOPLASTIC  
FLAMMABILITY RATING UL 94V-0

**CONTACTS:**  
PHOSPHOR BRONZE  
PLATING: 20 μ" [0.51 MICRONS]  
MIN. GOLD ON MATING SURFACES.  
50 μ" [1.27 MICRONS]  
MIN. NICKEL UNDERPLATE  
100 μ" [2.54 MICRONS]  
MIN. MATTE TIN ON CONTACT TAILS.

**SHIELD:**  
COPPER ALLOY  
PLATING: NICKEL

PART NUMBER: RJSSE-5380

DRAWN	L.DENG	DATE	01/31/05
DESIGNED	L.DENG		
CHECKED	J.SI		
I. E. APPRD.			
Q. A. APPRD.			
DWG. APPRD.			
ENG. REL. NO.			
REF.			
DIMENSIONS ARE IN	CODE ID. NO.		
INCHES [mm]	03554		

Amphenol Canada Corp.			
TITLE SINGLE PORT, SURFACE MOUNT, RJ45 MODULAR JACK, 8 POSITION, 8 CONTACTS, WITH SHIELD, RoHS COMPLIANT			
DWG	DRAWING NO.	P-RJSSE-5380	
REV.	D		
SCALE	WT.	SURF.	SHEET 1 of 1

THIS DOCUMENT CONTAINS PROPRIETARY INFORMATION AND SUCH INFORMATION MAY NOT BE DISCLOSED TO OTHERS FOR ANY PURPOSE OR USED FOR MANUFACTURING PURPOSES WITHOUT WRITTEN PERMISSION FROM AMPHENOL CANADA CORP.