

Excellent Integrated System Limited

Stocking Distributor

Click to view price, real time Inventory, Delivery & Lifecycle Information:

[Sullins Connector Solutions](#)
[ABM06DSEF-S243](#)

For any questions, you can email us directly:
sales@integrated-circuit.com

REVISIONS				
REV.	ECO. NO	DESCRIPTION	DATE	BY
A	604	INITIAL RELEASE	05/02/2005	TT
B	898	ADDED WIDTH DIMENSION	1/12/2006	HT
C	1375	UPDATED FORMAT. ADDED ALL TABULATIONS. CORRECTED S# CALL OUT FROM S13 TO S243 IN TABULATION BLOCK	6/6/2007	MNH
D	1390	ADD CURRENT RATING TO F MATERIAL	6/18/2007	MNH
E	1656	ADDED 'P' MOUNTING	4/8/2008	MNH
F	1662	UPDATE DRAWING FORMAT & PART NUMBER CODING	4/18/2008	VJ

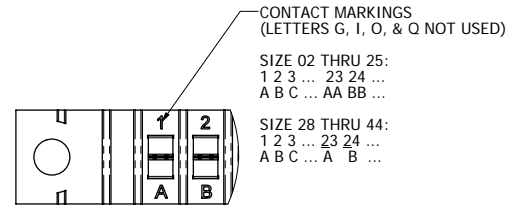
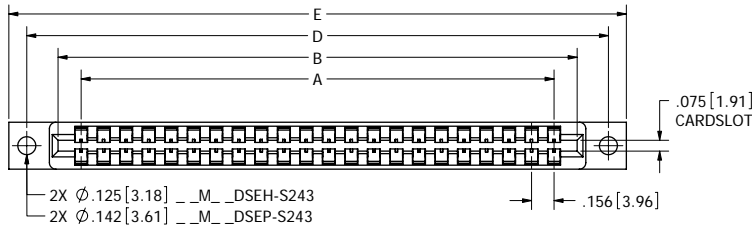

CONTACT ID SCALE 4:1

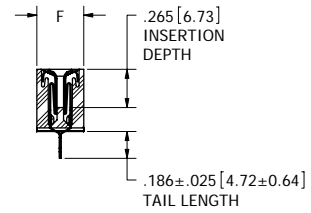

SECTION A-A

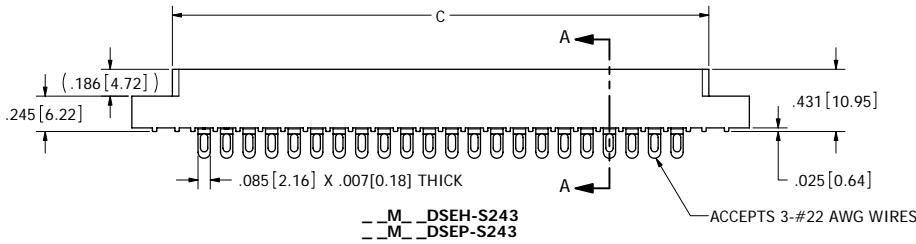

M_DSEH-S243
M_DSEP-S243

NOTES:

- INSULATOR MATERIAL: SEE PART NUMBER CODING.
- CONTACT MATERIAL: SEE PART NUMBER CODING.
- PLATING: SEE PART NUMBER CODING.
- TEMPERATURE: SEE PART NUMBER CODING.
- PROCESSING TEMP: SEE PART NUMBER CODING.
- UL FLAMMABILITY RATING: 94V-0.
- VOLTAGE RATING: 1800 VDC MINIMUM AT SEA LEVEL.
- CURRENT RATING: SEE PART NUMBER CODING.
- VOLTAGE DROP: 30 MILLI VOLT AT RATED CURRENT.
- INSULATION RESISTANCE: 5000 MEGA OHMS.
- CONNECTOR IDENTIFICATION: THE PART SHALL BE MARKED WITH A PART NUMBER AND BARCODE.
- BOARD THICKNESS ACCOMMODATED: .062 ± .008 [1.57 ± 0.20].
- BOARD INSERTION FORCE: 16 OZ MAX PER CONTACT PAIR WHEN USING A .062 [1.57] TEST BLADE.
- INTERNAL INSPECTION TO BE PER SULLIN'S WORK INSTRUCTION W17.3-01.
- BOARD WITHDRAWAL FORCE: 1 OUNCE MINIMUM PER CONTACT PAIR USING .062 [1.57] PCB.
- MODIFICATION: CRIMP BOTH ROWS TO CENTER.



RoHS COMPLIANT

CUSTOMER COPY

UNLESS OTHERWISE SPECIFIED: DIMENSIONS ARE IN INCHES[MM] TOLERANCES: ANGULAR: ± .1° XXX = ± .02 [508] XXX = ± .005 [1270] XXXX = ± .0005 [10127] PARENTHETICAL INFORMATION IS FOR REFERENCE ONLY INTERPRET DIMENSIONS AND GEOMETRIC TOLERANCING PER: ANSI Y14.5-1984	DATE	NAME	SULLINS ELECTRONICS DESCRIPTION: EDGE CARD, .156 CC, LP PART NUMBER: M_DSE-S243 SIZE: C DWG. NO.: C10454 REV: F SCALE: 2:1 SHEET 1 OF 3
	9/22/2006	HT	

8 7 6 5 4 3 2 1

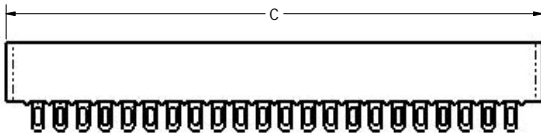

__M__DSEN-S243

2X #4-40
 THREADED
 INSERT

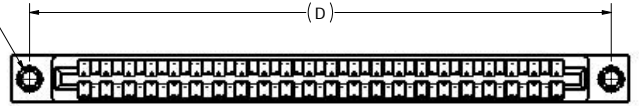

__M__DSEI-S243

2X FLOATING BOBBIN
 $\phi .116[2.95]$ CLEARANCE
 FOR # 4 SCREW

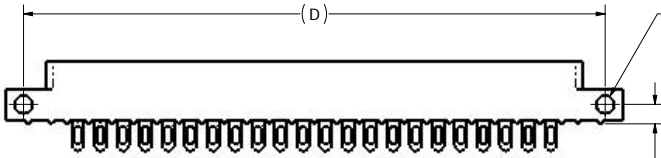
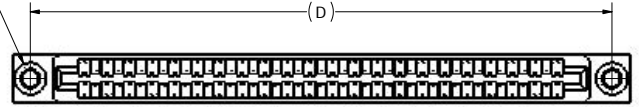

__M__DSES-S243

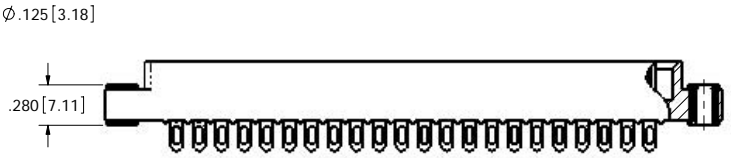

__M__DSEF-S243

CUSTOMER COPY



RoHS COMPLIANT

UNLESS OTHERWISE SPECIFIED:
 DIMENSIONS ARE IN INCHES[MM]
 TOLERANCES:
 ANGULAR: $\pm 1^\circ$
 XXX = $\pm .02$ [.508]
 XXXX = $\pm .005$ [.1270]
 XXXX = $\pm .005$ [.0127]
 PARENTHETICAL INFORMATION IS FOR
 REFERENCE ONLY
 INTERPRET DIMENSIONS AND GEOMETRIC
 TOLERANCING
 PER: ANSI Y14.5-1984

DATE	NAME
9/22/2006	HT
DRAWN BY	
THE INFORMATION HEREIN CONTAINS PROPRIETARY INFORMATION OF SULLINS ELECTRONICS AND IS NOT TO BE REPRODUCED USED OR DISCLOSED TO OTHERS FOR ANY PURPOSE EXCEPT AS SPECIFICALLY AUTHORIZED IN WRITING BY AN OFFICER OF SULLINS ELECTRONICS.	

SULLINS ELECTRONICS	
EDGE CARD, .156 CC, LP	
PART NUMBER	
__M__DSE__S243	
SIZE	DWG. NO.
C	C10454
SCALE: 2:1	REV
	F
	SHEET 2 OF 3

Only applies for PPS/PEEK insulators with threaded inserts or floats

PART NUMBER	NO. OF POS.	A ± .008[0.20]		B ± .008[0.20]		C ± .015[0.38]		D ± .010[0.25]		E ± .020[0.51]		E ± .020[0.51]		F ± .005[0.13]					
		IN	MM	IN	MM	IN	MM	IN	MM	IN	MM	IN	MM	IN	MM				
M02DSEN-S243	2	0.156	3.96	0.476	12.09	0.596	15.14	"N" MOUNTING								0.325	8.26		
M03DSEN-S243	3	0.312	7.92	0.632	16.05	0.752	19.10												
M06DSE-S243	6	0.780	19.81	1.100	27.94	1.220	30.99	1.533	38.94	1.782	45.26	1.882	47.80	0.438	11.13				
M08DSE-S243	8	1.092	27.74	1.412	35.86	1.532	38.91	1.845	46.86	2.094	53.19	2.194	55.73						
M10DSE-S243	10	1.404	35.66	1.724	43.79	1.844	46.84	2.157	54.79	2.406	61.11	2.506	63.65					0.500	12.70
M11DSE-S243	11	1.560	39.62	1.880	47.75	2.000	50.80	2.313	58.75	2.562	65.07	2.662	67.61						
M12DSE-S243	12	1.716	43.59	2.036	51.71	2.156	54.76	2.469	62.71	2.718	69.04	2.818	71.58						
M15DSE-S243	15	2.184	55.47	2.504	63.60	2.624	66.65	2.937	74.60	3.186	80.92	3.286	83.46						
M18DSE-S243	18	2.652	67.36	2.972	75.49	3.092	78.54	3.405	86.49	3.654	92.81	3.754	95.35						
M22DSE-S243	22	3.276	83.21	3.596	91.34	3.716	94.39	4.029	102.34	4.278	108.66	4.378	111.20						
M24DSE-S243	24	3.588	91.14	3.908	99.26	4.028	102.31	4.341	110.26	4.590	116.59	4.690	119.13						
M25DSE-S243	25	3.744	95.10	4.064	103.23	4.184	106.27	4.497	114.22	4.746	120.55	4.846	123.09						
M28DSE-S243	28	4.212	106.98	4.532	115.11	4.652	118.16	4.965	126.11	5.214	132.44	5.314	134.98						
M36DSE-S243	36	5.460	138.68	5.780	146.81	5.900	149.86	6.213	157.81	6.462	164.13	6.562	166.67						
M43DSE-S243	43	6.552	166.42	6.872	174.55	6.992	177.60	7.305	185.55	7.554	191.87	7.654	194.41						
M44DSE-S243	44	6.708	170.38	7.028	178.51	7.148	181.56	7.461	189.51	7.710	195.83	7.810	198.37						

PART NUMBER CODING
 -- M -- DSE -- S243

MATERIAL (INSULATOR/CONTACT)

E = PBT/PHOSPHOR BRONZE
 OPERATING TEMP: -65°C TO +125°C @ 3 AMPS PER CONTACT
 OPERATING TEMP: -65°C TO +21°C @ 5 AMPS PER CONTACT
 PROCESSING TEMP: 260°C FOR 10 SECS MAX

R = PPS/PHOSPHOR BRONZE
 OPERATING TEMP: -65°C TO +125°C
 PROCESSING TEMP: 260°C FOR 120 SECS MAX
 CURRENT RATING PER CONTACT: 5 AMPS

G = PA9T/PHOSPHOR BRONZE
 OPERATING TEMP: -65°C TO +125°C
 PROCESSING TEMP: 260°C FOR 120 SECS MAX
 CURRENT RATING PER CONTACT: 5 AMPS

H = PBT/BERYLLIUM COPPER
 OPERATING TEMP: -65°C TO +125°C @ 3 AMPS PER CONTACT
 OPERATING TEMP: -65°C TO +105°C @ 5 AMPS PER CONTACT
 PROCESSING TEMP: 260°C FOR 10 SECS MAX

A = PPS/BERYLLIUM COPPER
 OPERATING TEMP: -65°C TO +150°C
 PROCESSING TEMP: 260°C FOR 120 SECS MAX
 CURRENT RATING PER CONTACT: 5 AMPS

J = PA9T/BERYLLIUM COPPER
 OPERATING TEMP: -65°C TO +150°C
 PROCESSING TEMP: 260°C FOR 120 SECS MAX
 CURRENT RATING PER CONTACT: 5 AMPS

F = PPS/SPINDAL (CONSULT FACTORY)
 AVAILABLE IN OVERALL GOLD ONLY (S OR M PLATING CODE)
 OPERATING TEMP: -65°C TO +200°C
 PROCESSING TEMP: 260°C FOR 120 SECS MAX
 CURRENT RATING PER CONTACT: 3 AMPS

C = PPS/BERYLLIUM COPPER (CONSULT FACTORY)
 AVAILABLE IN OVERALL GOLD ONLY (S OR M PLATING CODE)
 OPERATING TEMP: -65°C TO +200°C @ 2 AMPS PER CONTACT
 OPERATING TEMP: -65°C TO +173°C @ 3 AMPS PER CONTACT
 PROCESSING TEMP: 260°C FOR 120 SECS MAX

W = PEEK/BERYLLIUM COPPER (CONSULT FACTORY)
 AVAILABLE IN OVERALL GOLD ONLY (S OR M PLATING CODE)
 OPERATING TEMP: -65°C TO +250°C
 CURRENT RATING PER CONTACT: 3 AMPS
 (CONSULT FACTORY FOR OTHER MATERIALS)

MOUNTING STYLE

H = .125" DIA. CLEARANCE HOLES (PAGE 1)
 P = .142" DIA. CLEARANCE HOLES (PAGE 1)
 N = NO MOUNTING EARS (PAGE 2)
 S = .125" DIA. SIDE MOUNTING (PAGE 2)
 I = #4-40 THREADED INSERT (PAGE 2)
 F = FLOATING BOBBIN (PAGE 2)

NUMBER OF POSITIONS (CONTACTS PER ROW)

PLATING

ALL PLATINGS ARE LEAD FREE AND HAVE .000050" NICKEL UNDERPLATE

CONTACT SURFACE TERMINATION
 G = .000010" GOLD .000005" GOLD
 Y = .000030" GOLD .000005" GOLD
 B = .000010" GOLD .000100" PURE TIN, MATTE
 C = .000030" GOLD .000100" PURE TIN, MATTE
 **E = .000100" PURE TIN, MATTE, OVERALL
 S = .000010" GOLD OVERALL
 M = .000030" GOLD .000010" GOLD OVERALL
 ** OVERALL TIN ONLY AVAILABLE ON MATERIAL CODES E, R AND G

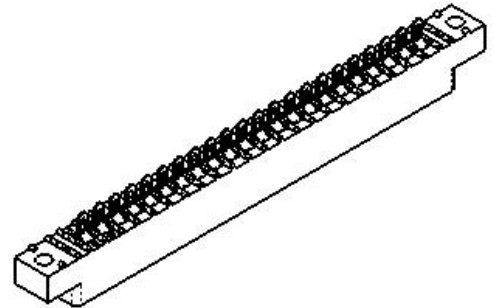

CUSTOMER COPY



RoHS COMPLIANT

UNLESS OTHERWISE SPECIFIED:
 DIMENSIONS ARE IN INCHES[MM]
 TOLERANCES:
 ANGULAR: ± .1°
 XXX = ± .02 [1.58]
 XXXX = ± .005 [127]
 PARENTHETICAL INFORMATION IS FOR REFERENCE ONLY
 INTERPRET DIMENSIONS AND GEOMETRIC TOLERANCING PER: ANSI Y14.5-1984

DATE	NAME	BULLINS ELECTRONICS	
8/22/2006	HT	EDGE CARD, .156 CC, LP	
THE INFORMATION HEREIN CONTAINS PROPRIETARY INFORMATION OF BULLINS ELECTRONICS AND IS NOT TO BE REPRODUCED, USED OR DISCLOSED TO OTHERS WITHOUT THE WRITTEN PERMISSION OF BULLINS ELECTRONICS.		PART NUMBER	
M_DSE-S243		SIZE	REV
C		C10454	F
SCALE: 2:1		SHEET 3 OF 3	