

Excellent Integrated System Limited

Stocking Distributor

Click to view price, real time Inventory, Delivery & Lifecycle Information:

[Molex Connector Corporation](#)
[73251-0031](#)

For any questions, you can email us directly:
sales@integrated-circuit.com

MATERIALS AND FINISHES:

BODY: STAINLESS STEEL
PLATED GOLD (SEE TABLE)

COUPLING NUT: STAINLESS STEEL
PASSIVATED -0031 -0032 -0033
PLATED GOLD (8 u" MIN) -0034

CENTER CONTACT: BRASS
PLATED GOLD (SEE TABLE)

INSULATOR: TEFLON

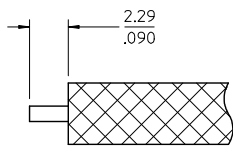
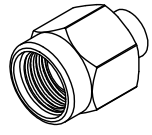
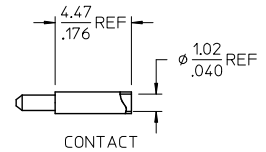
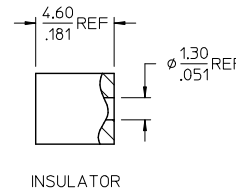
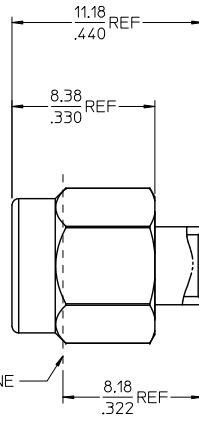
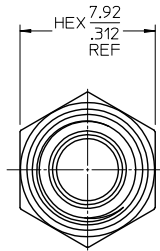

RG402 CABLE STRIP

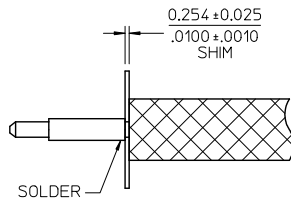

SOLDER

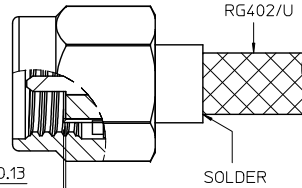

SOLDER

USING CONTACT LOCATOR TOOL 89676-3600, SLIP CONTACT/CABLE INTO SMA ASSEMBLY UNTIL BOTTOMS. SOLDER CABLE TO SMA ASSEMBLY.

USING INSULATOR INSERTION TOOL 89676-3100 PRESS INSULATOR TO DIMENSION SHOWN.

PS-89675-346	ELECTRO/MECH PERFORM.
MIL-STD-348A, FIG. 310.1	INTERFACE
SPECIFICATION	DESCRIPTION

73251-0034	BY TRAY	8 MICROINCHES	8 MICROINCHES
73251-0033	BY BAG	30 MICROINCHES	30 MICROINCHES
73251-0032	BY TRAY (20 CAV)	10 MICROINCHES	30 MICROINCHES
73251-0031	BY BAG	10 MICROINCHES	30 MICROINCHES
PART NO.	PACKAGING	FINISH BODY	FINISH CONTACT

CHG: UPDATED VIEWS PER REF 15-E096 EC NO: URF2015-0343 2015/01/06 DRW: RREH CHKD: APPR: YCHENG B REV	QUALITY SYMBOLS ∇=0 ∇=0 ∇=0	GENERAL TOLERANCES (UNLESS SPECIFIED) mm INCH 4 PLACES ± --- ± --- 3 PLACES ± --- ± --- 2 PLACES ± --- ± --- 1 PLACE ± --- ± --- 0 PLACE ± --- ± ---	DIMENSION STYLE MM/IN DRAWN BY NBJ DATE 1997/12/01 CHECKED BY DHG DATE 1998/01/05 APPROVED BY GMH DATE 1998/01/06	SCALE 6:1 DESIGN UNITS METRIC THIRD ANGLE PROJECTION	TITLE SMA PLUG, SOLDER TYPE FOR RG402 CABLE, 50 OHMS SMA-PC, EWR-1980 molex	MATERIAL NO. SEE TABLE	DOCUMENT NO. SD-73251-003	SHEET NO. 1 OF 1	
		ANGULAR ± 1 ° DRAFT WHERE APPLICABLE MUST REMAIN WITHIN DIMENSIONS							
		THIS DRAWING CONTAINS INFORMATION THAT IS PROPRIETARY TO MOLEX INCORPORATED AND SHOULD NOT BE USED WITHOUT WRITTEN PERMISSION							
		SIZE C							