

## Excellent Integrated System Limited

Stocking Distributor

Click to view price, real time Inventory, Delivery & Lifecycle Information:

[FCI](#)

[51730-031LF](#)

For any questions, you can email us directly:

[sales@integrated-circuit.com](mailto:sales@integrated-circuit.com)

Tous droits strictement réservés. Reproduction ou communication à des fins inférieures sans aucune forme que ce soit sans autorisation écrite du propriétaire. Propriété de FCI. Droits de reproduction FCI.

All rights strictly reserved. Reproduction or issue in any form whatever is not permitted without written authority from the proprietor. Property of FCI. Copyright FCI.

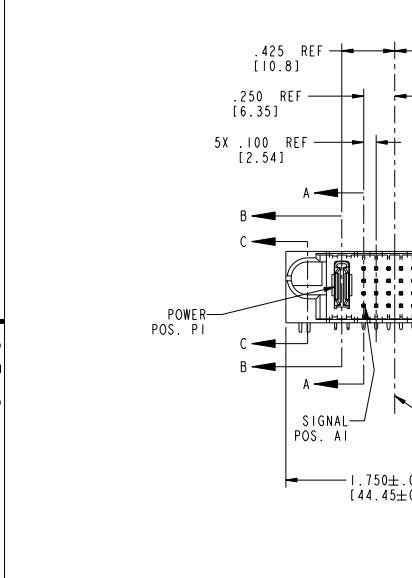
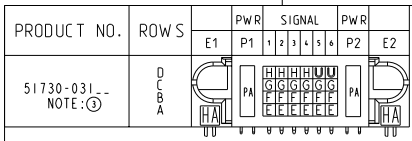

CODE	DIM "M"	MATING LENGTH	CONTACT TYPE
E	.220	[5.59]	SIGNAL
F	.220	[5.59]	SIGNAL
G	.220	[5.59]	SIGNAL
H	.220	[5.59]	SIGNAL
U	.270	[6.86]	SIGNAL
PA	N/A	[N/A]	POWER
HA	N/A	[N/A]	HOLD-DOWN

ltr	ecm no.	dr	date	linear	tolerances unless otherwise specified
A	V12149	JRW	08/09/01		$.XX \pm .01/0.XX \pm 0.3$
B	V21291	CGD	09/10/02		$.XXX \pm .005/0.XX \pm 0.13$
C	DG05-0319	CS	09/08/05	angles	$.XXX \pm .0020/0.XX \pm 0.051$
D	DG05-0360	CS	12/26/05	dr	$0^\circ \pm 7^\circ$
				engr	C. DAILY 09/10/02
				chr	M. MOSTOLLER 09/10/02
				oppd	M. MOSTOLLER 09/10/02

sheet index	revision sheet	D	D	D	D
		1	2	3	4

CUSTOMER		FCI	
www.fciconnect.com		www.fciconnect.com	
COPY		projection	
title		IP + 24S + IP	
product family		RIGHT ANGLE SOLDER HEADER	
size		PwrBlade	
dwg no		51730-031	
code		213	
sheet		1 of 4	

code	code
22526	4

PDM: Rev:D STATUS:Released Printed: Oct 08, 2006

Tous droits strictement réservés. Reproduction ou communication à des fins inférieures sans autorisation écrite du propriétaire. Propriété de FCI. Droits de reproduction FCI.

All rights strictly reserved. Reproduction or issue in any form without written authority from the proprietor. Property of FCI. Copyright FCI.

PRODUCT NUMBER  
51730-031  
NOTE: ③

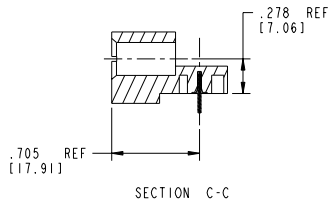
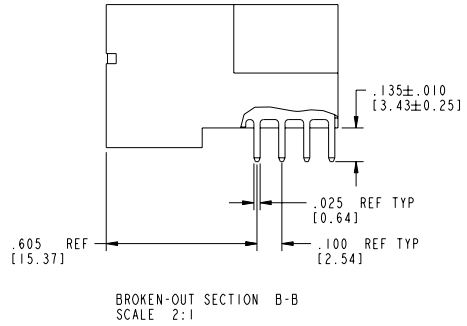
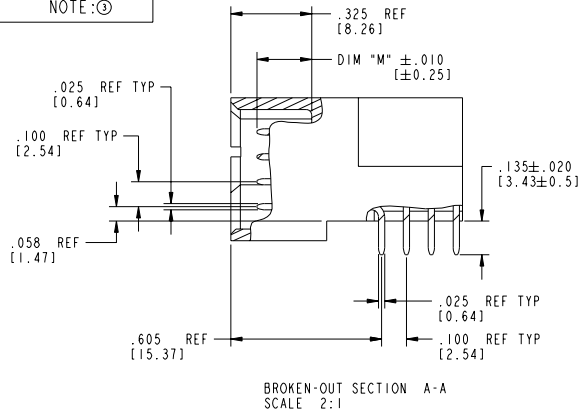

mat'l code		SEE NOTE 2	tolerances unless otherwise specified	CUSTOMER	FCI		www.fciconnect.com
ltr	ecm no.	dr	date	linear	XX±.01/0.XX±0.3	COPY	title
D				angles	XXX±.005/0.XX±0.13	projection	IP + 24S + IP
				dr	XXX±.0020/0.XX±0.051	INCH/MM	RIGHT ANGLE SOLDER HEADER
				engr	0° ± 7°	scale	product family
				chr	C. DAILY 09/10/02	1:1	PwrBlade
				appd	M. MOSTOLLER 09/10/02	A	size
					W. MOSTOLLER 09/10/02		dwg no
					M. MOSTOLLER 09/10/02		51730-031
sheet index	revision sheet						code
							213
							sheet 2 of 4

Pro/E

PDM: Rev:D

STATUS Released

Printed: Oct 08, 2006



Tous droits strictement réservés. Reproduction ou communication de ces lignes interdite sans autorisation écrite du propriétaire. Propriété de FCI. Droits de reproduction FCI.

All rights strictly reserved. Reproduction or issue in third parties in any form whatever is not permitted without written authority from the proprietor. Property of FCI. Copyright FCI.

PRODUCT NUMBER  
 51730-031 -  
 NOTE: ③

NOTES:

1. DIMENSIONS AND TOLERANCES ARE IN ACCORDANCE WITH ASME Y14.5M, 1994 UNLESS OTHERWISE SPECIFIED.

CONNECTOR NOTES:

- ② HOUSING MATERIAL: UL 94 V-0 GLASS FILLED HIGH-TEMP THERMOPLASTIC  
 POWER CONTACT MATERIAL: COPPER ALLOY  
 SIGNAL PIN MATERIAL: COPPER ALLOY
- 3. PLATING:  
 51730-031, 51730-031LF, PLATING SPEC SEE PRINT: 100064183.
- ④ MANUFACTURER'S NAME, P/N, AND DATE CODE TO APPEAR ON THIS SURFACE.
- 5. PRODUCT SPECIFICATION GS-12-149.  
 APPLICATION SPECIFICATION BUS-20-067.

PCB NOTES:

- 6. ALL HOLE DIAMETERS ARE FINISHED HOLE SIZE.
- 7. MOUNTING HOLES, WHERE APPLICABLE, ARE UNPLATED.
- ⑧  $\varnothing .0453 \pm .0010$  [1.151 ± 0.025] DRILLED HOLES PLATED WITH .0003 [0.008] MIN SnPb OVER .001 [0.03] TO .003 [0.08] Cu PLATING TO ACHIEVE  $\varnothing .040 \pm .003$  [1.02 ± .07] HOLE.
- ⑨ "DIM XXX" TO BE DETERMINED BY THE CUSTOMER.
- ⑩ CONNECTOR KEEP-OUT ZONE.

mat'l code		SEE NOTE 2		tolerances unless otherwise specified		CUSTOMER		FCI	
ltr	ecm no.	dr	date	linear	projection	COPY		www.fciconnect.com	
D				$.XX \pm .01/0$ $.XX \pm 0.3$	$.XXX \pm .005/0$ $.XX \pm 0.13$	title		IP + 24S + IP	
				angles	$.XXX \pm .0020/0$ $.XX \pm 0.051$	RIGHT ANGLE SOLDER HEADER		code	
				dr	$0^\circ \pm 7^\circ$	product family		PwrBlade	
				engr	C. DAILY 09/10/02	size		dwg no	
				chr	M. MOSTOLLER 09/10/02	scale		A	
				appd	M. MOSTOLLER 09/10/02	51730-031		213	
sheet index	revision sheet					code code		22526	
						4		4 of 4	