

Excellent Integrated System Limited

Stocking Distributor

Click to view price, real time Inventory, Delivery & Lifecycle Information:

[FCI](#)
[86303425060LF](#)

For any questions, you can email us directly:
sales@integrated-circuit.com

Copyright FCI.

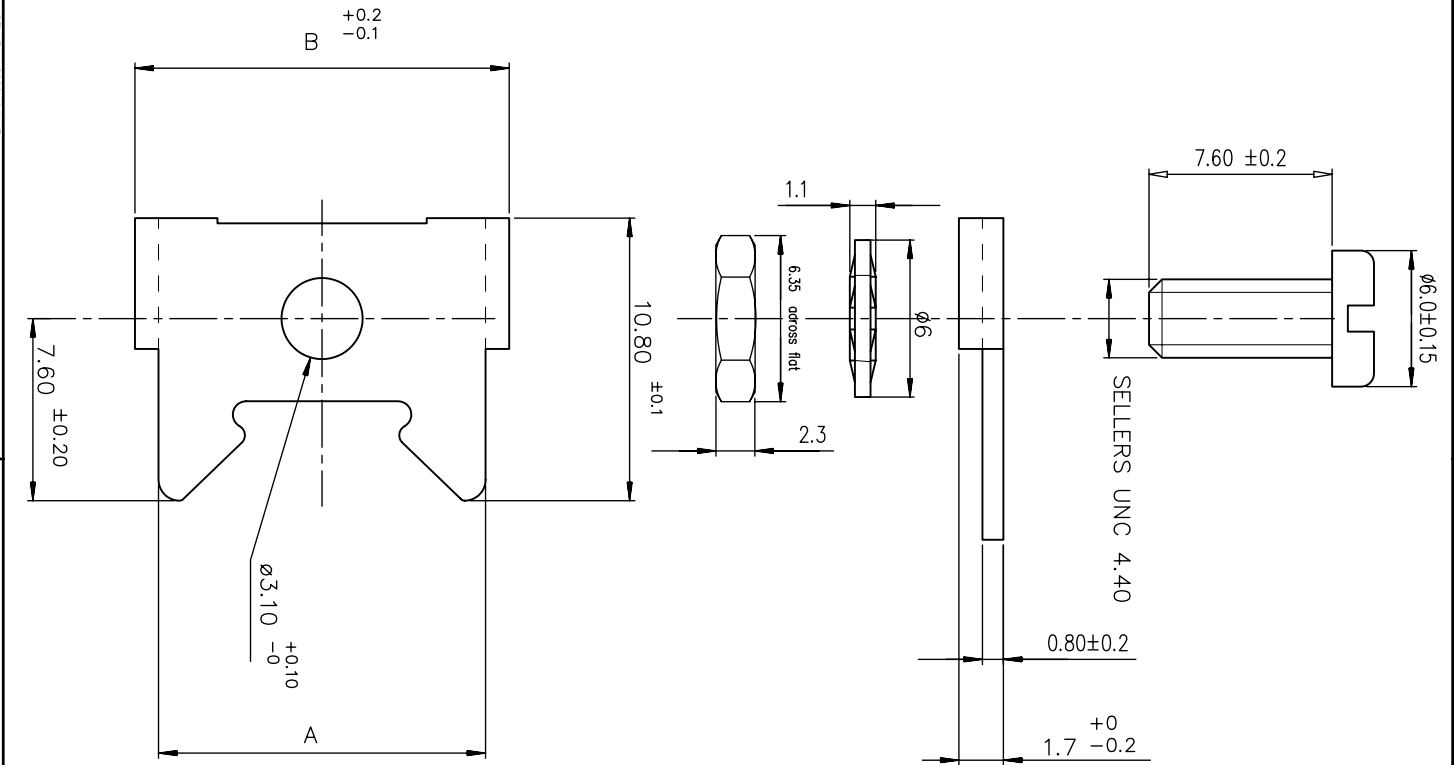

rev	ben no	dr	date
A	LS05-0123	LGO	2006/01/12
B	LS06-0095	LGO	2006/06/24
C	110-0056	AMR	2010/02/22
D	111-0022	AMR	2011/01/25
E	111-0070	AMR	2011/04/18
F	EX-H-01833	PK	2012/05/22

www.fciconnect.com		surface ISO 1302		tolerance std ISO 406 ISO 1101		projection		mm	
Dr	GOISNARD	2006/01/12	ANGULAR	0.X	±0.1	size	A3	Scale	5
Eng	PESSON	2006/01/12	LINEAR	0.XX	±0.1	ECN	ELX-H-0116933	European View	
Chr	ABHILASH	2011/01/25	0.XX ±.2	0.XXX	±0.1	Product family	D-SUB	Spec ref -	
Appr	SUDHIR	2011/01/25							
LEVER LOCKS FEMELLE		Product family		D-SUB		Spec ref -			
(SHELL SIZE 09 15 25 37 50)		Product family		D-SUB		Spec ref -			
LEVER LOCKS FEMELLE		Product family		D-SUB		Spec ref -			
(SHELL SIZE 09 15 25 37 50)		Product family		D-SUB		Spec ref -			
LEVER LOCKS FEMELLE		Product family		D-SUB		Spec ref -			
(SHELL SIZE 09 15 25 37 50)		Product family		D-SUB		Spec ref -			
LEVER LOCKS FEMELLE		Product family		D-SUB		Spec ref -			
(SHELL SIZE 09 15 25 37 50)		Product family		D-SUB		Spec ref -			

NOTE1:RoHS INFORMATIONS

- The "LF" product meets European union Directives and other country regulations as described in GS-22-008.
- The product is not intended to be exposed to a manufacturing solder process.
- Plating: Zinc Cr3+, white color.
- Packaging spec: see GS-14-920.

PART NUMBER	PACKAGING	A	B
86303425060LF	per 100 pieces	12.50	14.30
86303426060LF	per 100 pieces	15.40	17.10

REV F - 2006-04-17

2

3

4

CUSTOMER sheet 1 of 1