

## **Excellent Integrated System Limited**

Stocking Distributor

Click to view price, real time Inventory, Delivery & Lifecycle Information:

[FCI](#)  
[67020-001](#)

For any questions, you can email us directly:

[sales@integrated-circuit.com](mailto:sales@integrated-circuit.com)

PRODUCT NUMBER  
67020-001LF

WHEN REQUIRED, ADD SUFFIX LETTER "LF"  
INDICATES THE PRODUCT IS RoHS  
COMPATIBLE, SEE NOTE 2

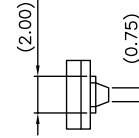
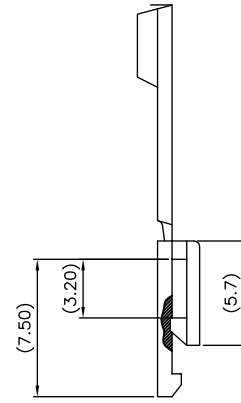
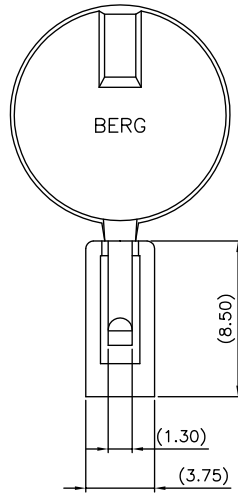

NOTES :

1. MATERIAL : 30% GLASS FIBER POLYESTER  
FLAME RETARDANT PER UL 94-V0  
COLOUR : GREY (RAL 7038)
2. RoHS COMPATIBLE PRODUCT
  - a - LABELLING:  
- MEETS PACKAGING SPECS AS PER GS-14-920
  - b - LEGAL STATEMENT : SEE GS-22-008
  - c - THE PRODUCT IS NOT INTENDED TO BE EXPOSED  
TO MANUFACTURING SOLDER PROCESS
  - d - PRODUCT MEETS WITH EU 2002/EG/95

mat'l. code		SEE NOTE 1		surface	ISO 1302	tolerance	ISO 406	ISO 1001	projection	product family
ltr	ecn	no	dr	date	tolerances	unless	otherwise	specified		title
A	7310	LNA	86.12.18	angle	.X	±0.30		mm		
B	F05-0257	LMU	05.10.11	linear	.XX	±0.15				dwg no
C	F06-0270	LMU	06.09.12	dr	.XXX	±0.05	scale 5:1	sheet 1 of 2		
				engr	J.COMPAGNON	05.10.07				67020
				chr						A3
				app	J.M.C	05.10.07				type
										CUSTOMER Drawing

sheet index	revision sheet	C	C												
		1	2												

PDS: Rev :A

STATUS:Released

Printed: Mar 21, 2013

PRODUCT NUMBER  
67020-002LF

WHEN REQUIRED, ADD SUFFIX LETTER "LF"  
INDICATES THE PRODUCT IS RoHS  
COMPATIBLE, SEE NOTE 2

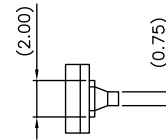
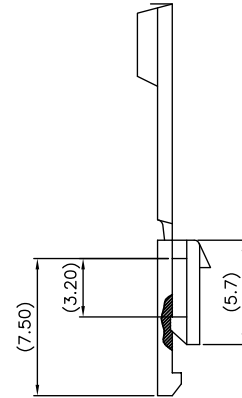
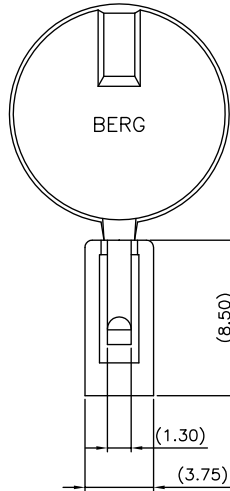

NOTES :

1. MATERIAL : 30% GLASS FIBER POLYESTER  
FLAME RETARDANT PER UL 94-V0  
COLOUR : GREY (RAL 7038)
2. RoHS COMPATIBLE PRODUCT
  - a - LABELLING:  
- MEETS PACKAGING SPECS AS PER GS-14-920
  - b - LEGAL STATEMENT : SEE GS-22-008
  - c - THE PRODUCT IS NOT INTENDED TO BE EXPOSED  
TO MANUFACTURING SOLDER PROCESS
  - d - PRODUCT MEETS WITH EU 2002/EG/95

mat'l. code		surface		tolerance		projection		product family	
SEE NOTE 1		ISO 1302 <input checked="" type="checkbox"/> ISO 446 ISO 1801							
		tolerances unless otherwise specified				mm		title	
A	7310	LNA	86.12.18	angled	.X	±0.30	POLARIZING KEY		
B	F05-0257	LMU	05.10.11	linear	.XX	±0.15	dwg no		
C	F06-0270	LMU	06.09.12		.XXX	±0.05	67020		sheet 2 of
				dr	L.MULIN	05.10.07	FCI		A3
				engr	J.COMPAGNON	05.10.07	type		CUSTOMER Drawing
				chr					
				app	J.M.C	05.10.07			
sheet index	revision sheet								