



**Distributor of FCI: Excellent Integrated System Limited**

Datasheet of DB17W2PA00LF - D-Sub Connector Plug, Male Pins 17 (15 + 2 Power) Position  
Free Hanging (In-Line) Solder Cup

Contact us: [sales@integrated-circuit.com](mailto:sales@integrated-circuit.com) Website: [www.integrated-circuit.com](http://www.integrated-circuit.com)

---

## **Excellent Integrated System Limited**

Stocking Distributor

Click to view price, real time Inventory, Delivery & Lifecycle Information:

[FCI](#)

[DB17W2PA00LF](#)

For any questions, you can email us directly:

[sales@integrated-circuit.com](mailto:sales@integrated-circuit.com)

Contact us: [sales@integrated-circuit.com](mailto:sales@integrated-circuit.com) Website: [www.integrated-circuit.com](http://www.integrated-circuit.com)

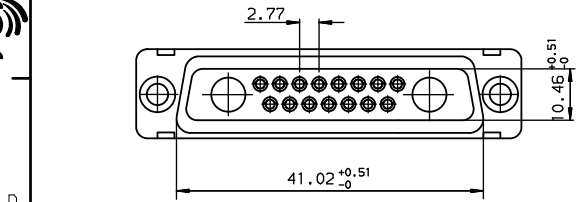
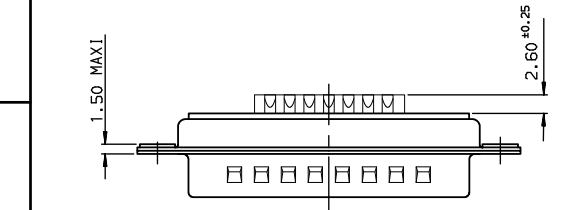
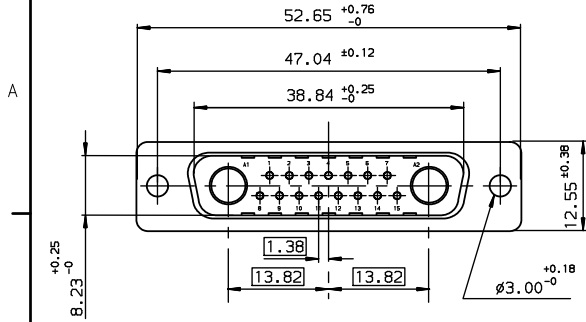

TIN LEAD PART NUMBER

DB17W2PA00  
PART NUMBER

LEAD FREE PART NUMBER

DB17W2PA00LF  
PART NUMBER

GENERAL CHARACTERISTICS AND ROHS INFORMATIONS:  
SEE DRAWING C01-8639-0003

European Views

www.fciconnect.com		surface ISO 1302	tolerance std ISO 406 ISO 1101	projection mm
		TOLERANCES UNLESS OTHERWISE SPECIFIED		
Dr JARRY	1996/07/02	ANGULAR	0.x ±0.1	size A3
Eng PESSON	1996/07/02	LINEAR	0.xx ±0.1	Scale 2
Chr LEGARE	1996/07/02	0.x ±2	0.xxx ±0.1	ECN LS06-0095
Appr LEGARE	1996/07/02	Product Family D-SUB Spec ref -		
FCI		PIN CONNECTOR FOR POWERS		Rev. D
title		CONTACTS		Aug 2001 C01-8639-0483
catalog no		-		CUSTOMER sheet 1 of 1

rev	ecn no	dr	date
B	-	BAR	2003/10/20
C	LS05-005	MPE	2005/03/16
D	LS06-0095	LGO	2006/07/19
-	-	-	-
-	-	-	-
-	-	-	-
-	-	-	-

REV F - 2006-04-17

Copyright FCI.  
**FCI**