



Distributor of FCI: Excellent Integrated System Limited

Datasheet of DAL7W2S500G40LF - D-Sub Connector Receptacle, Female Sockets 7 (5 + 2 Power) Position Through Hole, Right Angle Solder

Contact us: sales@integrated-circuit.com Website: www.integrated-circuit.com

Excellent Integrated System Limited

Stocking Distributor

Click to view price, real time Inventory, Delivery & Lifecycle Information:

[FCI](#)

[DAL7W2S500G40LF](#)

For any questions, you can email us directly:

sales@integrated-circuit.com

Contact us: sales@integrated-circuit.com Website: www.integrated-circuit.com

A

B

C

D

A

B

C

D

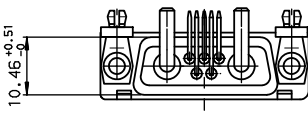
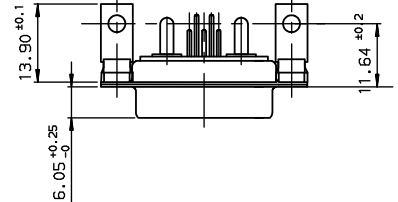
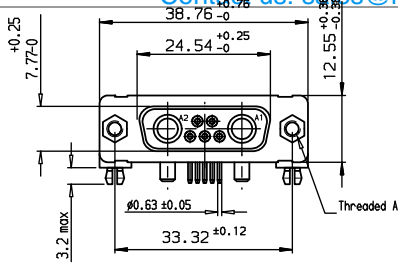

LAYOUT DIMENSIONS (after plating)
CONNECTOR SIDE VIEW

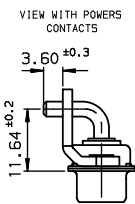
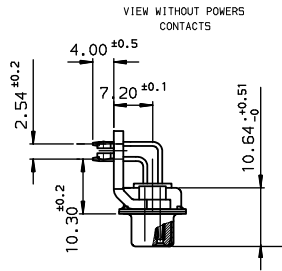
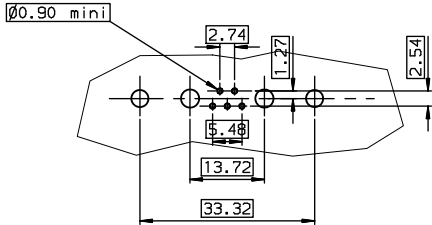

TIN LEAD PART NUMBER

DA07W2S500G30	UNC 4.40
DA07W2S500G40	UNC 4.40
DAL7W2S500G30	M3
DAL7W2S500G40	M3
PART NUMBER	Threaded A

LEAD FREE PART NUMBER

DA07W2S500G30LF	UNC 4.40
DA07W2S500G40LF	UNC 4.40
DAL7W2S500G30LF	M3
DAL7W2S500G40LF	M3
PART NUMBER	Threaded A

GENERAL CHARACTERISTICS AND ROHS INFORMATIONS:
SEE DRAWING C01-8639-0000

www.fciconnect.com		surface ISO 1302	tolerance std ISO 406 ISO 1101	projection mm
Dr JARRY 1996/03/26		TOLERANCES UNLESS OTHERWISE SPECIFIED		size A3
Eng PESSON 1996/03/26	Chr LEGARE 1996/03/26	ANGULAR	LINEAR	Scale 1.5
Appr LEGARE 1996/03/26	Product Family D-SUB	0.x ±0.1	0.xx ±0.1	ECN LS06-0095
FCI		SOCKET CONNECTOR RIGHT ANGLED WITH POWERS CONTACTS		Rev. D
catalog no		C01-8639-0609		sheet 1 of 1

rev	ecr no	dr	date
B	-	BAR	2003/11/03
C	LS05-001	MPE	2005/03/07
D	LS06-0095	LGO	2006/07/19
-	-	-	-
-	-	-	-
-	-	-	-

REV F - 2006-04-17

PDM: Rev:D

STATUS:Released

Printed: Sep 13, 2006

Copyright FCI.