

## Excellent Integrated System Limited

Stocking Distributor

Click to view price, real time Inventory, Delivery & Lifecycle Information:

[FCI](#)  
[67900-001](#)

For any questions, you can email us directly:

[sales@integrated-circuit.com](mailto:sales@integrated-circuit.com)

PRODUCT NO	MATERIAL COLOR
67900-001	BLUE

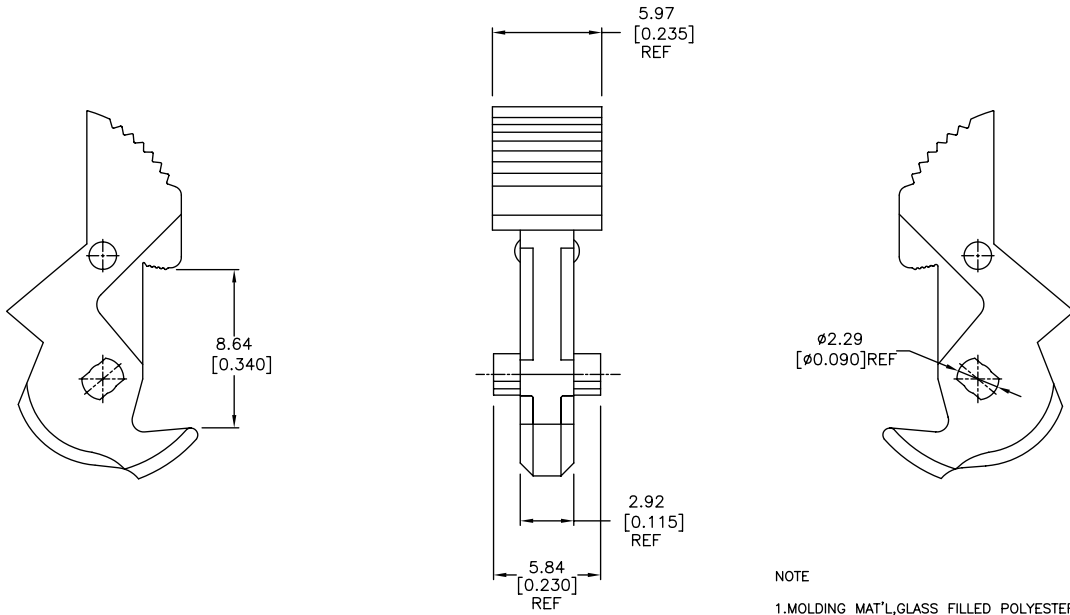

NOTE

1. MOLDING MAT'L, GLASS FILLED POLYESTER, FLAME RETARDANT PER UL-94V-0, COLOR: SEE TABLE.

2. STANDARD TOLERANCES:  
 .X±.3 / .XX±.01  
 .XX±.13 / .XXX±.005  
 .XXX±.051 / .XXXX±.0020

mat'l code		surface		tolerance		projection		product family	
---		ISO 902		ISO 406 ISO 1101		MM/INCH		QUICKIE	
titr	ec'n no	dr	date	tolerances unless otherwise specified		SEE NOTE 2		title	
A	v06-0424	DPU	06/05/06	angles		linear		SEA-HORSE LATCH CARD CONNECTOR	
				0°±2'		scale 1:5		dwg no sheet 1 of 1 size	
				dr DEEPESH U 06/05/06		FCI		67900 A3	
				engr H.SUNDY 06/05/06				type Product Customer Drawing	
				chr H.SUNDY 06/05/06					
				appd H.SUNDY 06/05/06					
sheet index	revision sheet	A							
	1								

PDM: Rev:A

STATUS: Released

Printed: Apr 12, 2011