

## Excellent Integrated System Limited

Stocking Distributor

Click to view price, real time Inventory, Delivery & Lifecycle Information:

[FCI](#)  
[HM2P07PKH1N0GF](#)

For any questions, you can email us directly:  
[sales@integrated-circuit.com](mailto:sales@integrated-circuit.com)

LOADING PATTERN MATING SIDE

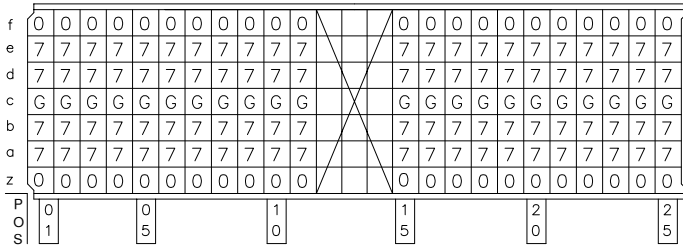

LOADED CONNECTOR ASSEMBLY  
(FOR EXAMPLE)

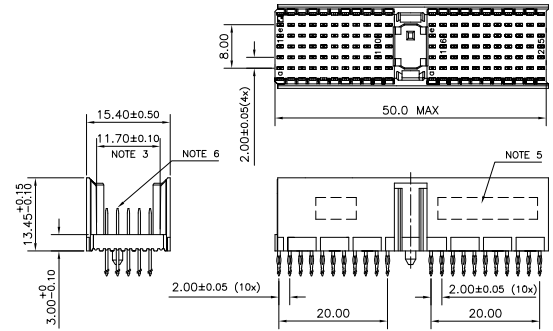

CONTACT OVERVIEW

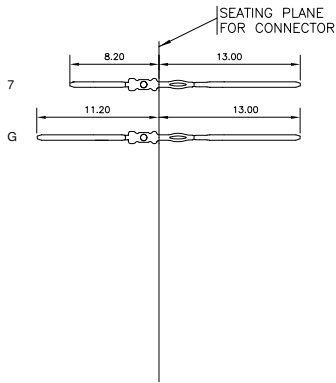

LAY-OUT P.C.B.-HOLE

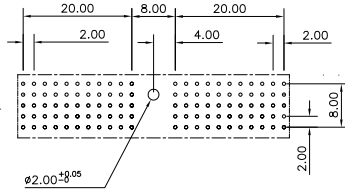

HM2P07PKH1N0GF  
 LEAD FREE INDICATOR : LF = LEAD FREE (DIGIT 15 & 16)  
 PLATING CODE (DIGIT 13 AND 14) (REF DRW NO. BS.C , 201844 , 003)

NOTES

- THIS PRODUCT IS CSA APPROVED.
- THIS PRODUCT IS UL RECOGNIZED.
- MEASURED AT THE BOTTOM.
- MATERIAL CONTACT: PHOSPHORBRONZE  
HOUSING: CREAM WHITE GLASS FILLED POLYESTER UL-94V0
- CONNECTOR PRINTED WITH P/N AND DATE CODE.
- FOR ACTUAL CONTACT LOADINGS, SEE LOADING PATTERN MATING SIDE.
- SHAPE OF CONNECTOR HOUSING CAN ALTER DEPENDING ON PRODUCTION LOCATION
- THE PRODUCT (LF) MEETS EUROPEAN UNION DIRECTIVES AND OTHER COUNTRY REGULATIONS AS DESCRIBED IN GS-22-008
- FOR RECOMMENDED PTH DIMENSIONS REFER DRAWING : BS, A , 201572 , 001
- CATALOG NO: HM2P07PKH1N0---

mat'l. code				surface		tolerance		projection	product family	
SEE NOTE 4				ISO 1302	ISO 406	ISO 1101			MILLIPACS	
ltr	ecn no	dr	date	tolerances unless otherwise specified					title	
A	IS-0234	MINI	2005-11-16	angles	0±0.2			MM	MPACS 5+2R STR HDR PF CONN TYPE A	
B	IS-0132	MINI	2006-07-29	linear	00±0.1			scale		
		dr	MINI K VANDANATH	2005-11-16					dwg no	
		enrg	BIJU K PAUL	2005-11-16					sheet 1 of 1	
		chr	BIJU K PAUL	2006-07-29					size	
		appd	BIJU K PAUL	2006-07-29					A3	
sheet	revision	B							type Product Customer Drawing	
index	sheet	1								