

## **Excellent Integrated System Limited**

Stocking Distributor

Click to view price, real time Inventory, Delivery & Lifecycle Information:

[E-Switch](#)  
[P297EEPA](#)

For any questions, you can email us directly:

[sales@integrated-circuit.com](mailto:sales@integrated-circuit.com)

SHEET OF

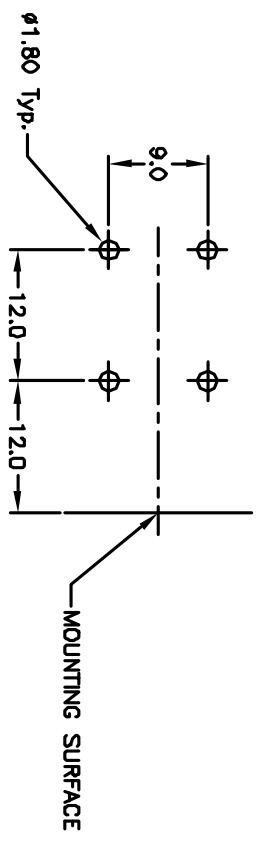
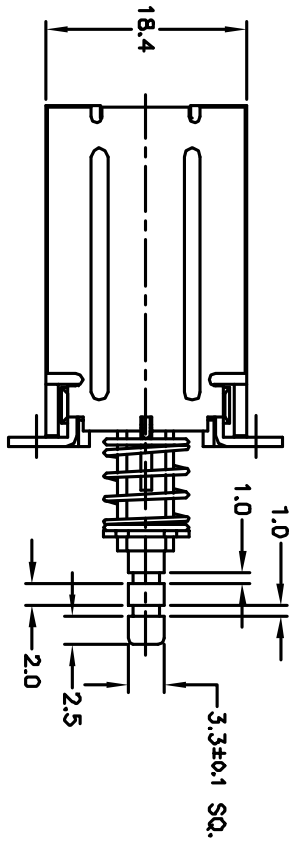

RECOMMEND P.C.B. LAYOUT

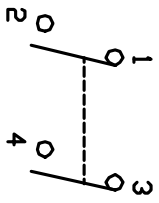
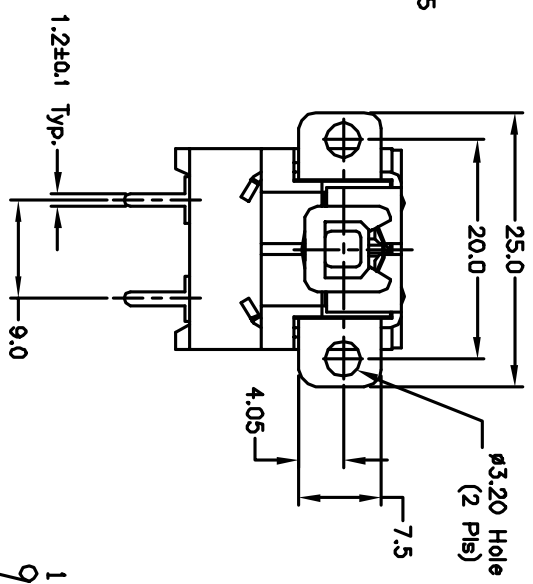
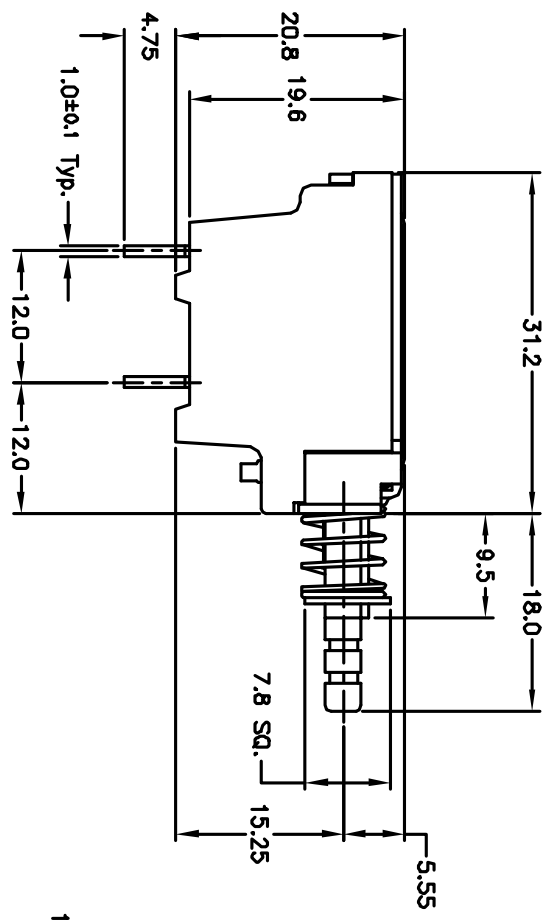

CIRCUIT: DPST (Normally Open)  
CONTACT CONFIGURATION

NOTES:

1. ALL DIMENSIONS IN MM
2. GENERAL TOLERANCE: 0.0 $\pm$ 0.4  
0.00 $\pm$ 0.25
3. RATING: AC 250V 5A; IN-RUSH: 80A, TV-5
4. CONTACT RESISTANCE: 50m ohms MAX. (AT DC 5V 1A)
5. DIELECTRIC STRENGTH: AC 1,000V FOR 1 MINUTE
6. OPERATING FORCE: 500 $\pm$ 100gf
7. TRAVEL: Full: 4.0mm; Lock: 2.5mm

REV.	ECN No.	DESCRIPTION	DATE	CHKD
A	10478	RELEASED FOR PRODUCTION		

TITLE	SCALE	DATE	DR	DWG	REV
P297 EE P A	1.5/1	12/23/99	MM	P030118	A

**E-SWITCH**®

THE INFORMATION CONTAINED IN THIS DOCUMENT IS PROPRIETARY TO E-SWITCH AND IS NOT TO BE COPIED OR TRANSMITTED