

Excellent Integrated System Limited

Stocking Distributor

Click to view price, real time Inventory, Delivery & Lifecycle Information:

[Soberton, Inc.](#)
[WST-1201BX](#)

For any questions, you can email us directly:

sales@integrated-circuit.com

Product Data Sheet

Part No. WST-1201 BX Washable Type

(self drive circuit)

DIMENSIONS

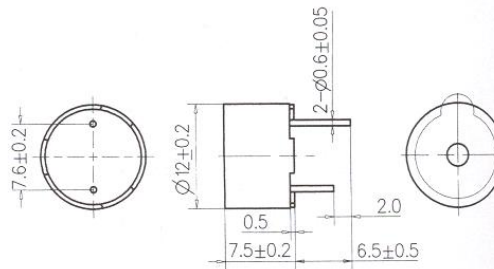

UNIT : mm
 TOLERANCE : ± 0.3
 HOUSING MATERIAL : PBT

Type	Unit	
Rated Voltage	(Vdc)	1.5
Operating Voltage	(Vdc)	1.4~2
Rated Current	(mA)	< 25
Sound Output at 10cm	(dB)	> 75
Resonance Frequency	(Hz)	2300±500
Response Time	(Ms)	< 25
Operating Temp	(C)	-20+70
Storage Temp	(C)	-25+80
Weight	(g)	2
Dimension	mm	12 x H7.5

*Value applying rated voltage (DC)

*distance for measurement 10cm

*WST-12XXBX: 3100 Hz

CHARACTERISTICS

