

## Excellent Integrated System Limited

Stocking Distributor

Click to view price, real time Inventory, Delivery & Lifecycle Information:

[Wurth Electronics Inc](#)  
[744776022A](#)

For any questions, you can email us directly:

[sales@integrated-circuit.com](mailto:sales@integrated-circuit.com)

## Spezifikation für Freigabe / specification for release

Kunde / customer :  
 Artikelnummer / part number : **744776022A**  
 Bezeichnung : **SPEICHERDROSSEL WE-PD2**  
 description : **POWER-CHOKE WE-PD2**



DATUM / DATE : 2003-07-03

### A Mechanische Abmessungen / dimensions:

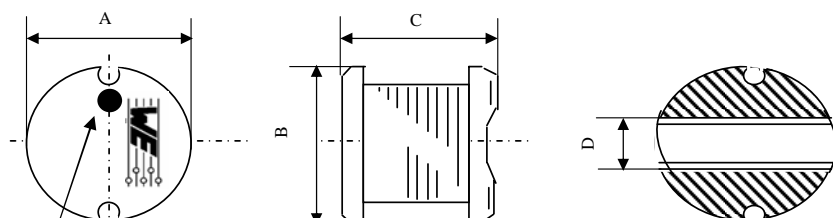

marking dot is start winding & inductance code

	Typ XL	
A	<b>9,5 ± 0,3</b>	mm
B	<b>9,5 ± 0,3</b>	mm
C	<b>5,5 ± 0,3</b>	mm
D	<b>2,9 typ</b>	mm
E	<b>10,0 ref</b>	mm
F	<b>10,0 ref</b>	mm
G	<b>2,8 ref</b>	mm

### B Elektrische Eigenschaften / electrical properties:

### C Lötpad / soldering spec.:

Eigenschaften / properties	Testbedingungen / test conditions		Wert / value	Einheit / unit	tol.
Induktivität / inductance	<b>1 kHz / 0,25V</b>	L	<b>2,2</b>	μH	<b>±20%</b>
Güte Q / Q factor	<b>7,960 MHz</b>	Q	<b>35</b>		
DC-Widerstand / DC-resistance		R <sub>DC</sub>	<b>0,02</b>	Ω	<b>max.</b>
Nennstrom / rated current		I <sub>DC</sub>	<b>5,40</b>	A	<b>max.</b>
Eigenres.-Frequenz / self-res.-frequency		SRF	<b>68,00</b>	MHz	

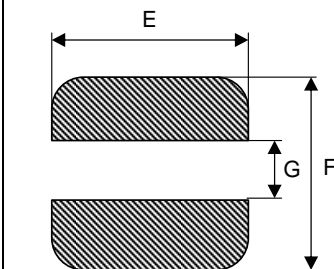

### D Prüfgeräte / test equipment:

**HP 4274 A** für/for L und/and Q  
**HP 4274 A** für/for R<sub>DC</sub> und I<sub>DC</sub>

### E Testbedingungen / test conditions:

Luftfeuchtigkeit / humidity: 33%  
 Umgebungstemperatur / temperature: +20°C

### F Werkstoffe & Zulassungen / material & approvals

Basismaterial / base material: Ferrit  
 Draht / wire: 2UEW ; 130°C

### G Eigenschaften / general specifications:

Lagertemperatur / storage temperature: -40°C ~ + 125°C  
 Betriebstemp. / operating temperature: -40°C ~ +105°C

Freigabe erteilt / general release:	Kunde / customer			
.....	.....			
Datum / date	Unterschrift / signature	SST	Update temperature	03-07-03
	<b>Würth Elektronik</b>	RT	Update	2002-01-20
		RT	Update	02-04-10
		MST	Neugestaltung	02-02-05
Geprüft / checked	Kontrolliert / approved	Name	Änderung / modification	Datum / date

This electronic component has been designed and developed for usage in general electronic equipment. Before incorporating this component into any equipment where higher safety and reliability is especially required or if there is the possibility of direct damage or injury to human body, for example in the range of aerospace, aviation, nuclear control, submarine, transportation, (automotive control, train control, ship control), transportation signal, disaster prevention, medical, public information network etc, Würth Elektronik eiSos GmbH must be informed before the design-in stage. In addition, sufficient reliability evaluation checks for safety must be performed on every electronic component which is used in electrical circuits that require high safety and reliability functions or performance.