

Excellent Integrated System Limited

Stocking Distributor

Click to view price, real time Inventory, Delivery & Lifecycle Information:

[Schurter](#)
[4840.2210](#)

For any questions, you can email us directly:

sales@integrated-circuit.com

DC Connector, Socket, 6.3 mm, 2.35 mm, 2-pole, solder terminal



Description

- Solder terminal:
Screw-on mounting, from rear-side
- Low Voltage DC Plug and Socket
- DC Plug: 2-pole, straight

Technical Data

Diameter	6.3 mm / 2.35 mm	Allowable Operation Temp.	-20°C to 70°C
Number of Poles	2-pole	Terminal	solder terminal silver plated
Ratings DC	1 A / 12VDC	Mounting	Screw-on mounting wall thickness max. 5.5mm
Dielectric Strength	500VDC	Style	straight
Insulation Resistance	> 100 MΩ @ 500VDC	Lifetime	5000Insertions

Dimensions

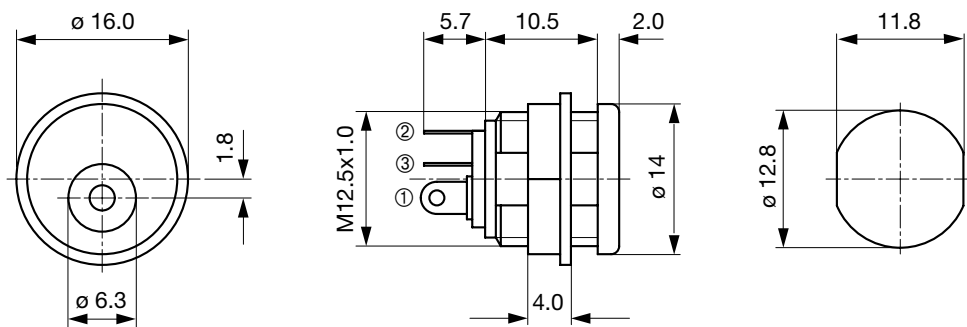

Diagrams

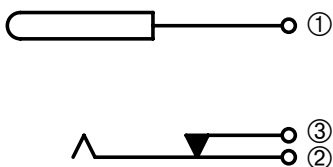

All Variants

Product group	Diameter [mm]	Number of Poles	Terminal	Order Number
DC Plug/Socket	6.3	2-pole	solder terminal	4840.2210

Most Popular.

Packaging unit 250 Pcs

Mating Inlets/Plugs

Category / Description

[DC Plug/Socket Overview complete](#)



4840, solder terminal, Plug, 5.5 mm, 2-pole, DC Plug/Socket	4840.1210
4840, Cable, Plug, 5.5 mm, 2-pole, DC Plug/Socket	4840.5210
4840, Cable, Plug, 5.5 mm, 2-pole, DC Plug/Socket	4840.5211

[DC Plug/Socket further types to 4840.2210](#)