

Excellent Integrated System Limited

Stocking Distributor

Click to view price, real time Inventory, Delivery & Lifecycle Information:

[Schurter](#)
[4840.2220](#)

For any questions, you can email us directly:

sales@integrated-circuit.com

DC Plug/Socket

www.schurter.com/PG12_2

4840.2220

DC Connector, Socket, 5.9 mm, 1.05 mm, 2-pole, solder terminal



Description

- Solder terminal:
Screw-on mounting, from rear-side
- Low Voltage DC Plug and Socket
- DC Plug: 2-pole, straight

Technical Data

Diameter	5.9 mm / 3.0 mm / 1.05 mm
Number of Poles	2-pole
Ratings DC	2A / 13.5VDC
Dielectric Strength	500VDC
Insulation Resistance	> 100 MΩ @ 500VDC

Allowable Operation Temp.	-20 °C to 70 °C
Terminal	solder terminal silver plated
Mounting	Screw-on mounting wall thickness max. 3.0mm
Style	straight
Lifetime	5000 Insertions

Dimensions

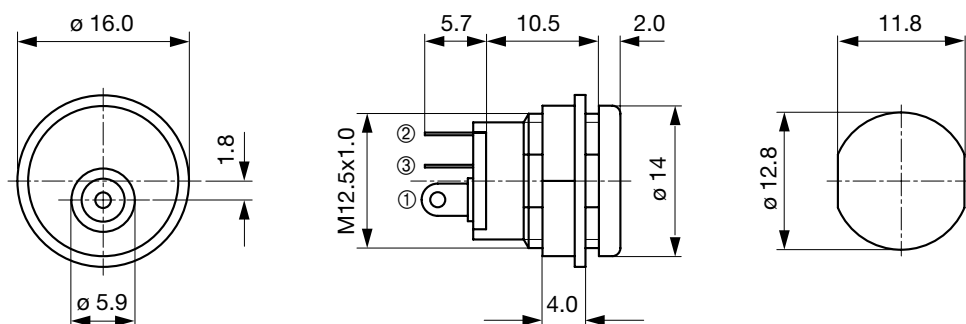

Diagrams

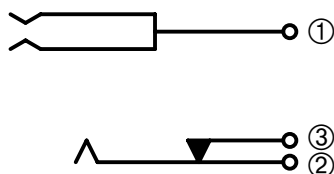

All Variants

Product group	Diameter [mm]	Number of Poles	Terminal	Order Number
DC Plug/Socket	5.9	2-pole	solder terminal	4840.2220

Availability for all products can be searched real-time: <http://www.schurter.com/Stock-Check/Stock-Check-SCHURTER>

4840.2220

DC Plug/Socket
www.schurter.com/PG12_2**Packaging unit** 250 Pcs**Mating Inlets/Plugs****Category / Description**[DC Plug/Socket Overview complete](#)

4840, solder terminal, Plug, 5.5 mm, 2-pole, DC Plug/Socket	4840.1220
4840, Cable, Plug, 5.5 mm, 2-pole, DC Plug/Socket	4840.5220
4840, Cable, Plug, 5.5 mm, 2-pole, DC Plug/Socket	4840.5221

[DC Plug/Socket further types to 4840.2220](#)