

Excellent Integrated System Limited

Stocking Distributor

Click to view price, real time Inventory, Delivery & Lifecycle Information:

[Molex Connector Corporation](#)
[0334810301](#)

For any questions, you can email us directly:

sales@integrated-circuit.com

TABLE OF CONTENTS	
SHEET NO.	SHEET DESCRIPTION
1	NOTES
2	KEY CONFIGURATIONS
3	BLADE SEALED ASSEMBLY
4	SYSTEM PACKAGING
5	RUBBER BOOT CONFIGURATION
6	BOM
7	RUBBER BOOT INTERFACE

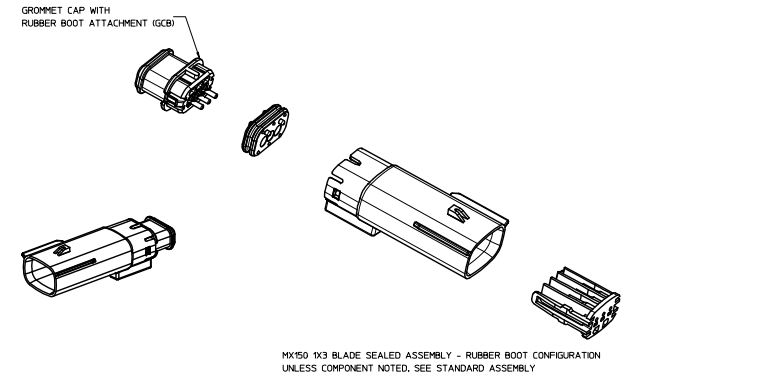
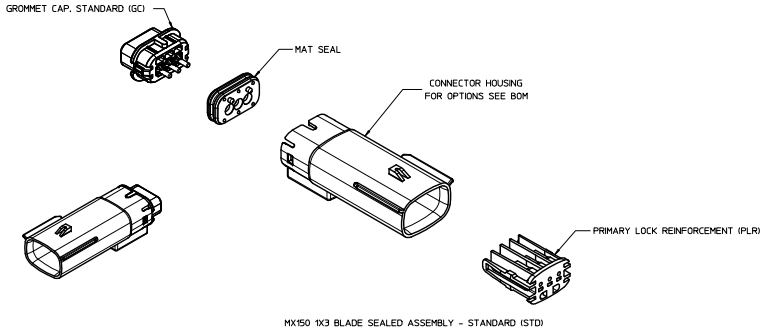

NOTES: VALID UNLESS OTHERWISE SPECIFIED

1. GENERAL:
 - a. APPLICATION SPECIFICATION SEE: AS-33472-100
 - b. CONTAINS: PRODUCT INTRODUCTION, PRODUCT SUMMARY, CONNECTOR ASSEMBLY, PACKAGING INFORMATION, CONNECTOR MATING, SERVICE INSTRUCTIONS, ELECTRICAL CONTINUITY CHECKING, CRIMPING AND TROUBLESHOOTING.
 - c. DESIGNED TO MATE WITH RECEPTACLE SEALED ASSEMBLY SPECIFIED IN MOLEX DRAWING SD-33471-031.
 - d. FOR 15mm BLADE TERMINALS TO BE USED WITH THIS ASSEMBLY SEE MOLEX DRAWING SD-33000-001.
 - e. SYSTEM TO BE USED WITH WIRE WITHIN DIAMETER RANGE OF 1.2mm TO 2.69mm.
 - f. ASSEMBLY SHIPPED WITH PLR IN PRE-LOCK POSITION.
 - g. IN THE EVENT THAT THE PLR IS FOUND IN THE SEATED (FINAL LOCK) POSITION, REFER TO MOLEX SPECIFICATION PS-34646-001, AVAILABLE AT www.molex.com OR www.ros.com.
 - h. ASSEMBLY CONFORMS TO SAE/USCAR-2 REV.4 WITH THE FOLLOWING EXCEPTIONS:
 - 1. TERMINAL INSERTION FORCE FOR WIRE DIAMETER ABOVE 2.5mm NOT EXCEEDING 2.69mm.
 - 2. SHALL NOT EXCEED 43 NEWTONS.
2. PRODUCT SPECIFICATION SEE: PS-3471430
 - a. CONTAINS: PRODUCT INTRODUCTION, PRODUCT SUMMARY, RATINGS (CURRENT, TEMPERATURE, SEALING, AND FLAMMABILITY), AND PRODUCT VALIDATION.
 - b. PACKAGING SPECIFICATION PER MOLEX DRAWING: PK-31300-635
 - c. PARTS MUST BE IN COMPLIANCE TO MOLEX CHEMICAL SUBSTANCES FOR PRODUCTS AND PACKAGING SPECIFICATIONS ES-40000-5016
 - d. DATA MUST BE SUBMITTED UNDER THE MOLEX PART NUMBER TO MDS (COMPANY ID#19255)
3. DESIGN - MATERIALS:
 - a. CONNECTOR HOUSING, GROMMET CAP, PLR: SPS/NYLON BLEND 20% GLASS FILLED
 - b. MAT SEAL: INHERENTLY LUBRICATED SILICONE
3. DESIGN - GEOMETRY:
 - a. THIS IS A 100% CAD GENERATED PART. THE CAD MATHEMATICAL DATA IS THE MASTER FOR THIS PART. FOR DIMENSIONAL OR ANY INFORMATION NOT SHOWN ON THIS DRAWING, ANALYZE THE CAD MODEL.
 - b. GEOMETRIC DIMENSIONS AND TOLERANCES PER ASME Y14.5H - 1994
 - c. EDGES AND UNDIMENSIONED DETAILS PER ISO13715
 - d. CORNERS SHOWN AS SHARP TO BE 0.2 MAX
 - e. LETTERING SHALL BE 0.5 MAX RAISED IN 0.25 MAX RECESS PAD. THIS INCLUDES RECYCLING CODE, CAVITY ID, VENDOR IDENTIFICATION, AND CUSTOMER MATERIAL NUMBER.
 - f. VISUAL DEFECTS SHALL MEET COSMETIC STANDARD PS-45499-002 (Class B)
 - g. LASER MARKING: 1D0

INSPECTION NUMBER LOG
LAST NUMBER USED: 21
ADDED:
REMOVED:

REV	DESCRIPTION
R3	DEVIATED THE DIM 16
R2	RELEASED P/N 33481-0341
R1	RELEASED P/N 33481-0340. DELETED P/N 33481-0331
R	ADD RUBBER BOOT CONFIGURATION
Q	UPDATE P/N 33481-0326 TO 33481-0330
P	ADD NEW P/N 33481-0326
N	UPDATED GROMMET CAP
M3	UPDATED DIMENSIONS TO MATCH MODEL
M2	COLOR REPLACEMENT FOR KEY C AND D PER USCAR STANDARD
M1	UPDATED NOTES
M	REDRAWN

QUALITY SYMBOLS	GENERAL TOLERANCES (UNLESS SPECIFIED)		DRAWN BY		DATE		TITLE	
	mm	INCH	DMARCOUX	06-12-02	METRIC	THIRD ANGLE PROJECTION		
▽=0	4 PLACES ±---	±---	DRAWN BY DATE					MX150 1X3 BLADE SEALED ASSEMBLY MAT SEAL
▽=0	3 PLACES ±---	±---	CHECKED BY DATE					
▽=0	2 PLACES ±0.10	±---	DGR IFFIT 06-12-02					
▽=0	1 PLACE ±0.3	±---	APPROVED BY DATE					
▽=0	0 PLACE ±	±	FHOLLUB 06-12-02					
ANGULAR ± 3 °			MATERIAL		DOCUMENT NO.		SHEET NO.	
DRAFT WHERE APPLICABLE MUST REMAIN WITHIN DIMENSIONS			SEE BOM		SD-33481-031		1 OF 7	
THIS DRAWING CONTAINS INFORMATION THAT IS PROPRIETARY TO MOLEX INCORPORATED AND SHOULD NOT BE USED WITHOUT WRITTEN PERMISSION								

KEY CONFIGURATIONS

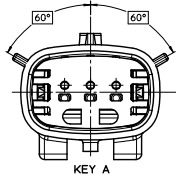

KEY A

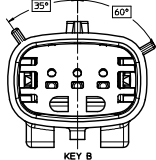

KEY B

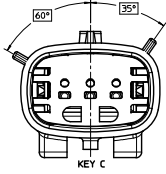

KEY C

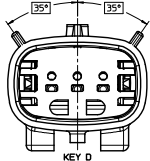

KEY D

SEE REV. COLUMN EC NO. UAD205-0991 DRAWN: SONGS 28/4/08/13 CHECKED: LING 28/4/08/13 APPROVED: 28/4/08/13 REV.	QUALITY SYMBOLS	GENERAL TOLERANCES (UNLESS SPECIFIED)	DRIMENSION STYLE MM ONLY	SCALE 4:1	DESIGN UNITS METRIC	THIRD ANGLE PROJECTION
	▽=0	4 PLACES ± 0.15	mm INCH	DRAWN BY DMARLOUX	DATE 06-12-02	TITLE MX150 1X3 BLADE SEALED ASSEMBLY MAT SEAL
	▽=0	3 PLACES ± 0.20		CHECKED BY DGRIFFIT	DATE 06-12-02	
	▽=0	2 PLACES ± 0.30		APPROVED BY FHOLUB	DATE 06-12-02	
	1 PLACE ± 0.3		ANGULAR ± 3°	MATERIAL NO. SEE BOM	DOCUMENT NO. SD-33481-031	SHEET NO. 2 OF 2
	0 PLACE ±		DRAFT WHERE APPLICABLE MUST REMAIN WITHIN DIMENSIONS	SIZE D	THIS DRAWING CONTAINS INFORMATION THAT IS PROPRIETARY TO MOLEX INCORPORATED AND SHOULD NOT BE USED WITHOUT WRITTEN PERMISSION	

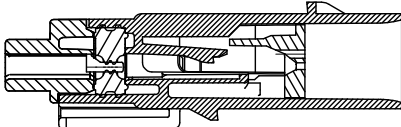
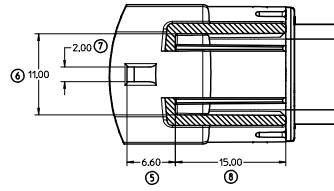
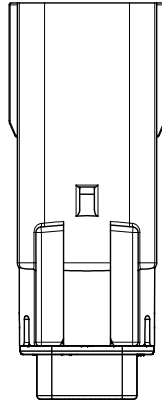
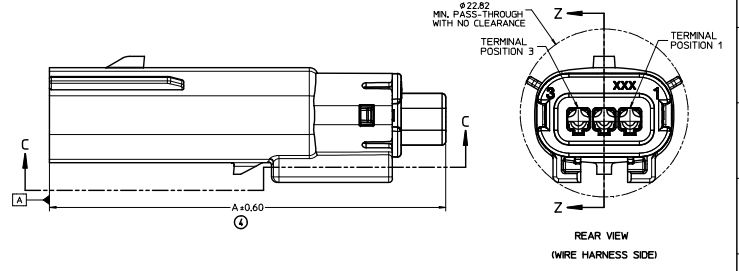
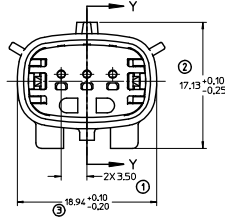
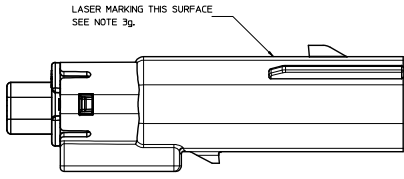

PRIMARY LOCK REINFORCEMENT (PLR) SHOWN
IN PRE-STAGED POSITION
SECTION Z-Z

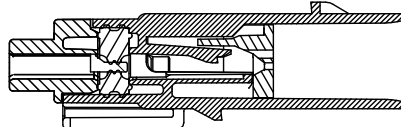

PRIMARY LOCK REINFORCEMENT (PLR) SHOWN
IN FINAL-LOCK POSITION
SECTION Y-Y

CHARTED DIMENSIONS	
CONFIGURATION	A
MX150 1X3 BLADE SEALED ASSEMBLY - STANDARD	53.85
MX150 1X3 BLADE SEALED ASSEMBLY - RUBBER BOOT CONFIGURATION	57.85

SEE REV. COLUMN EC NO. 14/0205-0991 R3 DRAWN: SONGS CHECKED: LING APPROVED: LING DATE: 20/11/02	QUALITY SYMBOLS ∇=0 ∇=0 ∇=0	GENERAL TOLERANCES (UNLESS SPECIFIED) mm INCH 4 PLACES ±0.10 ±0.004 3 PLACES ±0.15 ±0.006 2 PLACES ±0.30 ±0.012 1 PLACE ±0.50 ±0.020 0 PLACE ±0.75 ±0.030 ANGULAR ±3°	DIMENSION STYLE MM ONLY DRAWN BY: DMARLOUX CHECKED BY: DATE DGR IFFIT DATE: 06-12-02 APPROVED BY: DATE FHOLUB DATE: 06-12-02	SCALE: 4:1 DESIGN UNITS: METRIC THIRD ANGLE PROJECTION	TITLE: MX150 1X3 BLADE SEALED ASSEMBLY MAT SEAL MATERIAL NO.: SEE BOM DOCUMENT NO.: SD-33481-031	SHEET NO.: 3 OF 7
	DRAFT WHERE APPLICABLE MUST REMAIN WITHIN DIMENSIONS					
	THIS DRAWING CONTAINS INFORMATION THAT IS PROPRIETARY TO MOLEX INCORPORATED AND SHOULD NOT BE USED WITHOUT WRITTEN PERMISSION					
	molex					

SYSTEM PACKAGING

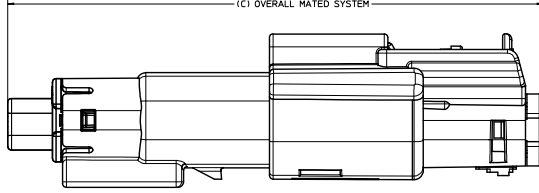

Ø25.30
MIN. PASS-THROUGH
WITH NO CLEARANCE

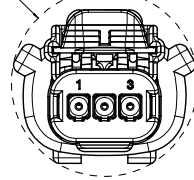

CHARTED DIMENSIONS	
CONFIGURATION	C
MX150 1X3 BLADE SEALED ASSEMBLY - STANDARD	72.71
MX150 1X3 BLADE SEALED ASSEMBLY - RUBBER BOOT CONFIGURATION	76.71

SEE REV. COLUMN EC NO. UAD205-0991 R3 DRAWN: SONGS 28/11/08/13 CHECKED: LING 28/11/08/13 APPROVED: 28/11/08/13 REV.	QUALITY SYMBOLS	GENERAL TOLERANCES (UNLESS SPECIFIED)	DRIMENSION STYLE	SCALE	DESIGN UNITS	THIRD ANGLE PROJECTION
	∇=0	mm INCH	MM ONLY	4:1	METRIC	
	∇=0	4 PLACES ± --- ± ---	DRAWN BY	DATE	TITLE	
	∇=0	3 PLACES ± --- ± ---	DMARLOUX	06-12-02	MX150 1X3 BLADE SEALED ASSEMBLY MAT SEAL	
	2 PLACES ± 0.10 ± ---	CHECKED BY	DATE			
	1 PLACE ± 0.3 ± ---	DGR IFFIT	06-12-02			
	0 PLACE ± ±	APPROVED BY	DATE			
	ANGULAR ± 3 °	FHOLUB	06-12-02			
	DRAFT WHERE APPLICABLE MUST REMAIN WITHIN DIMENSIONS	MATERIAL NO.	SEE BOM	DOCUMENT NO.	SD-33481-031	SHEET NO. 4 OF 7
		SIZE	D	THIS DRAWING CONTAINS INFORMATION THAT IS PROPRIETARY TO MOLEX INCORPORATED AND SHOULD NOT BE USED WITHOUT WRITTEN PERMISSION		

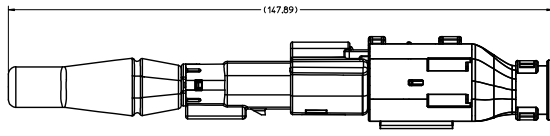

OVERALL MATED SYSTEM WITH BLADE RUBBER BOOT AND RECEPTACLE BACKSHELL

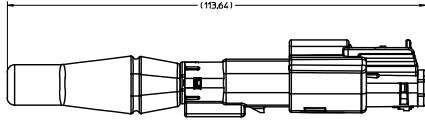
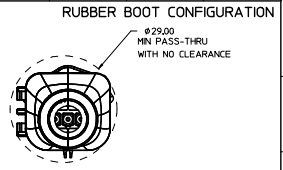

OVERALL MATED SYSTEM WITH BLADE RUBBER BOOT

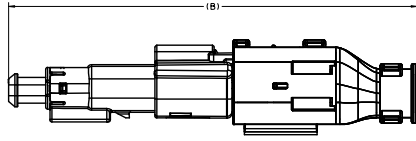
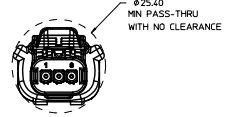

OVERALL MATED SYSTEM WITH RECEPTACLE BACKSHELL

CHARTED DIMENSIONS	
CONFIGURATION	B
MX150 1X3 BLADE SEALED ASSEMBLY - STANDARD	106.96
MX150 1X3 BLADE SEALED ASSEMBLY - RUBBER BOOT CONFIGURATION	110.96

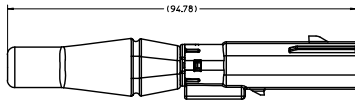
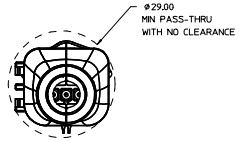

BLADE SEALED ASSEMBLY WITH BLADE RUBBER BOOT

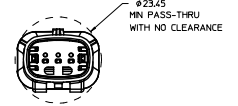

SEE REV. COLUMN EC NO. UAD205-0991 R3 DRAWN: SONGS 28/11/08 CHECKED: LING 28/11/08 APPROVED: LING 28/11/08 BY:	QUALITY SYMBOLS	GENERAL TOLERANCES (UNLESS SPECIFIED)	DRIMENSION STYLE	SCALE	DESIGN UNITS	THIRD ANGLE PROJECTION	
	∇=0 ∇=0 ∇=0	mm INCH 4 PLACES ± --- ± --- 3 PLACES ± --- ± --- 2 PLACES ± 0.5 ± --- 1 PLACE ± 0.3 ± --- 0 PLACE ± ±	MM ONLY 2:1	DRAWN BY DATE DMARLOUX 06-12-02 CHECKED BY DATE DGRFFIT 06-12-02 APPROVED BY DATE FHOLUB 06-12-02	METRIC	MX150 1X3 BLADE SEALED ASSEMBLY MAT SEAL molex	SHEET NO. 5 OF 7
	ANGULAR ± 3 ° DRAFT WHERE APPLICABLE MUST REMAIN WITHIN DIMENSIONS	MATERIAL NO. SEE BOM	DOCUMENT NO. SD-33481-031				
	THIS DRAWING CONTAINS INFORMATION THAT IS PROPRIETARY TO MOLEX INCORPORATED AND SHOULD NOT BE USED WITHOUT WRITTEN PERMISSION						

BOM

ASSEMBLY PART NUMBER	COLOR	KEYING OPTION	CAVITY TYPE & STATUS (X = PLUGGED)			COMMENTS	OPTIONAL ATTACHMENT SOLD SEPARATELY SMP RUBBER BOOT
			1	2	3		
33481-0301	BLACK	A					NOT AVAILABLE
33481-0302	LT. GRAY	B					NOT AVAILABLE
33481-0303	BROWN	C				NOT RECOMMENDED, SEE P/N 33481-0322	NOT AVAILABLE
33481-0304	GREEN	D				NOT RECOMMENDED, SEE P/N 33481-0323	NOT AVAILABLE
33481-0305	CUSTOM	TBD					NOT AVAILABLE
33481-0306	BLACK	A			X		NOT AVAILABLE
33481-0307	LT. GRAY	B			X		NOT AVAILABLE
33481-0308	BROWN	C			X		NOT AVAILABLE
33481-0309	GREEN	D			X		NOT AVAILABLE
33481-0310	CUSTOM	TBD			X		NOT AVAILABLE
33481-0311	BLACK	A	X		X		NOT AVAILABLE
33481-0312	LT. GRAY	B	X		X		NOT AVAILABLE
33481-0313	BROWN	C	X		X		NOT AVAILABLE
33481-0314	GREEN	D	X		X		NOT AVAILABLE
33481-0315	CUSTOM	TBD	X		X		NOT AVAILABLE
33481-0316	BLACK	A	X	X	X		NOT AVAILABLE
33481-0317	LT. GRAY	B	X	X	X		NOT AVAILABLE
33481-0318	BROWN	C	X	X	X	NOT RECOMMENDED, SEE P/N 33481-0324	NOT AVAILABLE
33481-0319	GREEN	D	X	X	X	NOT RECOMMENDED, SEE P/N 33481-0325	NOT AVAILABLE
33481-0320	CUSTOM	TBD	X	X	X		NOT AVAILABLE
33481-0321	BLACK	A		X			NOT AVAILABLE
33481-0322	DK. GRAY	C					NOT AVAILABLE
33481-0323	ST. GRAY	D					NOT AVAILABLE
33481-0324	DK. GRAY	C	X	X	X		NOT AVAILABLE
33481-0325	ST. GRAY	D	X	X	X		NOT AVAILABLE
33481-0326	YELLOW	A					NOT AVAILABLE
33481-0340	BLACK	A				RUBBER BOOT CONFIGURATION	P/N TBD
33481-0341	BLACK	A	X	X	X	RUBBER BOOT CONFIGURATION	P/N TBD

SEE REV. COLUMN REC. NO. 04/2015-0091 DR. W. SONGS 2014/08/13 CH. CHEN 2014/08/13 APPROVED 2014/08/13 DESCRIPTION	QUALITY SYMBOLS	GENERAL TOLERANCES (UNLESS SPECIFIED)	DIMENSION STYLE	SCALE	DESIGN UNITS	THIRD ANGLE PROJECTION
	▽=0	mm INCH	MM ONLY		METRIC	
	▽=0	4 PLACES ± --- ± ---	DRAWN BY	DATE	TITLE	
	▽=0	3 PLACES ± --- ± ---	DMARCOUX	06-12-02	MX150 1X3 BLADE SEALED ASSEMBLY MAT SEAL	
	2 PLACES ± 0.10 ± ---	CHECKED BY	DATE			
	1 PLACE ± 0.3 ± ---	DGR FIT	06-12-02			
	0 PLACE ± ±	APPROVED BY	DATE			
	ANGULAR ± 3 °	FHOLUB	06-12-02			
	DRAFT WHERE APPLICABLE MUST REMAIN WITHIN DIMENSIONS	MATERIAL NO.	SEE BOM	DOCUMENT NO.	SD-33481-031	SHEET NO. 6 OF 7
	SIZE D	THIS DRAWING CONTAINS INFORMATION THAT IS PROPRIETARY TO MOLEX INCORPORATED AND SHOULD NOT BE USED WITHOUT WRITTEN PERMISSION				

RUBBER BOOT INTERFACE

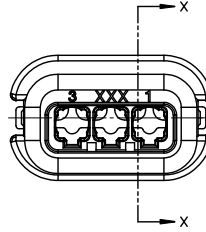
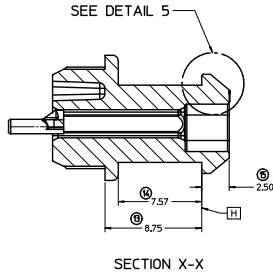
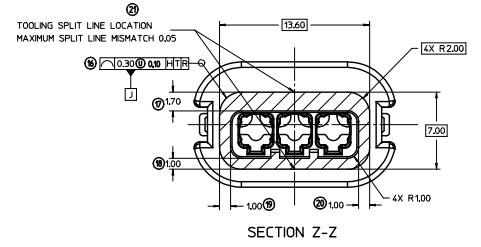
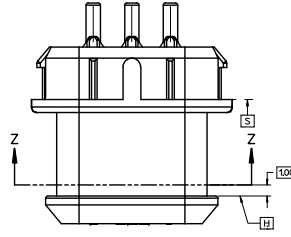
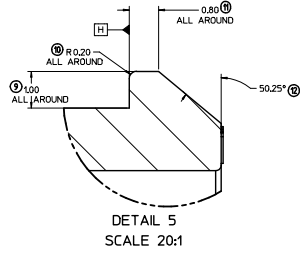

SEE REV. COLUMN EC NO. UAD205-0991 DRAWN BY: SONGS 28/11/08/13 CHECKED BY: 28/11/08/13 APPROVED BY: 28/11/08/13 REV.	QUALITY SYMBOLS	GENERAL TOLERANCES (UNLESS SPECIFIED)	DRAGON STYLE	SCALE	DESIGN UNITS	THIRD ANGLE PROJECTION
		mm INCH	MM ONLY	2:1	METRIC	
	▽=0	4 PLACES ± --- ± ---	DRAWN BY DATE			
	▽=0	3 PLACES ± --- ± ---	CHECKED BY DATE			
▽=0	2 PLACES ± 0.10 ± ---	DGR FIT DATE				
▽=0	1 PLACE ± 0.3 ± ---	APPROVED BY DATE				
▽=0	0 PLACE ± ±	FHOLUB DATE				
	ANGULAR ± 3 °	MATERIAL NO.				
	DRAFT WHERE APPLICABLE MUST REMAIN WITHIN DIMENSIONS	SEE BOM				
		SIZE D THIS DRAWING CONTAINS INFORMATION THAT IS PROPRIETARY TO MOLEX INCORPORATED AND SHOULD NOT BE USED WITHOUT WRITTEN PERMISSION				

MX150 1X3 BLADE
SEALED ASSEMBLY
MAT SEAL

molex

DOCUMENT NO. SD-33481-031 SHEET NO. 7 OF 7