

Excellent Integrated System Limited

Stocking Distributor

Click to view price, real time Inventory, Delivery & Lifecycle Information:

[Molex Connector Corporation](#)
[0522130211](#)

For any questions, you can email us directly:

sales@integrated-circuit.com

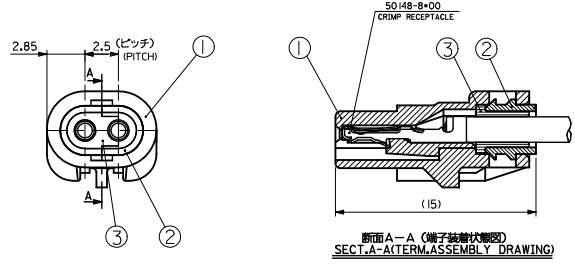
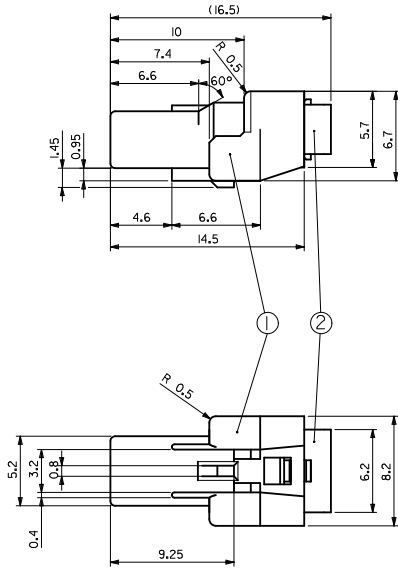

断面 A-A (端子挿入状態) SECT. A-A (TERMINAL ASSEMBLY DRAWING)

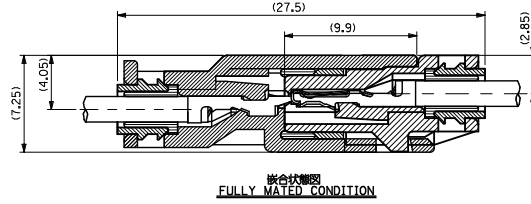

嵌合状態図 FULLY MATED CONDITION

注記 NOTE

1. 適合端子: 50148-8*00
APPLICABLE TERMINAL: 50148-8*00
2. 適合端子: 52266-021*
MATES WITH: 52266-021*
3. 製品仕様書: PS-52213-003
PRODUCT SPECIFICATION: PS-52213-003
4. 取扱説明書: AS-52213-001
APPLICATION SPECIFICATION: AS-52213-001

シリコン SILICONE	黄 YELLOW	ワイヤエンドシール WIRE END SEAL	③
ポリエステル (15%G.F.) POLYESTER (15%G.F.)	黒 BLACK	キャップ CAP	②
ポリエステル (15%G.F.) POLYESTER (15%G.F.)	透明 SEE CHART	受容体ハウジング RECEPTACLE HOUSING	①
材料 MATERIAL	色 COLOR	名称 TITLE	
構成部品 COMPONENTS			

REVISED EEC NO.: ITR2012-0084 2012/03/15 CHIKOSANNO 2012/03/02 APPER/MAYAMOTO 2012/03/16	GENERAL TOLERANCES (UNLESS SPECIFIED)		DIMENSION STYLE MM ONLY	SCALE 5:1	DESIGN UNITS METRIC	THIRD ANGLE PROJECTION
	10 UNDER	±0.2	DRAWN BY Y. ASHIZAWA	DATE 1990/05/15	TITLE 2.5 MINI WATERPROOF CONN. REC HSG ASSY (2 CKT.)	
	10 OVER 30 UNDER	±0.25	CHECKED BY M. SAKANO	DATE 1994/03/02	MATERIAL NO. SD-52213-002	
	30 OVER	±0.3	APPROVED BY MENOMOTO	DATE 1994/03/02	SHEET NO. 1 OF 1	
ANGULAR ±3°		DRAFT WHERE APPLICABLE MUST REMAIN WITHIN DIMENSIONS	SEE CHART		THIS DRAWING CONTAINS INFORMATION THAT IS PROPRIETARY TO MOLEX INCORPORATED AND SHOULD NOT BE USED WITHOUT WRITTEN PERMISSION	