

Excellent Integrated System Limited

Stocking Distributor

Click to view price, real time Inventory, Delivery & Lifecycle Information:

[Apem Inc.](#)
[ADTSA63NV](#)

For any questions, you can email us directly:
sales@integrated-circuit.com

THIS DOCUMENT IS THE PROPERTY OF APEM COMPONENTS AND SHALL NOT BE COPIED, REPRODUCED, DISCLOSED OR USED AS THE BASIS FOR MANUFACTURING OR SALE WITHOUT PERMISSION OF ADI. ANY UNAUTHORIZED REPRESENTATIVE OF APEM COMPONENTS INC.

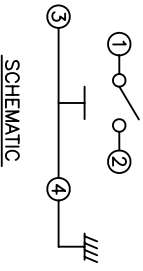
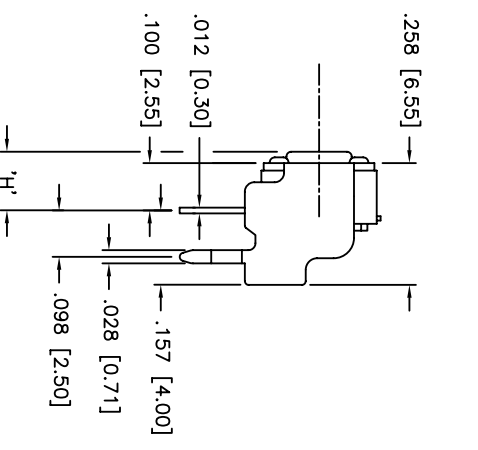
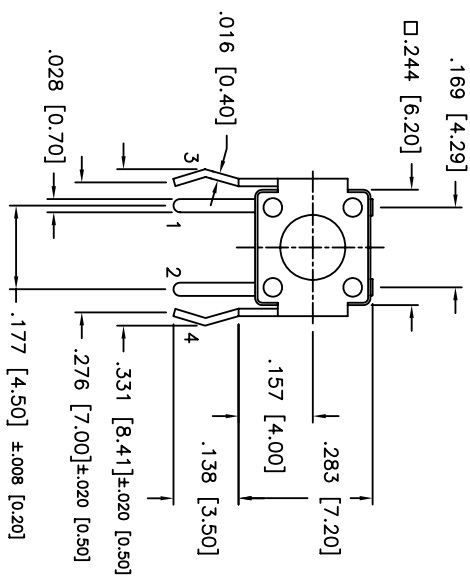
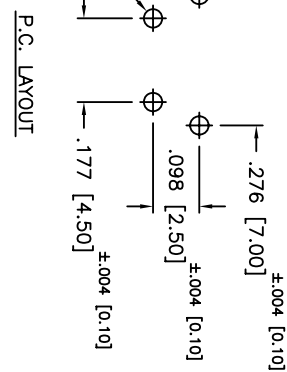
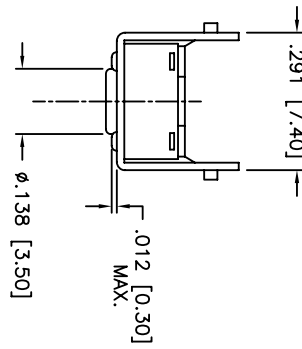

PART NUMBER DESCRIPTION
ADTSA 63**V

RIGHT ANGLE TACT. OPERATING FORCE:
DIM "L": 6 = 6mm X 6mm
6 = 467 [11.85]
5 = .329 [8.35]
3 = .230 [5.85]
2 = .152 [3.85]
1 = .124 [3.15]

COLOR OF STEM FOR OPERATING FORCE:
K = BLACK, 100gf
N = BROWN, 160gf
R = RED, 260gf
S = SALMON, 320gf
Y = YELLOW, 520gf

DESCRIPTION: SPDT, RIGHT ANGLE, THRU-HOLE MOUNT, GROUNDING, TACT SWITCH.
SPECIFICATIONS:
STORAGE TEMP. RANGE: -30°C TO +80°C
OPERATING TEMPERATURE RANGE: -25°C to +70°C
RATING: 50mA @ 12VDC
CONTACT RESISTANCE: 100mohm MAX.
INSULATION RESISTANCE: 100Mohm MIN, 500VDC.
DIELECTRIC STRENGTH: 250VAC FOR 1 MINUTE
ELECTRICAL LIFE: 100,000 CYCLES FOR 320gf; 260gf
ELECTRICAL LIFE: 200,000 CYCLES FOR 160gf
SHOCK RESISTANCE: 50G PER METHOD 213B,
MIL-STD-202F
VIBRATION RESISTANCE: PASSES METHOD 201A,
MIL-STD-202F
CONTACT ARRANGEMENT: 1 POLE, 1 THROW.
MATERIALS:
COVER: STAINLESS STEEL
CONTACT DISC: PHOSPHOR BRONZE WITH SILVER CLADDING
TERMINAL: .012THK X.028 [0.30 THK X 0.70]
BRASS WITH SILVER PLATING
BASE: UL 94V-0 NYLON THERMOPLASTIC COLOR: BLACK
STEM: UL 94V-0 NYLON THERMOPLASTIC
ROHS COMPLIANT

SOLDERING:
WAVE SOLDERING: 260°C MAX. FOR 5 SECONDS MAX.
HAND SOLDERING: 350°C MAX. FOR 5 SECONDS MAX.
(350 WATT IRON MAX.)
LEAD FREE PROCESS COMPATIBLE

DATE	SYM	REVISION RECORD	DMN.	CK
10/05	A	ECO# 480	CD	PD
1/08	B	ECO# 526	CD	PD

Q.A. INSECT	APEM 63 MESH RA 0183	REV	P/D
DESIGNS. CONTROL	10/07/04	REV	JT
DIMENSION	10/07/04-372-5534	REV	JT
TOLERANCES (UNLESS OTHERWISE SPECIFIED)			
XXX±.02[0.05]			
XXXX±.008[0.20]			
XXXX±.0008[0.02]			
ANGLE = 40.5°			
DO NOT SCALE DRAWING	DATE	DRAWING NO.	REV
	07/07/04	B7606	B