

Excellent Integrated System Limited

Stocking Distributor

Click to view price, real time Inventory, Delivery & Lifecycle Information:

[E-Switch](#)
[200MSP3T4B5M6REH](#)

For any questions, you can email us directly:

sales@integrated-circuit.com

SHEET 1 OF 1

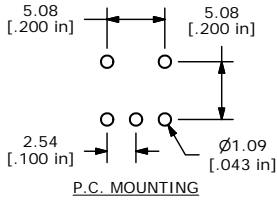

P.C. MOUNTING

SWITCH FUNCTION		
POS. 1	POS. 2	POS. 3
ON	OFF	ON
2-3	OPEN	2-1

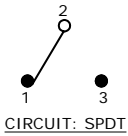

- NOTE:
- ALL DIMENSIONS IN MM [INCH]
 - GENERAL TOLERANCE: X.X=±0.4
X.XX=±0.25
 - TERMINAL NUMBERS FOR REF ONLY
 - PLATING MATERIAL: GOLD
 - RATING: 0.4VOLT-AMPS MAX. @20V MAX. AC OR DC
 - ELECTRIC LIFE: 30,000 MAKE-AND-BREAK CYCLES AT FULL LOAD.
 - INSULATION RESISTANCE: 1,000 MEGA-OHM MIN.
 - DIELECTRIC STRENGTH: 1,000 V RMS @SEA LEVEL.
 - OPERATING TEMP.: -30°C to 85°C
 - HARDWARE TO BE SHIPPED BULK
 T100000 - HEXNUT - QTY 2
 T100011 - LOCKWASHER - QTY 1
 T100015 - LOCKRING - QTY 1
 - ▲ DENOTES CRITICAL PARAMETER.

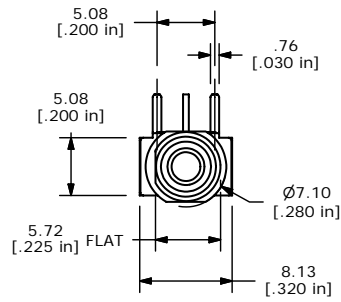

POS. 1 POS. 2 POS. 3

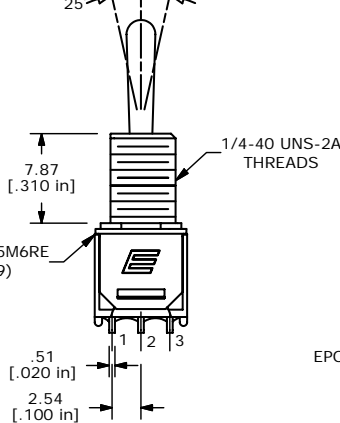

200MSP3T4B5M6RE (T212019)

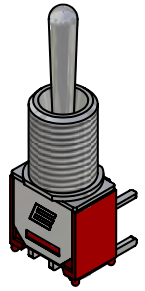
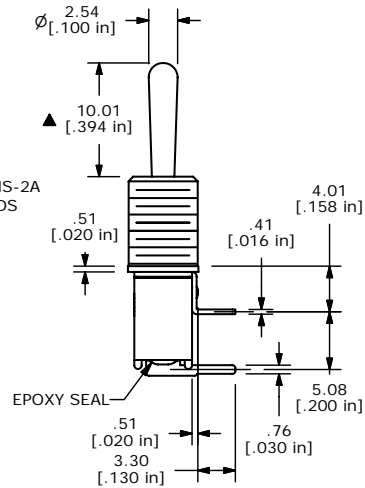

ISOMETRIC

REV	PCR NO	DESCRIPTION	DATE	BY
C	15593	DIM TO 10.01 FROM 10.41	12/07/05	PH
B	15460	DIM TO 10.41 FROM 10.01	10/26/05	PH
A	14746	RELEASED FOR PRODUCTION	3/14/05	AR

E-SWITCH®				
TITLE 200MSP3T4B5M6REH				
SCALE 2:1	DATE 3/14/2005	DR AR	DWG ST212019	REV C

THE INFORMATION CONTAINED IN THIS DOCUMENT IS PROPRIETARY TO E-SWITCH AND IS NOT TO BE COPIED OR TRANSFERRED