

Excellent Integrated System Limited

Stocking Distributor

Click to view price, real time Inventory, Delivery & Lifecycle Information:

[E-Switch](#)
[200MSP4T1B4M6QE](#)

For any questions, you can email us directly:

sales@integrated-circuit.com

SHEET OF



CIRCUIT: SPDT
 CONTACT CONFIGURATION

SWITCH FUNCTION		
POS. 1	POS. 2	POS. 3
(DN)	OFF	(DN)
2-3	OPEN	2-1

(DN) = MOMENTARY

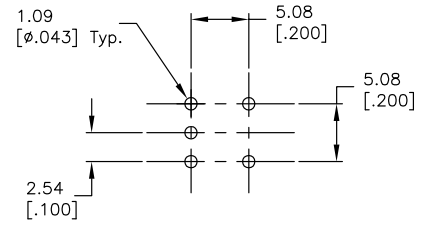
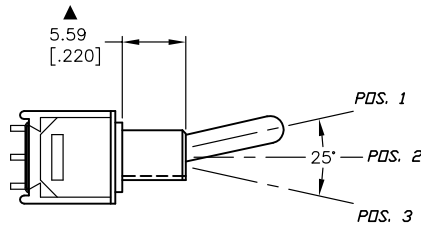

RECOMMEND P.C.B. LAYOUT

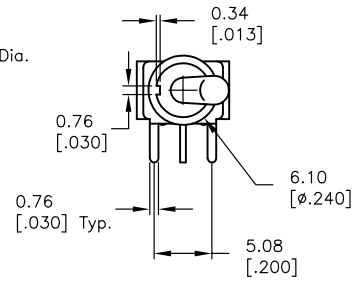
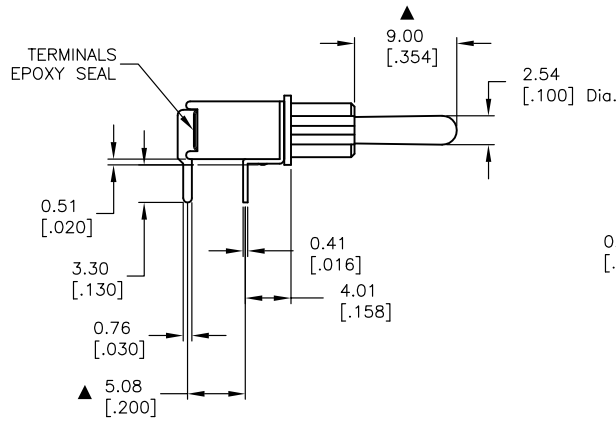
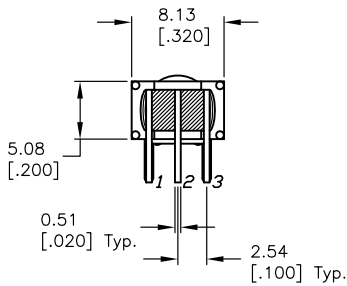

NOTES:

1. ALL DIMENSIONS IN MM [INCH]
2. GENERAL TOLERANCE: 0.0=±0.4
0.00=±0.25
3. TERM. NOS. FOR REF. ONLY
- ▲ 4. CONTACT MATERIAL: BRASS WITH SILVER PLATE
5. RATING: 3AMPS @ 120VAC OR 28VDC; 1AMP @250VAC
6. OPERATING TEMP: -30°C TO +85°C
7. MECHANICAL LIFE: 30,000 MAKE-AND-BREAK CYCLES
8. ▲ DENOTES CRITICAL PARAMETER.

E-SWITCH®

TITLE
 200MSP4T1B4M6QE

REV.	ECN No.	DESCRIPTION	DATE	CHKD
A	14247	RELEASED FOR PRODUCTION	8/18/04	AR

SCALE	DATE	DR	DWG	REV
2:1	8/18/04	AR	T214004	A

THE INFORMATION CONTAINED IN THIS DOCUMENT IS PROPRIETARY TO E-SWITCH AND IS NOT TO BE COPIED OR TRANSFERRED