

Excellent Integrated System Limited

Stocking Distributor

Click to view price, real time Inventory, Delivery & Lifecycle Information:

[E-Switch](#)
[500SDP1S2M2QEA](#)

For any questions, you can email us directly:

sales@integrated-circuit.com

SHEET 1 OF 1

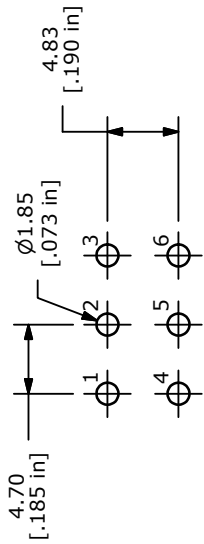

PC MOUNTING

| SWITCH FUNCTION ▲ | POS. 1 | POS. 2 | POS. 3 |
|-------------------|--------|----------|--------|
| ON | ON | NONE | ON |
| 2-1, 5-4 | N/A | 2-3, 5-6 | |

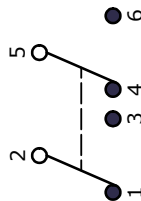

CIRCUIT: DPDT

- NOTE:
- ALL DIMENSIONS IN MM [INCH]
 - GENERAL TOLERANCE: X.X=±0.4
X.XX=±0.25
 - TERMINAL NUMBERS FOR REF ONLY
 - PLATING MATERIAL: SILVER
 - CONTACT RATING: 5A@120VAC or 28VDC
2A@250VAC
 - TRAVEL: 2.16mm
 - ELECTRIC LIFE: 30,000 ACTUATIONS AT FULL LOAD.
 - CONTACT RESISTANCE: 10 milli-OHMS TYP.
 - INSULATION RESISTANCE: 1,000 MEGA-OHM MIN.
 - DIELECTRIC STRENGTH: 1,000 V RMS @SEA LEVEL.
 - OPERATING TEMP.: -30°C to 85°C
 - ▲ DENOTES CRITICAL PARAMETER.
 - 2002/95/EC (ROHS) COMPLIANT

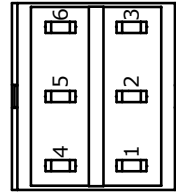
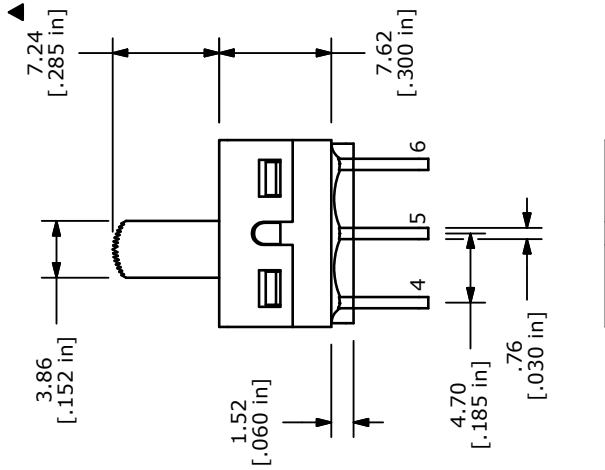
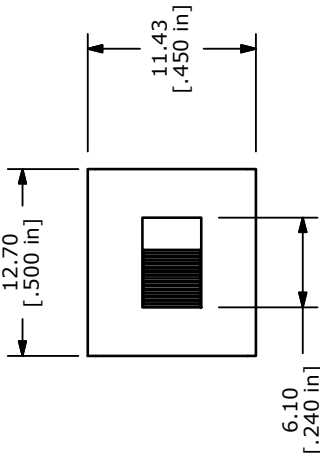
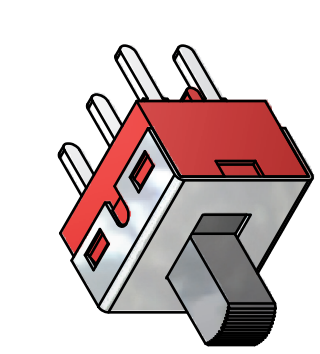

TITLE 500SDP1S2M2QEA

| | | | | |
|-----|--------|---------------------------|--------|-----|
| C | 19567 | DRAWING UPDATE / CLEAN-UP | 1/7/11 | BGL |
| REV | PCR NO | DESCRIPTION | DATE | BY |

THE INFORMATION CONTAINED IN THIS DOCUMENT IS PROPRIETARY TO E-SWITCH AND IS NOT TO BE COPIED OR TRANSFERRED

| | | | | | | | | | |
|-------|-----|------|----------|----|-----|-----|---------|-----|---|
| SCALE | 2:1 | DATE | 1/7/2011 | DR | BGL | DWG | T521008 | REV | C |
|-------|-----|------|----------|----|-----|-----|---------|-----|---|