

## Excellent Integrated System Limited

Stocking Distributor

Click to view price, real time Inventory, Delivery & Lifecycle Information:

[E-Switch](#)  
[5501MBLKYELYEL](#)

For any questions, you can email us directly:

[sales@integrated-circuit.com](mailto:sales@integrated-circuit.com)

SHEET OF

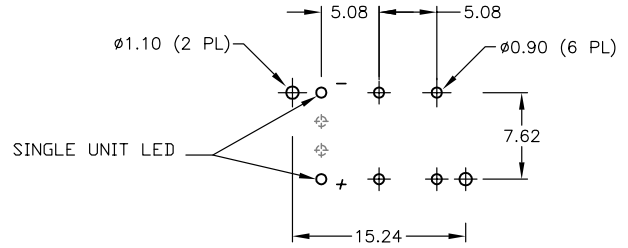
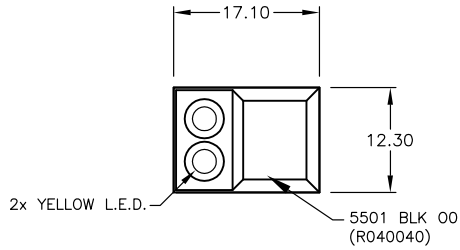

RECOMMENDED P.C.B. LAYOUT

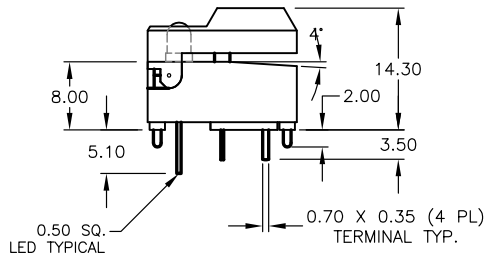

LED SPECIFICATION	SYMBOL	YEL L.E.D		UNITS
		MAX.	MIN.	
POWER DISSIPATION	$P_D$	100	--	mW
FORWARD VOLTAGE	$V_F$	2.8	1.8	2.1 V
REVERSE VOLTAGE	$V_R$	5	--	V
EMISSION WAVELENGTH	$\lambda_p$	--	--	590 nm
AVE. FORWARD CURRENT	$I_{AF}$	30	--	mA
REVERSE CURRENT	$I_R$	100	--	$\mu A$
LUMINOUS INTENSITY	$I_v$	5.0	12.0	mcd

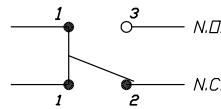
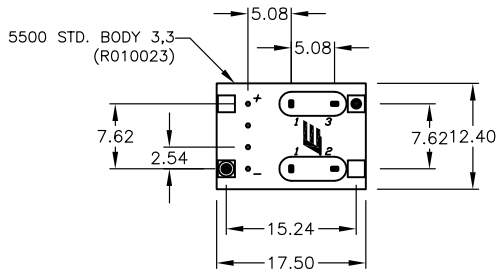

NOTES:

1. ALL DIMENSIONS IN MM
2. GENERAL TOLERANCE: X.X=±0.4  
X.XX=±0.25
3. TERM. NO. FOR REF. ONLY
4. RATING: 12mA @24V
5. FIXED CONTACT/MOVING CONTACT: COPPER ALLOY W/GOLD PLATE
6. CONTACT BOUNCE: <5m SEC.
7. CONTACT RESISTANCE: <50milli-OHMS
8. TRAVEL: 2.5±0.2mm
9. OPERATING TEMP. RANGE: -20°C to +80°C

**E-SWITCH®**

REV.	ECN No.	DESCRIPTION	DATE	CHKD
A	13569	RELEASED FOR PRODUCTION	11/3/03	AR

THE INFORMATION CONTAINED IN THIS DOCUMENT IS PROPRIETARY TO E-SWITCH AND IS NOT TO BE COPIED OR TRANSFERRED

TITLE				
5501-M-1-3 ,3				
SCALE	DATE	DR	DWG	REV
1.5:1	11/3/03	AR	XR0178P	A