

Excellent Integrated System Limited

Stocking Distributor

Click to view price, real time Inventory, Delivery & Lifecycle Information:

[E-Switch](#)
[5511MGRNX](#)

For any questions, you can email us directly:

sales@integrated-circuit.com

SHEET 1 OF 1

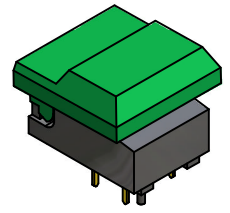

ISOMETRIC

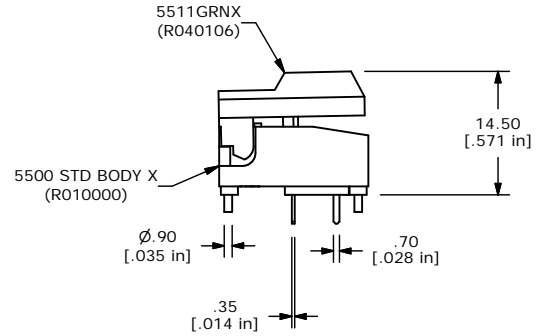
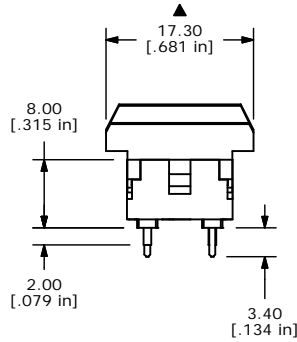
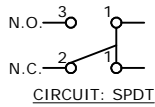
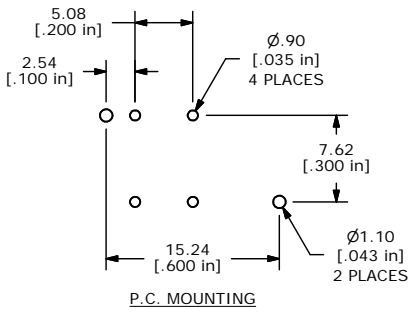

- NOTE:
1. ALL DIMENSIONS IN MM [INCH]
 2. GENERAL TOLERANCE: X.X=±0.4
X.XX=±0.25
 3. TERMINAL NUMBERS FOR REF ONLY
 4. RATINGS: 12mA @24V
 5. CONTACTS: FIXED AND MOVING:
COPPER ALLOY W/GOLD PLATE
 6. CONTINUOUS CURRENT RATING 120mA
 7. POWER RATING: 240mW
 8. OPERATING FORCE: <200GF
 9. OPERATING TRAVEL: 2.5MM ± 0.2MM
 10. ▲ DENOTES CRITICAL PARAMETER.

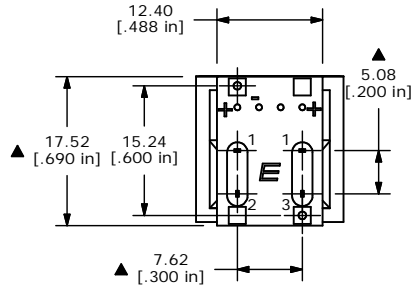

| | | | | |
|-----|--------|-------------------------|---------|----|
| A | 14640 | RELEASED FOR PRODUCTION | 1/28/05 | AR |
| REV | PCR NO | DESCRIPTION | DATE | BY |

| | | | | |
|-----------------|--------------|-------|-------------|-------|
| TITLE 5511MGRNX | | | | |
| SCALE 1.5:1 | DATE 1/28/05 | DR AR | DWG XR0239P | REV A |

THE INFORMATION CONTAINED IN THIS DOCUMENT IS PROPRIETARY TO E-SWITCH AND IS NOT TO BE COPIED OR TRANSFERRED