

## Excellent Integrated System Limited

Stocking Distributor

Click to view price, real time Inventory, Delivery & Lifecycle Information:

[E-Switch](#)  
[600DP3S2M4QE](#)

For any questions, you can email us directly:

[sales@integrated-circuit.com](mailto:sales@integrated-circuit.com)

SHEET 1 OF 1

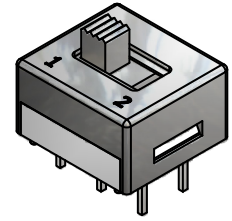
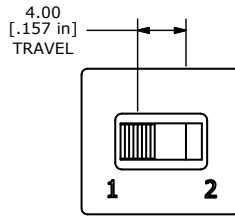
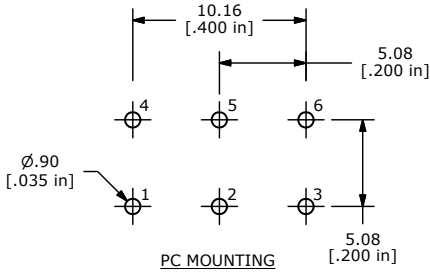

ISOMETRIC

SWITCH FUNCTION		
POS. 1	POS. 2	POS. 3
ON	OFF	ON
2-1,5-4	OPEN	2-3,5-6

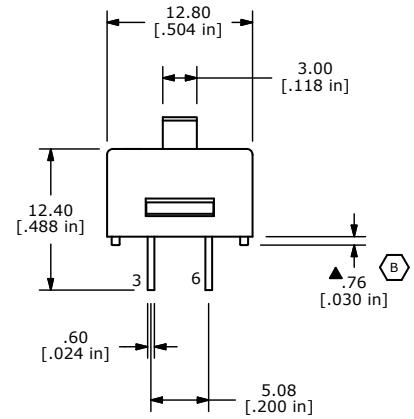
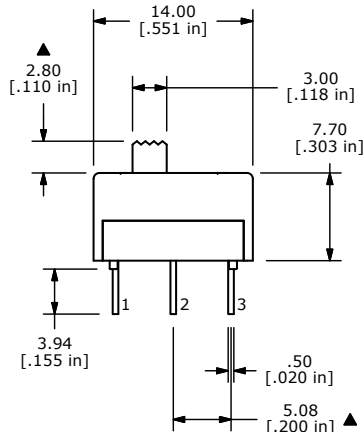
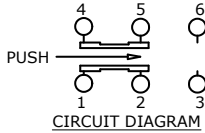

- NOTE:
1. ALL DIMENSIONS IN MM [INCH]
  2. GENERAL TOLERANCE: X.X=±0.4 X.XX=±0.25
  3. TERMINAL NUMBERS FOR REF ONLY
  - ▲ 4. PLATING MATERIAL: SILVER
  5. RATING: 1A @ 250VAC  
3A @ 120VAC OR 28VDC
  6. ELECTRIC LIFE: 20,000 ACTUATIONS AT FULL LOAD.
  7. CONTACT RESISTANCE: 50mΩ MAX. INITIAL
  8. INSULATION RESISTANCE: 1,000 MΩ MIN.
  9. DIELECTRIC STRENGTH: 1,000 V RMS @SEA LEVEL.
  10. OPERATING TEMP.: -40°C to 80°C
  11. ▲ DENOTES CRITICAL PARAMETER.
  12. 2002/95/EC (ROHS) COMPLIANT

C	20454	REMOVE (E) FROM DRAWING TITLE	2/7/12	BGL
B	18691	ADJUST DIM FOR LENGTH OF FEET	10/23/09	BLR
A	16730	RELEASED FOR PRODUCTION	12/6/06	TN
REV	PCR NO	DESCRIPTION	DATE	BY

TITLE 600DP3S2M4Q				
SCALE	DATE	DR	DWG	REV
2:1	10/23/2009	BLR	T620305	C

THE INFORMATION CONTAINED IN THIS DOCUMENT IS PROPRIETARY TO E-SWITCH AND IS NOT TO BE COPIED OR TRANSFERRED