

Excellent Integrated System Limited

Stocking Distributor

Click to view price, real time Inventory, Delivery & Lifecycle Information:

[E-Switch](#)
[D16EES12BGRN](#)

For any questions, you can email us directly:

sales@integrated-circuit.com

SHEET 1 OF 1

PARTS LIST			
ITEM	QTY	PART NUMBER	DESCRIPTION
1	1	F040020	D16EES12
2	1	F050302	50-003-02 LENS, SQUARE, CONCAVE, GREEN
3	1	F050404	50-004-04 LAMP, INCANDESCENT, 14V AC/DC, 80mA

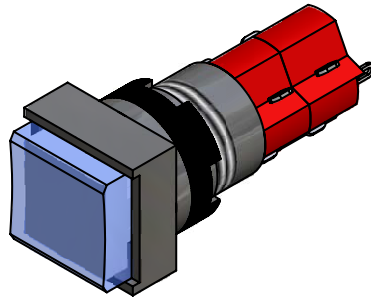
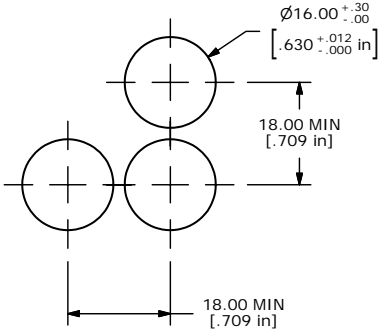

PANEL MOUNTING

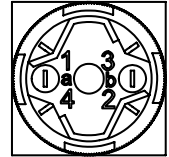
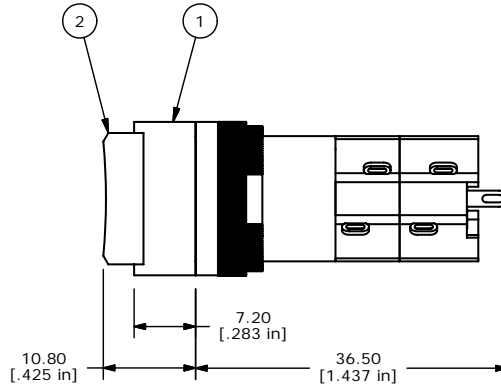
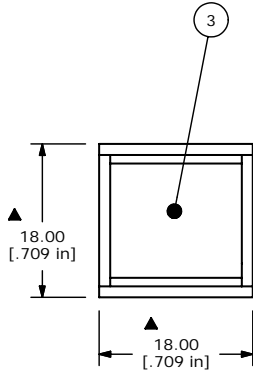
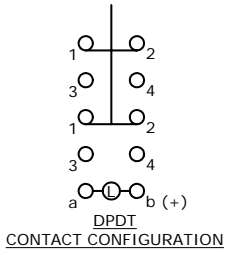

- NOTE:
1. ALL DIMENSIONS IN MM [INCH].
 2. GENERAL TOLERANCE: X.X=±0.4
X.XX=±0.25
 3. TERMINAL NUMBERS FOR REF ONLY.
 4. RATING: 5A @ 250VAC
6A @ 24VDC
 5. ELECTRICAL LIFE: 50,000 OPERATIONS
 6. INSULATION RESISTANCE: 1,000 MEGA-OHM MIN.
 7. OPERATING TEMP.: -25°C to +55°C
 - ▲ 8. LAMP VOLTAGE: 14V AC/DC INCANDESCENT
 9. ▲ DENOTES CRITICAL PARAMETER.



A	15944	RELEASED FOR PRODUCTION	4/13/06	BK
REV	PCR NO	DESCRIPTION	DATE	BY

TITLE D16EES12BGRN				
SCALE 1.5:1	DATE 04/13/06	DR BK	DWG XF0673P	REV A

THE INFORMATION CONTAINED IN THIS DOCUMENT IS PROPRIETARY TO E-SWITCH AND IS NOT TO BE COPIED OR TRANSFERRED