

Excellent Integrated System Limited

Stocking Distributor

Click to view price, real time Inventory, Delivery & Lifecycle Information:

[E-Switch](#)
[KO129AA126](#)

For any questions, you can email us directly:
sales@integrated-circuit.com

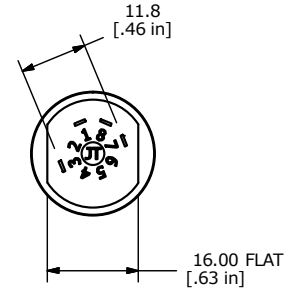
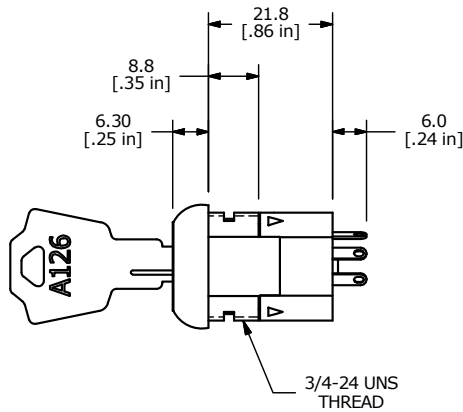
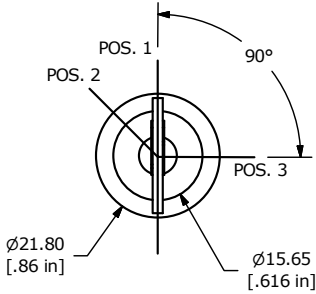
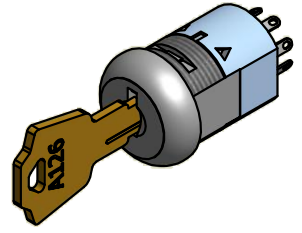

- NOTES:
1. ALL DIMENSIONS IN MM [INCH]
 2. GENERAL TOLERANCE: X.X = ±0.4
X.XX = ±0.25
 3. TERM. NOS. FOR REF. ONLY
 4. CONTACT RATING: 4A @125VAC/28VDC, 2A @250VAC
 5. DIELECTRI STRENGTH: 1KV RMS min. AT SEA LEVEL
 6. ELECTRICAL LIFE: 10,000 MAKE-AND-BREAK CYCLES AT FULL LOAD.
 7. KEYCODE: A126

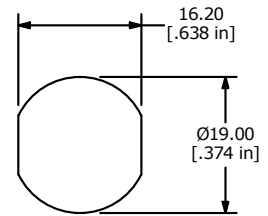
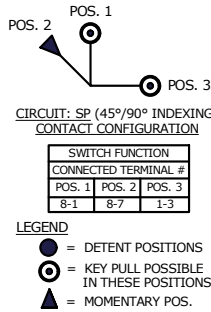

RECOMENDED PANEL CUTOUT

D	21924	UPDATED AND REDRAWN IN INVENTOR	7/22/15	MW
C	19509	CHANGED THREAD DESCRIPTION	12/9/10	BGL
B	11566	REVISED	7/13/01	CJB
REV	PCR NO	DESCRIPTION	DATE	BY



TITLE KO129AA126

THE INFORMATION CONTAINED IN THIS DOCUMENT IS PROPRIETARY TO E-SWITCH AND IS NOT TO BE COPIED OR TRANSFERRED

SCALE	1:1	DATE	7/21/2015	DR	AS	DWG	K200207	REV	D
-------	-----	------	-----------	----	----	-----	---------	-----	---