

## Excellent Integrated System Limited

Stocking Distributor

Click to view price, real time Inventory, Delivery & Lifecycle Information:

[E-Switch](#)  
[L16PLT10HGRNGRN](#)

For any questions, you can email us directly:  
[sales@integrated-circuit.com](mailto:sales@integrated-circuit.com)

SHEET 1 OF 1

PARTS LIST			DESCRIPTION
ITEM	QTY	PART NUMBER	
1	1	F040001	L16PLT10
2	1	F050202	50-002-02 RECTANGULAR CONCAVE GREEN LENS
3	1	F050416	50-004-16 6V GREEN LED

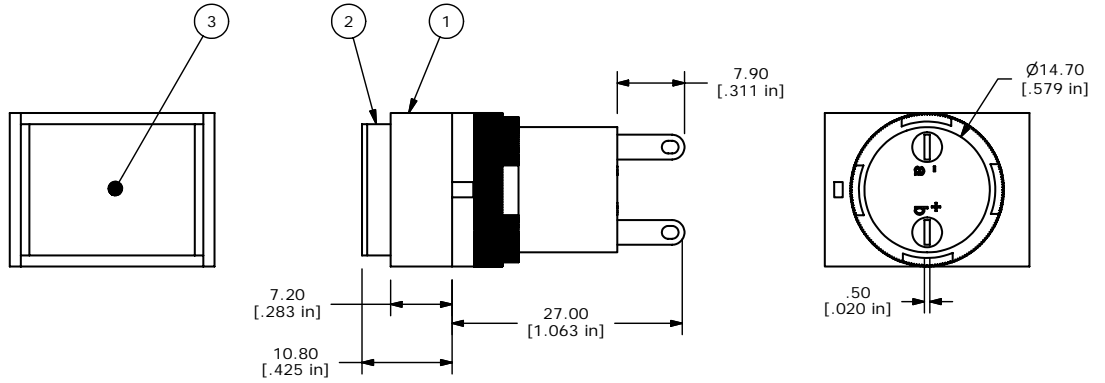
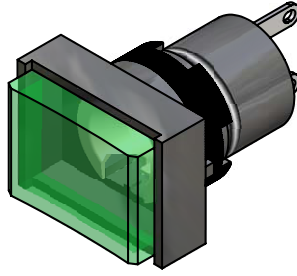
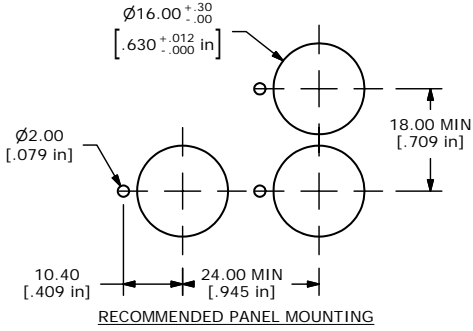

- NOTE:
1. ALL DIMENSIONS IN MM [INCH]
  2. GENERAL TOLERANCE: X.X=±0.4  
X.XX=±0.25
  3. TERMINAL NUMBERS FOR REF ONLY
  4. OPERATING TEMP: -25°C to +55°C
  5. STORAGE TEMP: -40°C TO +85°C
  6. LAMP VOLTAGE: 6VDC LED
  7. ▲ DENOTES CRITICAL PARAMETER.
  8. 2002/95/EC (ROHS) COMPLIANT



TITLE L16PLT10HGRNGRN				
SCALE 1.5:1	DATE 6/15/2006	DR CT	DWG XF0679P	REV A

A	16147	RELEASED FOR PRODUCTION	6/15/06	CT
REV	PCR NO	DESCRIPTION	DATE	BY

THE INFORMATION CONTAINED IN THIS DOCUMENT IS PROPRIETARY TO E-SWITCH AND IS NOT TO BE COPIED OR TRANSFERRED