

Excellent Integrated System Limited

Stocking Distributor

Click to view price, real time Inventory, Delivery & Lifecycle Information:

[E-Switch](#)
[LAKEEV11KGRNGRN](#)

For any questions, you can email us directly:
sales@integrated-circuit.com

SHEET 1 OF 1

Parts List			
ITEM	QTY	PART NUMBER	DESCRIPTION
1	1	F060619	LAKEEV11
2	1	F051601	P16 PLASTIC TERM. PROTECTOR
3	1	F050422	24VDC GREEN LED
4	1	F051702	25MM RING
5	1	F060202	25MM GREEN LENS

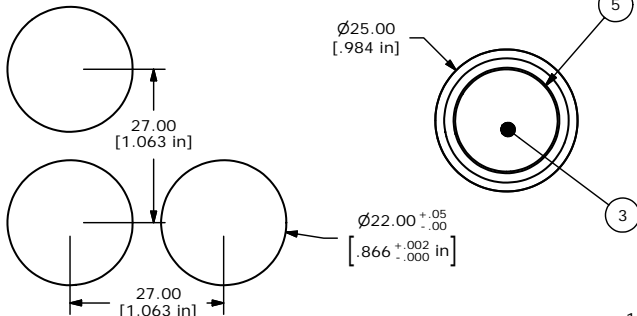

RECOMMEND PANEL MOUNTING

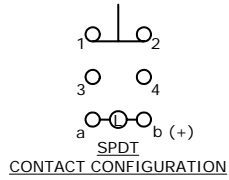

CONTACT CONFIGURATION

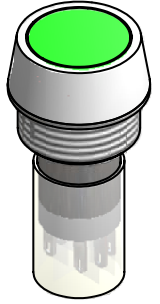
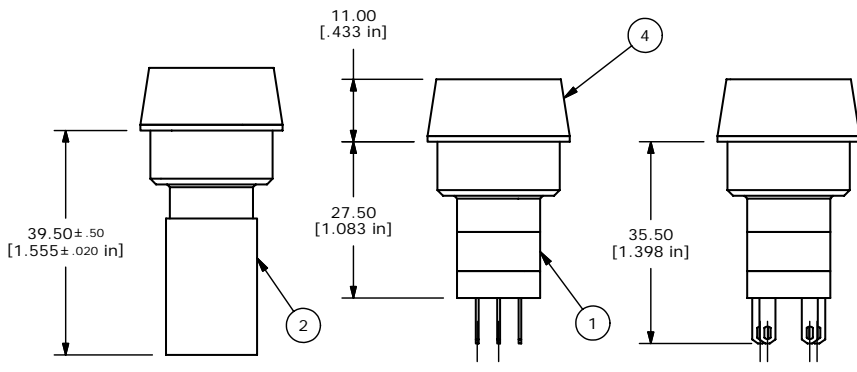

ISOMETRIC

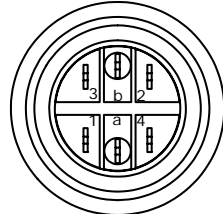

- NOTES:
1. ALL DIMENSIONS IN MM [INCH].
 2. GENERAL TOLERANCE: 0.0±0.4
 3. TERM. NOS. FOR REF. ONLY.
 - ▲4. RATING: 5A @250VAC
8A @125VAC
.2A @250VDC
6A @24VDC
 5. MECHANICAL LIFE: 2,000,000 MAKE-OR-BREAK CYCLES
 6. INSULATION: 1,000 MΩ MIN.
 7. DIELECTRIC STRENGTH: 2000V FOR 1 MIN
 8. OPERATING TEMP: -25°C TO 55°C
 - ▲9. LENS COLOR: GREEN
 - ▲10. LAMP VOLTAGE: 24VDC LED
 - ▲11. PACKAGE: BOX/20 PER BOX
 12. 2002/95/EC (ROHS) COMPLIANT
 13. ▲DENOTES MAJOR DIMENSION.



TITLE LAKEEV11KGRNGRN				
SCALE 1:1	DATE 1/22/2007	DR TN	DWG XF0707P	REV A

A	16899	RELEASED FOR PRODUCTION	1/22/2007	TN
REV	PCR NO	DESCRIPTION	DATE	BY

THE INFORMATION CONTAINED IN THIS DOCUMENT IS PROPRIETARY TO E-SWITCH AND IS NOT TO BE COPIED OR TRANSFERRED