

Excellent Integrated System Limited

Stocking Distributor

Click to view price, real time Inventory, Delivery & Lifecycle Information:

[E-Switch](#)
[R1966ABLKBLKIR](#)

For any questions, you can email us directly:
sales@integrated-circuit.com

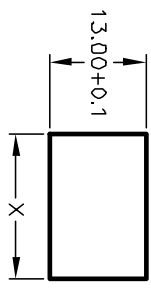
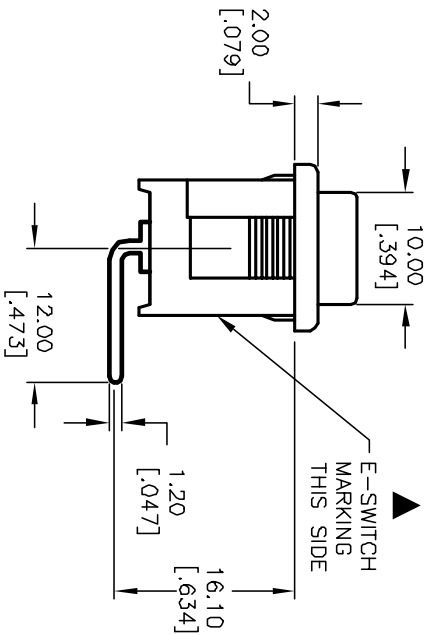
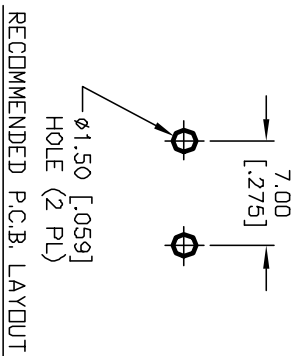
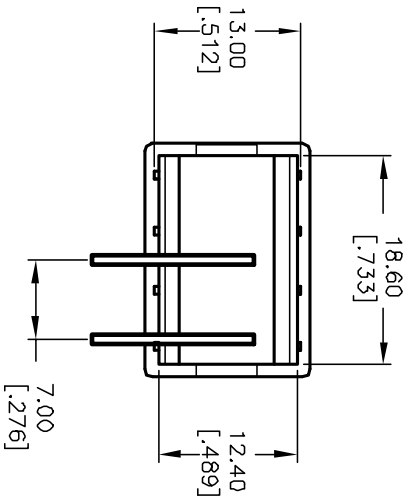
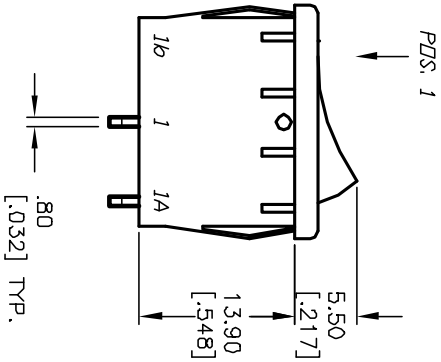
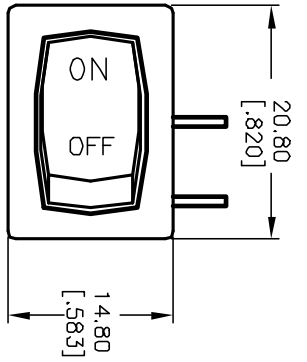

PANEL THICKNESS	X dimension
0.75-1.25 [0.30-0.49]	19.2-0.1 [0.756]
1.25-2.0 [0.49-0.79]	19.4-0.1 [0.764]
2.0-3.0 [0.79-1.18]	19.8-0.1 [0.780]

SWITCH FUNCTION	
POS. 1	POS. 2
DN	OFF
1-1a	OPEN

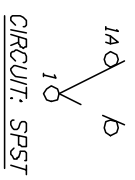

- NOTES:
1. ALL DIMENSIONS IN MM [INCH]
 2. GENERAL TOLERANCE: X.X=±0.4 X.XX=±0.25
 3. TERMINAL NUMBERS FOR REF ONLY
 4. RATING: 15A @ 125VAC OR 6A @ 250VAC
 5. APPROVALS: (UL, CSA, VDE, NEMKO, SEMKO, FIMKO, DEMKO)
 6. MATERIALS: TERMINALS: Silver Plated Copper Alloy CONTACTS: Coin Silver, Silver Plated
 7. ELECTRICAL LIFE: 10,000 cycles
 8. CONTACT RESISTANCE: <20 Mega Ω
 9. INSULATION RESISTANCE: >1000 Mega Ω
 10. DIELECTRIC STRENGTH: >1500 V 1 minute >3000 V between poles

REV.	ECN No.	REVISED PART DESCRIPTION	DATE	CHKD
B	11664	REVISION DESCRIPTION	9/19/01	CJB

TITLE	SCALE	DATE	DR	DWG	REV
R1966A BLK BLK IR	1.5:1	1/26/98	MM	M301200	B

E-SWITCH®

THE INFORMATION CONTAINED IN THIS DOCUMENT IS PROPRIETARY TO E-SWITCH AND IS NOT TO BE COPIED OR TRANSMITTED