

Excellent Integrated System Limited

Stocking Distributor

Click to view price, real time Inventory, Delivery & Lifecycle Information:

[E-Switch](#)
[R1966CBLKBLKFR](#)

For any questions, you can email us directly:

sales@integrated-circuit.com

SHEET OF

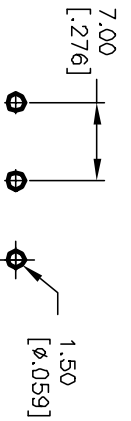
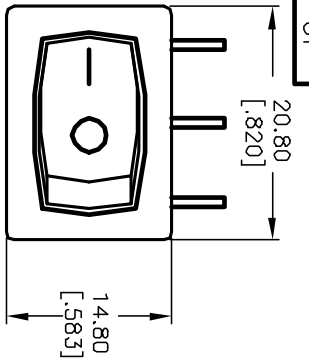

RECOMMENDED P.C.B. LAYOUT

| PANEL THICKNESS | X dimension |
|-----------------------|-----------------|
| 0.75-1.25 [0.30-0.49] | 19.2-21 [0.756] |
| 1.25-2.0 [0.49-0.79] | 19.4-21 [0.764] |
| 2.0-3.0 [0.79-1.18] | 19.8-21 [0.780] |

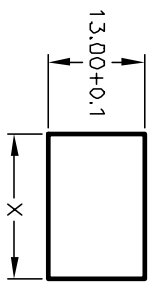

PANEL CUTOUT NOT TO SCALE

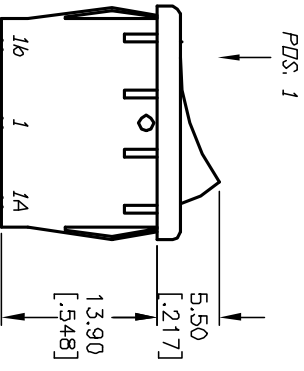

POS. 1

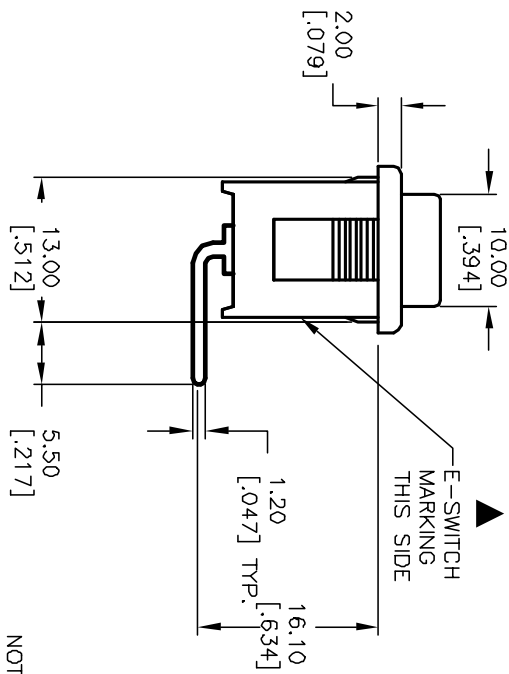
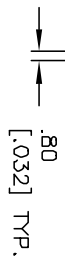

E-SWITCH MARKING THIS SIDE

| SWITCH FUNCTION | |
|-----------------|--------|
| POS. 1 | POS. 2 |
| DN | DN |
| 1-1a | 1-1b |

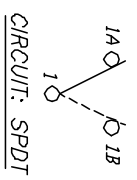

CIRCUIT: SPDT

NOTES:

1. ALL DIMENSIONS IN MM [INCH]
2. GENERAL TOLERANCE: X.X=±0.4 X:XX=±0.25
3. TERMINAL NOS. FOR REF ONLY.
4. RATING: 15A @ 125VAC OR 6A @ 250VAC
5. MATERIALS: TERMINALS: Silver Plated Copper Alloy CONTACTS: Coin Silver, Silver Plated
6. ELECTRIC LIFE: 10,000 cycles
7. CONTACT RESISTANCE: <20 Mega-OHMS
8. INSULATION RESISTANCE: >1000 Mega-OHMS
9. DIELECTRIC STRENGTH: >1500 V 1 minute >3000 V between poles

E-SWITCH®

R1966C BLK BLK FR

| REV. | ECN No. | DESCRIPTION | DATE | CHKD |
|------|---------|---------------------|---------|------|
| B | 11510 | REVISED AND REDRAWN | 1/30/02 | CB |

| TITLE | SCALE | DATE | DR | DWG | REV |
|-------------------|-------|---------|----|---------|-----|
| R1966C BLK BLK FR | 1.5:1 | 5/25/01 | CB | M302202 | B |

THE INFORMATION CONTAINED IN THIS DOCUMENT IS PROPRIETARY TO E-SWITCH AND IS NOT TO BE COPIED OR TRANSMITTED