

Excellent Integrated System Limited

Stocking Distributor

Click to view price, real time Inventory, Delivery & Lifecycle Information:

[E-Switch](#)
[R6ABLKREDF](#)

For any questions, you can email us directly:
sales@integrated-circuit.com

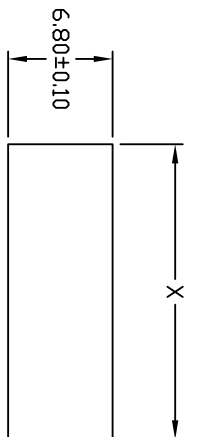
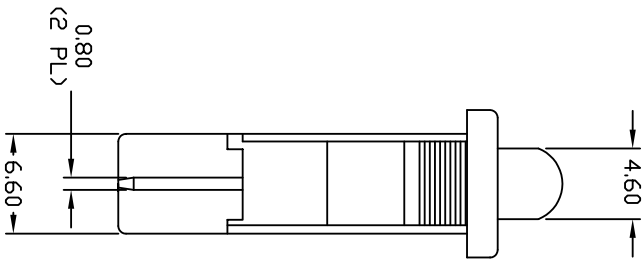
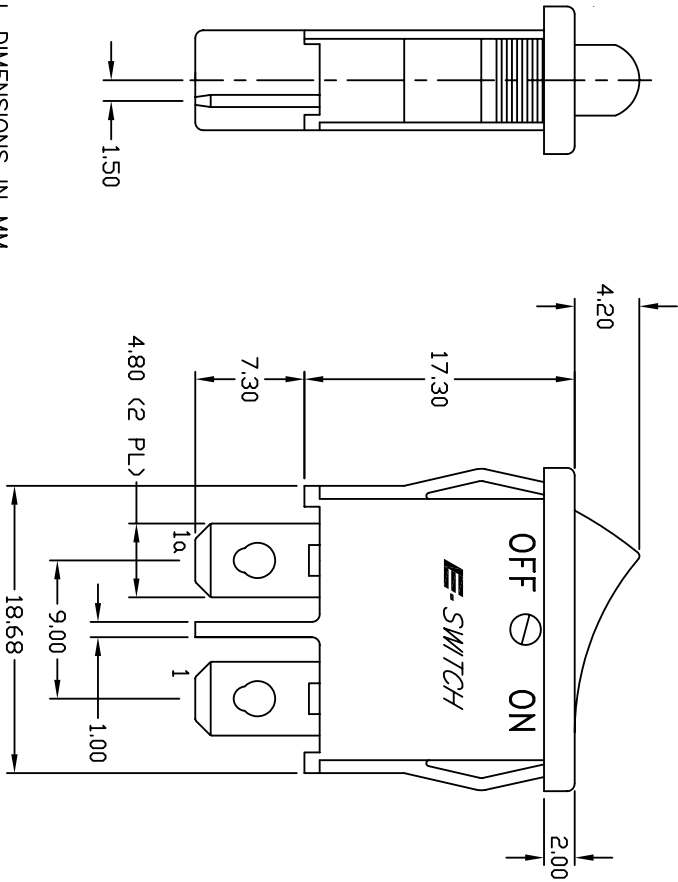
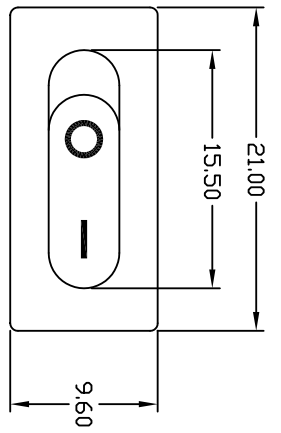

PANEL CUTOUT

PANEL THICKNESS	X
0.75-1.25	19.20
1.25-2.0	19.40
2.00-3.00	19.60

SWITCH FUNCTION	
PQS. 1	PQS. 2
DN	OFF
1-1a	OPEN

CONTACT CONFIGURATION



CIRCUIT: SPST

NOTES:

1. ALL DIMENSIONS IN MM
2. GENERAL TOLERANCE: 0.0=±0.4; 0.00=±0.25
3. TERMINAL NUMBERS FOR REF ONLY
4. RATING: 4(1)A 250VAC, 10A 125VAC, 6A 250VAC
5. MECHANICAL LIFE: OVER 30,000 CYCLES
6. ELECTRICAL LIFE: OVER 10,000 CYCLES
7. CONTACT RESISTANCE: < 20 MEGA-OHMS (INITIAL)
8. INSULATION RESISTANCE: > 1000 MEGA-OHMS @ 500VDC
9. DIELECTRIC STRENGTH: >1500VAC 1 MINUTE (INITIAL)
>3000V BETWEEN POLES
10. 2002/95/EC (ROHS) COMPLIANT

E-SWITCH

R6ABLKREDF

TITLE

SCALE

DATE

DR

DWG

REV

THE INFORMATION CONTAINED IN THIS DOCUMENT IS PROPRIETARY TO E-SWITCH AND IS NOT TO BE COPIED OR TRANSFERRED

REV.	ECN No.	DESCRIPTION	DATE	CHKD
C	16949	17.6 DIM CHANGED TO 17.3	1/31/07	TN
B	16940	UPDATE NOTES, FIXED 17.6 DIM	1/30/07	TN
A	10793	RELEASED FOR PRODUCTION	8/2/00	GLG

2:1

1/31/07

TN

M060305

C