



## **Excellent Integrated System Limited**

Stocking Distributor

Click to view price, real time Inventory, Delivery & Lifecycle Information:

[TE Connectivity AMP Connectors](#)  
[3-643347-2](#)

For any questions, you can email us directly:

[sales@integrated-circuit.com](mailto:sales@integrated-circuit.com)

1

2

3

4

THIS DRAWING IS UNPUBLISHED. RELEASED FOR PUBLICATION BY TYCO ELECTRONICS CORPORATION. ALL RIGHTS RESERVED. © COPYRIGHT

LOC	DIST	P	UNK	F	REVISED PER ECO-07-003757	DATE	DRN	APRO
CM	00					01MAR07	KW	DB

REVISIONS	
DESCRIPTION	DATE

- 1 MATERIAL: CONNECTOR - NYLON UL94V-2 (WHITE).  
CONTACTS - 0.30[.012] THICK COPPER ALLOY MATTE WHISKER MITIGATED TIN  
0.00203[.000080] MIN THICKNESS OVER NICKEL UNDERPLATE OR BRIGHT TIN-LEAD 93/7 0.00203[.000080] MIN THICKNESS. SEE FINISH COLUMN FOR PLATING TYPE.
2. CONTACTS ACCEPT 24 AWG WIRE WITH 1.52[.060] MAX INSULATION DIAMETER.
3. CONTACTS MUST ACCEPT 0.36-0.51[.014-.020] SQUARE OR ROUND POST AND REMAIN LOCKED IN POSITION.
- 4 IDENTIFICATION NUMBER FOR LAST CIRCUIT MAY NOT APPEAR ON ALL ASSEMBLIES.
5. DIMENSIONS IN BRACKETS ARE IN INCHES.
6. HOUSING FEATURES ARE: CLOSED END WITH LOCKING RAMP & LED CONTACT.

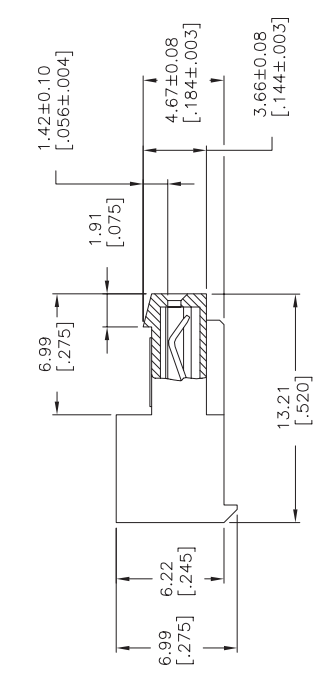
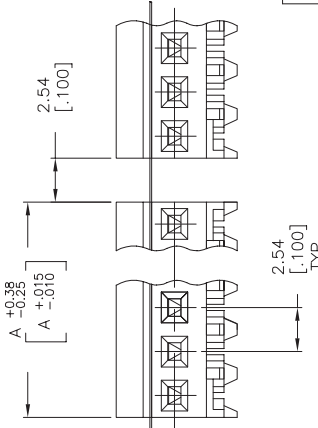
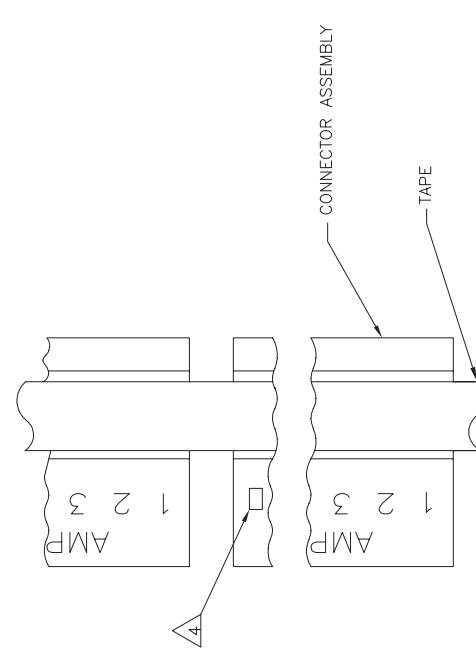

TIN	7.62 [.300]	3	3-643347-3
TIN-LEAD	5.08 [.200]	2	3-643347-2
FINISH	5.08 [.200]	2	643347-2
	DIM A	NO OF	PART NO
		CIRCUITS	

THIS DRAWING IS A CONTROLLED DOCUMENT.		DRN	LEWIS	22 APR 91
DIMENSIONS: mm (INCHES)		CHK	SWING	22 APR 91
TOLERANCES UNLESS OTHERWISE SPECIFIED:		APP	G. MILLER	
0 P.L.C.	±	PRODUCT SPEC		
1 P.L.C.	±	APPLICATION SPEC		
2 P.L.C.	±	WEIGHT		
3 P.L.C.	±			
4 P.L.C.	±			
5 P.L.C.	±			
FINISH				

TYCO Electronics Corporation  
Harrisburg, Pa 17105-3608

MTA-100 CONNECTOR ASSEMBLY,  
24 AWG.FOR .014 TO .020 POST,  
TAPE MOUNTED,SPECIAL

RESTRICTED TO

SIZE GAGE CODE DRAWING NO  
A2|00779|C=643347

SCALE 5:1 SHEET 1 OF 1 REV F

CUSTOMER DRAWING