

Excellent Integrated System Limited

Stocking Distributor

Click to view price, real time Inventory, Delivery & Lifecycle Information:

[TE Connectivity AMP Connectors](#)
[1053467-1](#)

For any questions, you can email us directly:

sales@integrated-circuit.com

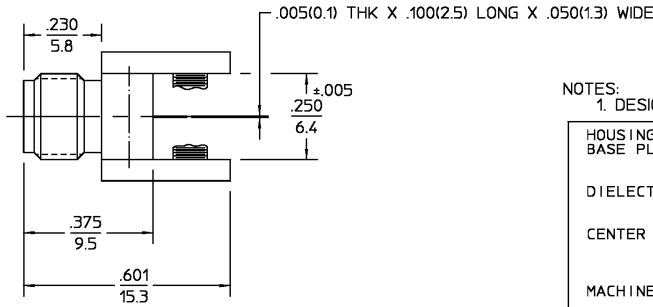
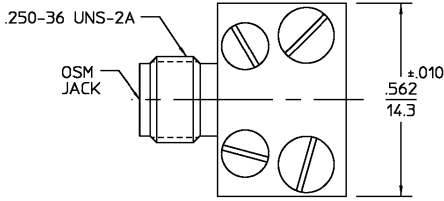

REVISIONS			DATE	APPROVED
REV	DESCRIPTION			
03	REVISED		08/14/75	[Signature]

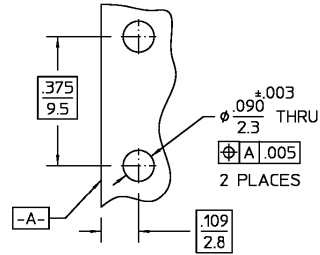

MOUNTING HOLE PATTERN

NOTES:
 1. DESIGNED FOR USE WITH 1/4" THICK STRIPLINE

.XXX = in
 XX.X = mm (REF)

HOUSING BASE PLATES	STAINLESS STEEL PER ASTM-A484 AND ASTM- A582, TYPE 303	PASSIVATE PER QQ-P-35
DIELECTRIC	TFE FLUOROCARBON PER ASTM-D-1457	N/A
CENTER CONTACT	BERYLLIUM COPPER PER ASTM-B-196 OR ASTM-B-197, ALLOY C17300, CONDITION H	GOLD PLATE PER MIL-G-45204
MACHINE SCREWS	CORROSION RESISTANT STEEL PER QQ-S-763	PASSIVATE PER QQ-P-35

COMPONENT	MATERIAL	FINISH								
UNLESS OTHERWISE SPECIFIED DIMENSIONS ARE IN MILLIMETERS	DRAWN BY: RFF DATE: 8/14/75	AMP Incorporated 140 Fourth Avenue Waltham, MA 02451-7599								
TOLERANCE ON FRAC. DEC. ANGLES + .164 +.25 + .1°	CHECKED BY: BWC DATE: 8/14/75	<table border="1"> <tr> <td>SIZE</td> <td>CODE IDENT NO.</td> <td>2070-5069-02</td> <td>REV</td> </tr> <tr> <td>B</td> <td>26805</td> <td></td> <td>03</td> </tr> </table>	SIZE	CODE IDENT NO.	2070-5069-02	REV	B	26805		03
SIZE	CODE IDENT NO.		2070-5069-02	REV						
B	26805		03							
These drawings and specifications are the property of M/A-COM Incorporated and shall not be reproduced or copied or used in whole or in part on the basis for the manufacture or sale of items without written permission.	APPROVED BY: BWC DATE: 8/14/75									
	USE ASSY PROCEDURE NO. AP. N/A	TITLE OSM STRAIGHT END LAUNCH JACK								

CUSTOMER DRAWING

AMP PART # 1053467-1
 SHEET 1 OF 1 REV A