



Excellent Integrated System Limited

Stocking Distributor

Click to view price, real time Inventory, Delivery & Lifecycle Information:

[Amphenol Commercial Products](#)

[SATA01120172](#)

For any questions, you can email us directly:

sales@integrated-circuit.com

This document is the property of Excellent Integrated System Ltd. It is intended for use only for the production of goods for specific orders. It is not to be used for any other purpose. It is not to be used for any other purpose. It is not to be used for any other purpose. It is not to be used for any other purpose.

REVISIONS				
SYM	CON	DESCRIPTION	DATE	APPROVED
A	HK000X	INITIAL RELEASE	4/15/05	Michael IP

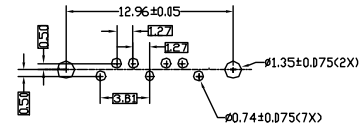
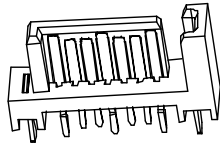
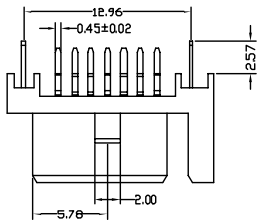

RECOMMENDED PCB LAYOUT
(PCB THICKNESS 1.6mm OR 2.0mm)

NOTE:

- MATERIAL:**
HOUSING: FR-6145, UL 94 V-0, BLACK;
CONTACTS: COPPER ALLOY T=0.25mm;
CONTACT FINISHED: 1.27-2.54um, NICKEL UNDER PLATED ON ENTIRE CONTACT;
SEE NOTES 4 FOR GOLD PLATING ON MATING AREA;
2.54-5.08um MATTE TIN PLATED ON TAIL AREA;
SOLDER TAB: BRASS, t=0.25;
SOLDER TAB FINISHED: 2.54-5.05um TIN OVER 1.27um MIN. NICKEL;
- SPECIFICATIONS:**
RATED CURRENT: SIGNAL PIN 1.5A MIN
POWER PIN 1.5A MIN
DIELECTRIC STRENGTH: 1000V FOR 1 MINUTE
INSULATION RESISTANCE: 1x10⁵ M.Ω
TEMPERATURE: -40°C TO +105°C
CONTACT RESISTANCE: 30mΩ MAX
PIN RETENTION FORCE: 10N MIN. TOTAL (2.25 LB)
- PACKAGE: PACKING WITH TRAY.**
- ORDERING INFORMATION:**
SATA - 011 - 2017 - X

GOLD PLATING ON MATING AREA:
1: 0.76 um MIN.
2: 0.38 um MIN.
3: GOLD FLASH

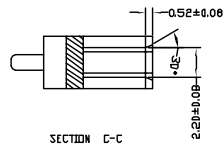
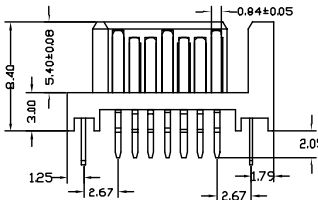
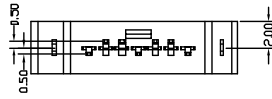
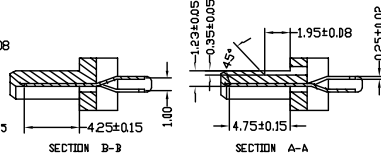
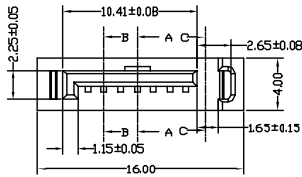

Customer Drawing

UNLESS OTHERWISE SPECIFIED TOLERANCES U.S. METRIC X +/- D.3 XX +/- 0.15 STRUCTURE ANGLES +/- Z	APPROVAL	DATE	Amphenol
	SEARCH: Tom Aring	4/15/05	
REMOVE SHARP EDGES	CHECKED: Michael IP	4/15/05	TITLE
DIMENSIONS	DRAWING FILE 1		SATA 7 PINS
(U.S. (METRIC))	ANGLE OF PROJECTION		SIZE DRAWING NO. A3C SATA-011-2017-X
			SCALE NONE SHEET 1 OF 1