

Excellent Integrated System Limited

Stocking Distributor

Click to view price, real time Inventory, Delivery & Lifecycle Information:

[Molex Connector Corporation](#)
[0714300009](#)

For any questions, you can email us directly:

sales@integrated-circuit.com

NOTES:

- MATERIALS:**
HOUSING: GLASS-FILLED LIQUID CRYSTAL POLYMER (LCP), UL94 V-0, COLOR: BLACK
TAIL ALIGNER: GLASS-FILLED LIQUID CRYSTAL POLYMER (LCP),
TERMINAL: PHOSPHOR BRONZE
BRACKET: BRASS
SHELL: STEEL
INSERT: BRASS
- FINISHES:**
TERMINAL: 0.05-0.25 MICROMETERS GOLD FLASH IN CRITICAL AREA
OVER 0.75 MICROMETERS MINIMUM PALLADIUM NICKEL IN
CRITICAL AREA, 1.87 MICROMETERS MINIMUM TIN IN
SOLDER TAIL AREA OVER A NICKEL UNDERPLATE.
SHIELD: 3.8 MICROMETERS MINIMUM BRIGHT TIN OVER NICKEL.
INSERT: 2.54 MICROMETERS MINIMUM NICKEL.
- PART CONFORMS TO MOLEX PRODUCT SPECIFICATION PS-71425-9999.
- PACKAGED PER PK-71430-0101.
- APPLICABLE STANDARDS: EIA-3652 AND SFF-8441.
- DATE CODE: YR/WK PER EIA-476-A.
- PRODUCT COMPLIES WITH COSMETIC SPECIFICATION PS-45499-002.
SEE SIDE VIEW FOR SURFACE CLASSIFICATIONS.
- TORQUE TO INSTALL SCREWLOCKS INTO THREADED INSERTS:
0.34 Nm MAXIMUM.

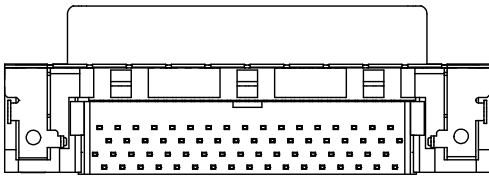
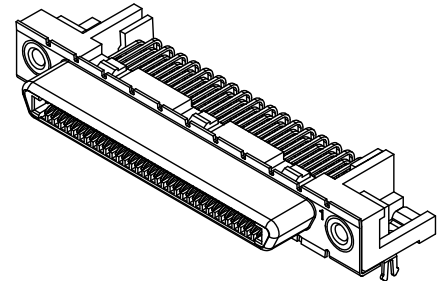
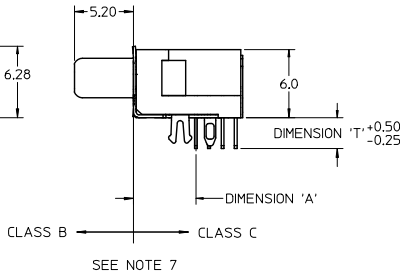
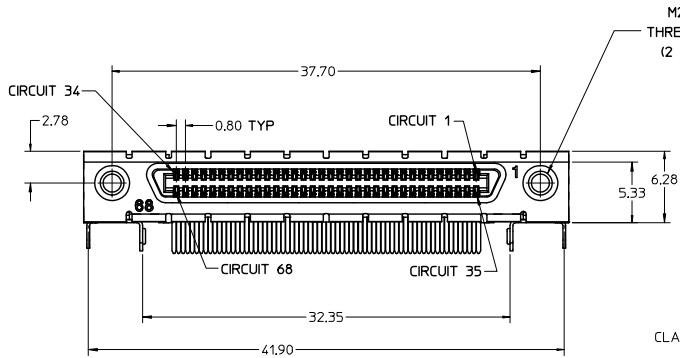
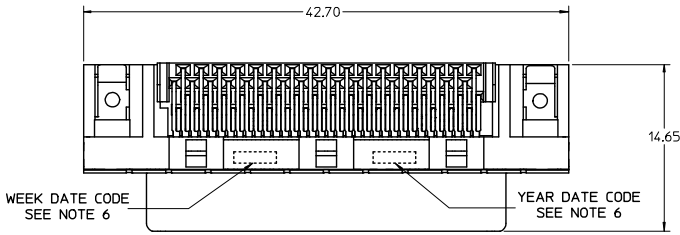

FIX TAIL TOLERANCE EC NO: UCP2012-3896 DRAWN BY: CHKORHOLPE APPROVED BY: APPRSMTLLER N	DESCRIPTION 2012/05/29 2012/08/31	QUALITY SYMBOLS ▽=0 ▽=0 ▽=0	GENERAL TOLERANCES (UNLESS SPECIFIED)		DIMENSION STYLE MM ONLY		SCALE 4:1	DESIGN UNITS METRIC	THIRD ANGLE PROJECTION
			mm	INCH	DRAWN BY KSTILES	DATE 11/14/2002	TITLE VHDCI RIGHT ANGLE ASSEMBLY		
			4 PLACES ±	±	CHECKED BY KSTILES	DATE 11/15/2002	molex		
			3 PLACES ±	±	APPROVED BY MBNAK1S	DATE 11/22/2002			
			2 PLACES ±	0.13	MATERIAL NO. SEE SHEET 2		DOCUMENT NO. SD-71430-015	SHEET NO. 1 OF 3	
			1 PLACE ±	0.25	DRAFT WHERE APPLICABLE MUST REMAIN WITHIN DIMENSIONS				
			0 PLACE ±	±	SIZE C THIS DRAWING CONTAINS INFORMATION THAT IS PROPRIETARY TO MOLEX INCORPORATED AND SHOULD NOT BE USED WITHOUT WRITTEN PERMISSION				

PCB THICKNESS	PART NUMBER	TAIL LENGTH 'T' (SEE FIGURE FOR TOLERANCE)	ENHANCED GROUND TABS	SCREWLOCKS	TAIL LOC. 'A'	HOLE LOCATION 'B'
1.60	71430-0101	2.08	NO	NONE	5.5	6.50 MAXIMUM
1.60	71430-0007	2.08	NO	LOOSE IN BAGS		
1.60	71430-0005	2.08	YES	NONE		
1.60	71430-0008	2.08	YES	LOOSE IN BAGS		
2.36	71430-0268	2.71	NO	NONE		
2.36	71430-0006	2.71	NO	INSTALLED		
2.36	71430-0004	2.71	YES	NONE		
2.36	71430-0009	2.71	YES	INSTALLED		
2.36	71430-0016	2.71	NO	LOOSE IN BAGS		
2.36	71430-0019	2.71	YES	LOOSE IN BAGS		
2.36	71430-0012	2.71	YES	NONE	5.3	6.30 MAXIMUM
1.60	71430-0013	2.08	YES	NONE		

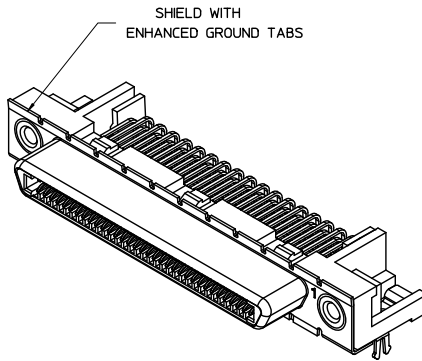
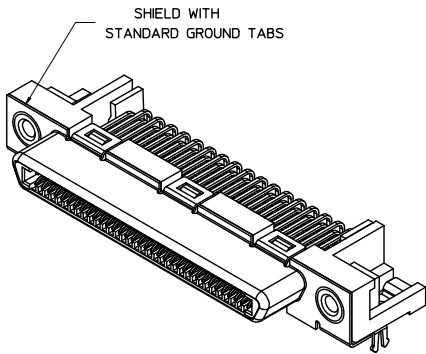

OPTIONAL SCREWLOCK
PART NUMBER 71433-0002

SEE SHEET 1 EC NO: UCP2012-3896 DRAWN BY: CHYKCHOLIFE APPR: SMILLER 2012/08/31	QUALITY SYMBOLS ∇=0 ∇=0 ∇=0	GENERAL TOLERANCES (UNLESS SPECIFIED)		DIMENSION STYLE		SCALE	DESIGN UNITS	THIRD ANGLE PROJECTION		
		mm	INCH	MM ONLY		4:1	METRIC	VHDCI RIGHT ANGLE ASSEMBLY		
		4 PLACES ± ---	± ---	DRAWN BY	DATE	molex SD-71430-015 SHEET NO. 2 OF 3				
		3 PLACES ± ---	± ---	KSTILES	11/14/2002					
2 PLACES ± 0.13	± ---	CHECKED BY	DATE	THIS DRAWING CONTAINS INFORMATION THAT IS PROPRIETARY TO MOLEX INCORPORATED AND SHOULD NOT BE USED WITHOUT WRITTEN PERMISSION						
1 PLACE ± 0.25	± ---	KSTILES	11/15/2002							
0 PLACE ±	±	APPROVED BY	DATE							
		MBNAKIS	11/22/2002							
ANGULAR ± 1/2°		MATERIAL NO.		DOCUMENT NO.						
DRAFT WHERE APPLICABLE MUST REMAIN WITHIN DIMENSIONS		SEE TABLE								

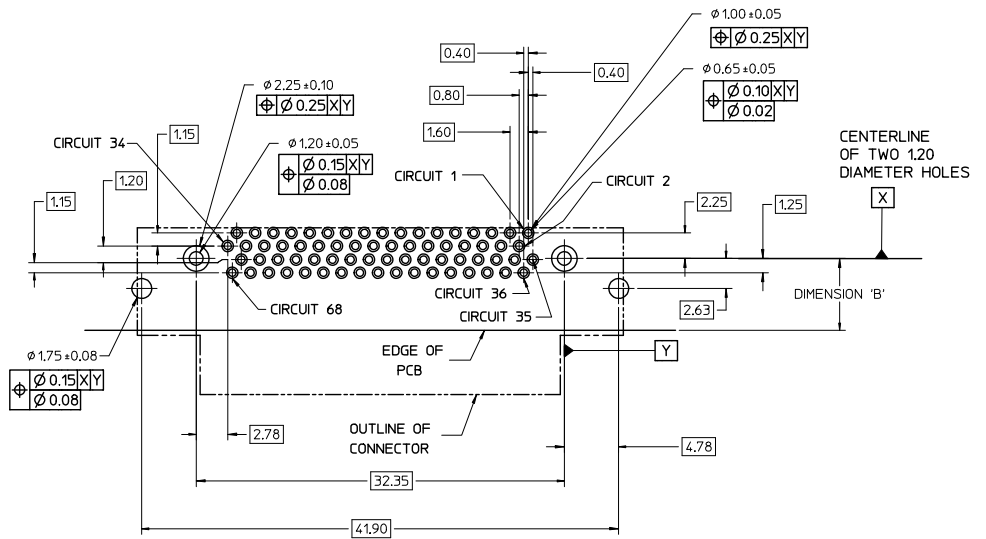

NOTES:

1. FOR FULL MATE WITH PLUG, PANEL THICKNESS SHOULD NOT EXCEED 1.0mm.

FUNCTIONAL MATING WITH MOLEX PLUG CAN STILL BE MAINTAINED WITH PANELS AS THICK AS 2.5mm (BUT PLUG AND RECEPTACLE WILL NOT BE FULLY MATED).

2. GUIDELINES FOR CHOOSING A MOLEX SCREWLOCK:

PANEL THICKNESS	RECOMMENDED SCREWLOCK
LESS THAN OR EQUAL TO 1.00 MM	71433-0002
1.01 TO 2.15 MM	71433-0010

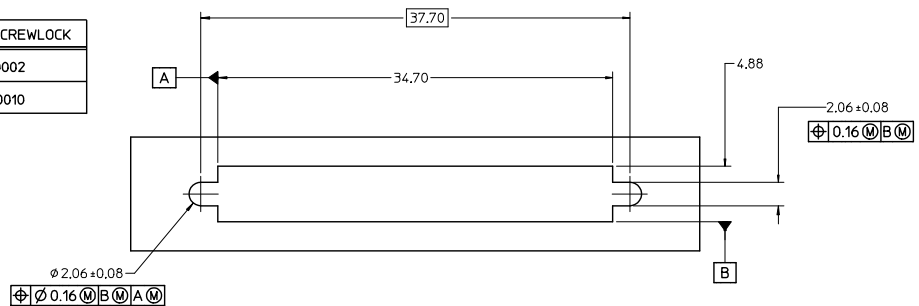

SEE SHEET 1 EC NO: UCF2012-3896 DRAWN BY: CHYKORWOLFE APPR: SMILLER DATE: 2012/08/31 DESCRIPTION:	QUALITY SYMBOLS	GENERAL TOLERANCES (UNLESS SPECIFIED)	DIMENSION STYLE	SCALE	DESIGN UNITS	THIRD ANGLE PROJECTION
	∇=0 ∇=0 ∇=0	4 PLACES ± --- ± --- 3 PLACES ± --- ± --- 2 PLACES ± 0.13 ± --- 1 PLACE ± 0.25 ± --- 0 PLACE ± ±	MM ONLY	4:1	METRIC	TITLE: VHDCI RIGHT ANGLE ASSEMBLY molex DOCUMENT NO. SD-71430-015 SHEET NO. 3 OF 3
	ANGULAR ±1/2° DRAFT WHERE APPLICABLE MUST REMAIN WITHIN DIMENSIONS	DRAWN BY: KSTILES DATE: 11/14/2002 CHECKED BY: KSTILES DATE: 11/15/2002 APPROVED BY: MBNAKIS DATE: 11/22/2002	MATERIAL NO. SEE SHEET 2			
	SIZE: C THIS DRAWING CONTAINS INFORMATION THAT IS PROPRIETARY TO MOLEX INCORPORATED AND SHOULD NOT BE USED WITHOUT WRITTEN PERMISSION					

NOTES:

1. MATERIALS:

- HOUSING: GLASS FILLED LIQUID CRYSTAL POLYMER (LCP), UL94 V-0, COLOR:BLACK
- TAIL ALIGNER: GLASS FILLED LIQUID CRYSTAL POLYMER (LCP),
- TERMINAL: HIGH PERFORMANCE COPPER ALLOY
- SHIELD: STEEL
- THREADED INSERT: BRASS

2. FINISHES:

- TERMINAL: 0.05-0.25 MICROMETERS GOLD FLASH IN CRITICAL AREA OVER 0.75 MICROMETERS MINIMUM PALLADIUM NICKEL IN CRITICAL AREA. 1.87 MICROMETERS MINIMUM MATTE TIN IN SOLDER TAIL AREA. OVERALL NICKEL UNDERPLATE.
- BRACKET: 5.0 MICROMETERS MINIMUM BRIGHT TIN OVER A COPPER UNDERPLATE.
- SHIELD: 3.8 MICROMETERS MINIMUM BRIGHT TIN OVER 1.3 MICROMETERS MINIMUM NICKEL OVER COPPER FLASH (OPTIONAL).
- THREADED INSERT: 2.54 MICROMETERS MINIMUM NICKEL.

3. PART CONFORMS TO MOLEX PRODUCT SPECIFICATION PS-71425-9999.

4. PRODUCT IS PACKAGED PER PK-71430-0101.

5. APPLICABLE STANDARDS: EIA-3652 AND SFF-8441.

6. DATE CODE: YR/WK PER EIA-476-A.

7. PRODUCT COMPLIES WITH COSMETIC SPECIFICATION PS-45499-002. SEE SIDE VIEW FOR SURFACE CLASSIFICATIONS.

8. TORQUE TO INSTALL SCREWLOCKS INTO THREADED INSERTS: 0.34 Nm MAXIMUM.

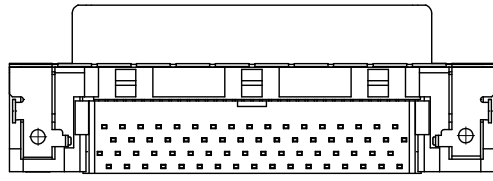
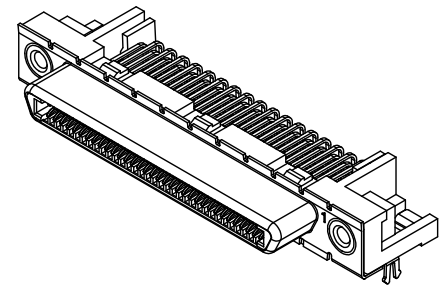
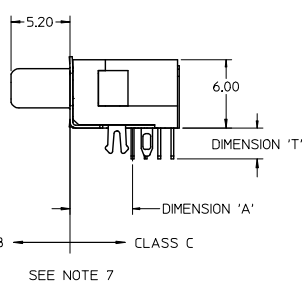
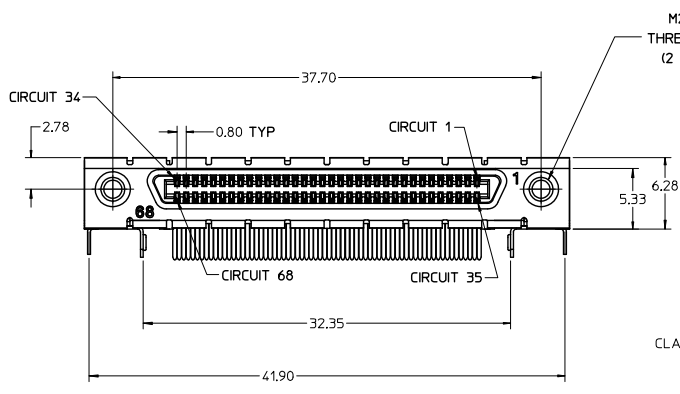
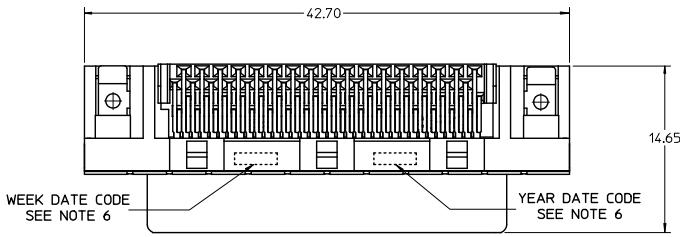

ADD PART 71430-3020 EC NO: UCP2015-5280 DRW: BTBARRA 2015/06/12 CHK: BBARKER 2015/06/30 APPR: SMILLER 2015/07/20	QUALITY SYMBOLS	GENERAL TOLERANCES (UNLESS SPECIFIED)	DIMENSION STYLE	SCALE	DESIGN UNITS	THIRD ANGLE PROJECTION
	∇=0 ∇=0.13 ∇=0.25	mm INCH 4 PLACES ± --- ± --- 3 PLACES ± --- ± --- 2 PLACES ± 0.13 ± --- 1 PLACE ± 0.25 ± --- 0 PLACE ± ±	MM ONLY	4:1	METRIC	TITLE: VHDCI RIGHT ANGLE ASSEMBLY molex DOCUMENT NO. SD-71430-3000 SHEET NO. 1 OF 3
	ANGULAR ± 1/2° DRAFT WHERE APPLICABLE MUST REMAIN WITHIN DIMENSIONS	DRAWN BY: BBARKER 2011/02/17 CHECKED BY: BSMART 2011/02/17 APPROVED BY: SMILLER 2011/02/25	SEE TABLE			
	REV	SIZE C	THIS DRAWING CONTAINS INFORMATION THAT IS PROPRIETARY TO MOLEX INCORPORATED AND SHOULD NOT BE USED WITHOUT WRITTEN PERMISSION			

PCB THICKNESS	PART NUMBER	TAIL LENGTH *T* +0.50/-0.25	ENHANCED GROUND TABS	SCREWLOCKS (SEE GUIDELINE FOR CHOOSING A SCREWLOCK ON SHEET 3)	TAIL LOCATION *A*	PCB HOLE LOCATION *B*
1.60		2.08	NO	NONE	5.50	6.50 MAXIMUM
1.60		2.08	NO	71433-2002 LOOSE IN BAGS		
1.60		2.08	YES	NONE		
1.60		2.08	YES	71433-2002 LOOSE IN BAGS		
2.36		2.71	NO	NONE		
2.36		2.71	NO	71433-2002 INSTALLED		
2.36		2.71	YES	NONE		
2.36		2.71	YES	71433-2002 INSTALLED		
2.36		2.71	NO	71433-2002 LOOSE IN BAGS		
2.36	71430-3019	2.71	YES	71433-2002 LOOSE IN BAGS		
2.79	71430-3020	3.62	YES	71433-2002 LOOSE IN BAGS	5.30	6.30 MAXIMUM
2.36		2.71	YES	NONE		
1.60		2.08	YES	NONE		

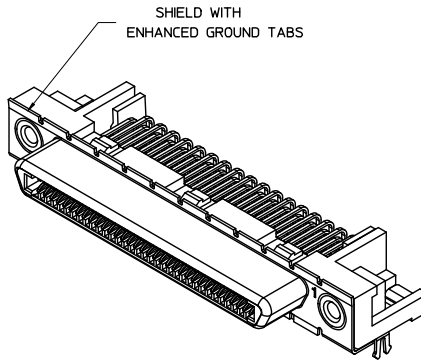
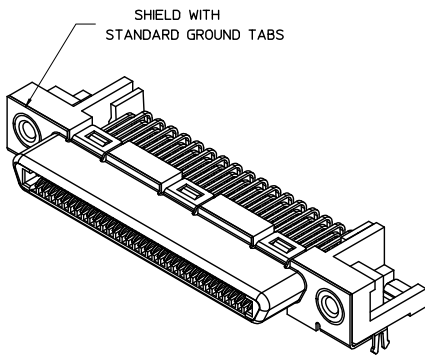

OPTIONAL SCREWLOCK
PART NUMBER 71433-2002 SHOWN
(SEE GUIDELINE FOR CHOOSING A SCREWLOCK ON SHEET 3)

SEE SHEET 1 IEC NO: UCP2015-5280 DRAWN BY: DRWNET1BARRA 2015/06/12 CHECKED BY: CHKKBARKER 2015/06/30 APPROVED BY: APPRSMILLER 2015/07/20	QUALITY SYMBOLS □=0 ▽=0 ▽=0	GENERAL TOLERANCES (UNLESS SPECIFIED)		DIMENSION STYLE		SCALE	DESIGN UNITS	THIRD ANGLE PROJECTION	
				MM ONLY		4:1	METRIC	☉	
		4 PLACES ±	±	mm	INCH	DRAWN BY	DATE	TITLE	
		3 PLACES ±	±			BBARKER	2011/02/17	VHDCI RIGHT ANGLE ASSEMBLY	
2 PLACES ±	±			CHECKED BY	DATE	molex			
1 PLACE ±	±			BSMART	2011/02/17	SD-71430-3000			
0 PLACE ±	±			APPROVED BY	DATE	SHEET NO.			
				SMILLER	2011/02/25	2 OF 3			
ANGULAR ±1/2°		MATERIAL NO.		DOCUMENT NO.					
DRAFT WHERE APPLICABLE MUST REMAIN WITHIN DIMENSIONS		SEE TABLE		THIS DRAWING CONTAINS INFORMATION THAT IS PROPRIETARY TO MOLEX INCORPORATED AND SHOULD NOT BE USED WITHOUT WRITTEN PERMISSION					

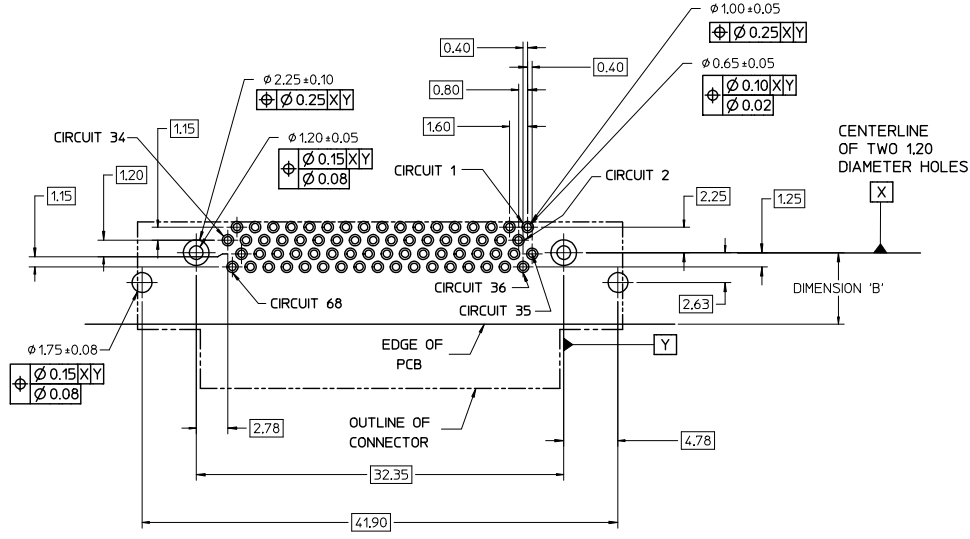

NOTES:

1. FOR FULL MATE WITH PLUG, PANEL THICKNESS SHOULD NOT EXCEED 1.0mm.

FUNCTIONAL MATING WITH MOLEX PLUG CAN STILL BE MAINTAINED WITH PANELS AS THICK AS 2.5mm (BUT PLUG AND RECEPTACLE WILL NOT BE FULLY MATED).

2. GUIDELINE FOR CHOOSING A MOLEX SCREWLOCK:

PANEL THICKNESS	RECOMMENDED SCREWLOCK
LESS THAN OR EQUAL TO 1.00 MM	71433-2002
1.01 TO 2.15 MM	71433-2010

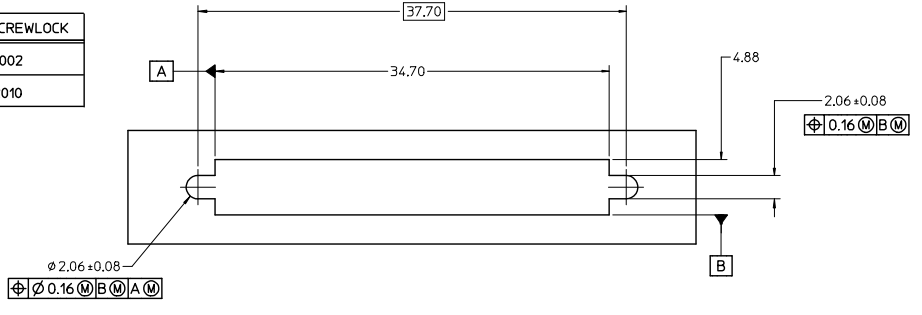

SEE SHEET 1 EC NO: UCP2015-5280 DRAWN BY: IRWIN TIBARRA 2015/06/12 CHECKED BY: BBARKER 2015/06/30 APPROVED BY: SMILLER 2015/07/20	QUALITY SYMBOLS	GENERAL TOLERANCES (UNLESS SPECIFIED)	DIMENSION STYLE	SCALE	DESIGN UNITS	THIRD ANGLE PROJECTION
	▽=0	mm INCH	MM ONLY	4:1	METRIC	THIRD ANGLE PROJECTION
	▽=0	4 PLACES ± --- ± ---	DRAWN BY: BBARKER DATE: 2011/02/17	TITLE	VHDCI RIGHT ANGLE ASSEMBLY	
	▽=0	3 PLACES ± --- ± ---	CHECKED BY: BSMART DATE: 2011/02/17			
▽=0	2 PLACES ± 0.13 ± ---	APPROVED BY: SMILLER DATE: 2011/02/25	MATERIAL NO.			
▽=0	1 PLACE ± 0.25 ± ---	0 PLACE ± ±	ANGULAR ± 1/2°	SEE TABLE	SD-71430-3000	3 OF 3
▽=0	DRAFT WHERE APPLICABLE MUST REMAIN WITHIN DIMENSIONS		THIS DRAWING CONTAINS INFORMATION THAT IS PROPRIETARY TO MOLEX INCORPORATED AND SHOULD NOT BE USED WITHOUT WRITTEN PERMISSION			