

## Excellent Integrated System Limited

Stocking Distributor

Click to view price, real time Inventory, Delivery & Lifecycle Information:

[C&K Components](#)

[GDS001](#)

For any questions, you can email us directly:

[sales@integrated-circuit.com](mailto:sales@integrated-circuit.com)

# GDS Series Ultra Low Profile Micro Mini Side Actuated Detect Switch

### Features/Benefits

- Ultra low profile package sits just 1.0 mm off PCB
- Design allows x or y axis actuation
- Low actuation force, 30 grams max.
- Pick and place compatible, available in tape & reel packaging
- RoHS compliant and compatible

### Typical Applications

- Consumer electronics
- Computers
- Medical devices
- Mobile Communication Devices
- ATCA and MicroTCA devices



### Specifications

CONTACT RATING: 1 mA 5 VDC

MECHANICAL AND ELECTRICAL LIFE: 50,000 cycles min.

CONTACT RESISTANCE: 1 Ω max. initial.

INSULATION RESISTANCE: 100 M Ω min. between adjacent contacts.

OPERATING TEMPERATURE: -20°C to + 70°C

STORAGE TEMPERATURE: -30°C to + 80°C

PACKAGING: Tape & reel, 5000 pieces per reel

TRAVEL:

Pre-travel .3 mm min.

Overtravel: .9 mm min.

Total: 1.6 mm min.

### Materials

BASE: LCP

COVER: PA 46 (UL94V-0)

ACTUATOR: PA 46 (UL94V-0)

MOVABLE BLADE: Stainless Steel, Ag over Ni plating.

TERMINALS: Phosphor Bronze, Ag over Ni plating.

**NOTE:** Specifications and materials listed above are for switches with standard options. For information on specific and custom switches, consult Customer Service Center.

### Build-A-Switch

Complete part numbers for GDS Series are shown below.

PART NUMBER	PACKAGING	SCHEMATIC
<b>GDS001</b>	TAPE & REEL 5,000 per reel	

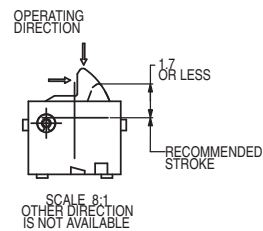
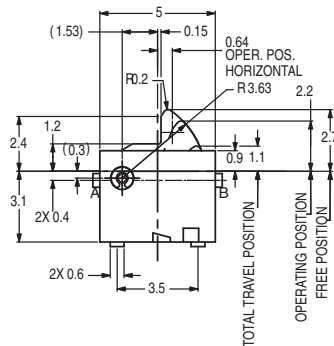
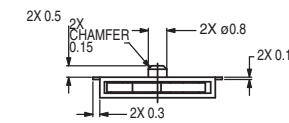
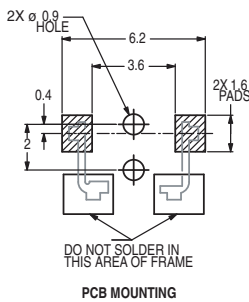

GDS001

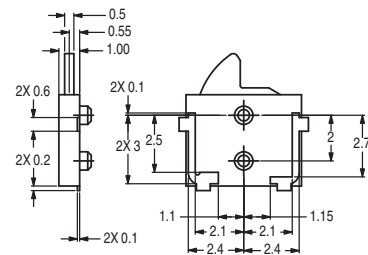

### TAPE & REEL

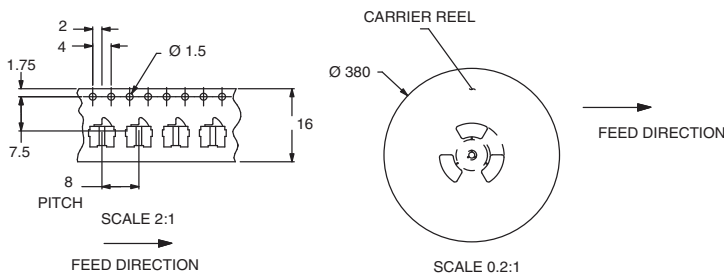

Third Angle Projection

Dimensions are shown: mm  
Specifications and dimensions subject to change