

Excellent Integrated System Limited

Stocking Distributor

Click to view price, real time Inventory, Delivery & Lifecycle Information:

[Molex Connector Corporation](#)
[1200900029](#)

For any questions, you can email us directly:

sales@integrated-circuit.com

5

4

3

2

1

MATERIAL NUMBER	OLD PART NUMBER	FINISHED LENGTH
120090-0016	4R3P00A27C300	11.81' +.75' -0 [.3M +19.1 -0]
120090-0018	4R3P00A27M010	3.28' +2.19' -0 [1.0M +55.6 -0]
120090-0029	4R4P00A27C300	11.81' +.75' -0 [.3M +19.1 -0]
120090-0031	4R4P00A27M010	3.28' +2.19' -0 [1.0M +55.6 -0]
120090-0037	4R5P00A27C300	11.81' +.75' -0 [.3M +19.1 -0]

3 POLE FEMALE FACE VIEW

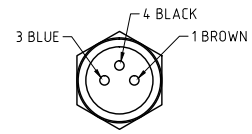

4 POLE FEMALE FACE VIEW

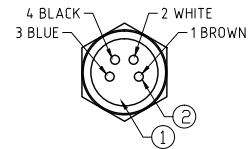

5 POLE FEMALE FACE VIEW

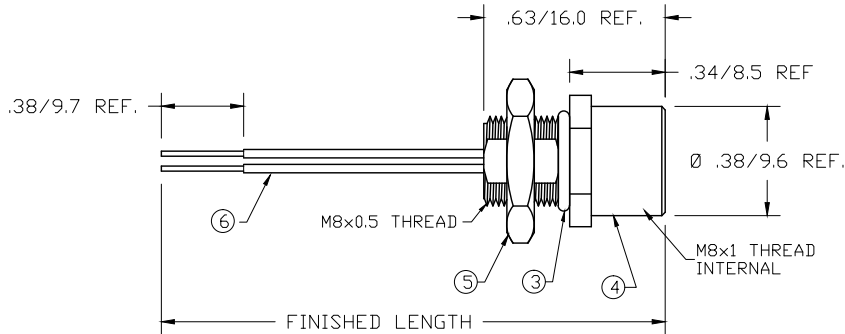
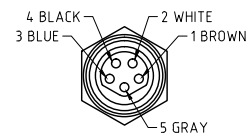

VOLTAGE RATING FOR 3 AND 4 POLE	60 VAC/ 75 VDC
VOLTAGE RATING FOR 5 POLE	30 VAC/VDC
AMPERAGE RATING FOR 3 AND 4 POLE	3 AMPS
AMPERAGE RATING FOR 5 POLE	3 AMPS
PROTECTION	IP67
OPERATING TEMPERATURE	-20°C TO 105°C
UL CERTIFICATIONS	UL LISTED, FILE NO. E152210
CSA CERTIFICATIONS	CSA CERTIFIED, FILE NO. LR6837

ITEM	COMPONENT	MATERIAL	FINISH
1	INSERT	POLYURETHANE	BLACK
2	CONTACT PIN	COPPER ALLOY	GOLD OVER NICKEL
3	O-RING	NITRILE	BLACK
4	RECEPTACLE SHELL	BRASS	NICKEL PLATED
5	LOCKNUT	BRASS	NICKEL PLATED
6	CONDUCTOR- 24 AWG, (.22mm) COPPER STRANDING) 3 CONDUCTOR	PVC	SEE WIRING DIAGRAM

RLSD DRAWING	11/10/11	I
EC NO: WEU2012-0155	DRWN: VOU	CHKD: KJOZMK
	APPR: JFMURPHY	2009/08/28
	REV	

QUALITY SYMBOLS	▽=0	▽=0
-----------------	-----	-----

GENERAL TOLERANCES (UNLESS SPECIFIED)		
	mm	INCH
4 PLACES	±.005	±.0005
3 PLACES	±.01	±.001
2 PLACES	±.015	±.002
1 PLACE	±.03	±.005
ANGULAR ±1/2°		
DRAFT WHERE APPLICABLE MUST REMAIN WITHIN DIMENSIONS		

DIMENSION STYLE	IN/MM
SCALE	2:1
DESIGN UNITS	METRIC
THIRD ANGLE PROJECTION	
DRAWN BY DATE	
BW	2009/08/26
CHECKED BY DATE	
LH	2009/08/26
APPROVED BY DATE	
JFMURPHY	2009/08/28
MATERIAL NO.	
SEE CHART	
DOCUMENT NO.	
SD-120090-009	
SHEET NO.	
1 OF 1	

**M8 FEMALE RECEPTACLE
3-5P M8X0.5 MOUNTING THD**



MOLEX INCORPORATED

SIZE

A

THIS DRAWING CONTAINS INFORMATION THAT IS PROPRIETARY TO MOLEX INCORPORATED AND SHOULD NOT BE USED WITHOUT WRITTEN PERMISSION

6

5

4

3

2

1