

Excellent Integrated System Limited

Stocking Distributor

Click to view price, real time Inventory, Delivery & Lifecycle Information:

[Molex Connector Corporation](#)
[1200710044](#)

For any questions, you can email us directly:

sales@integrated-circuit.com

MATERIAL NUMBER	ENGINEERING NUMBER
1200710044	8A5001-31

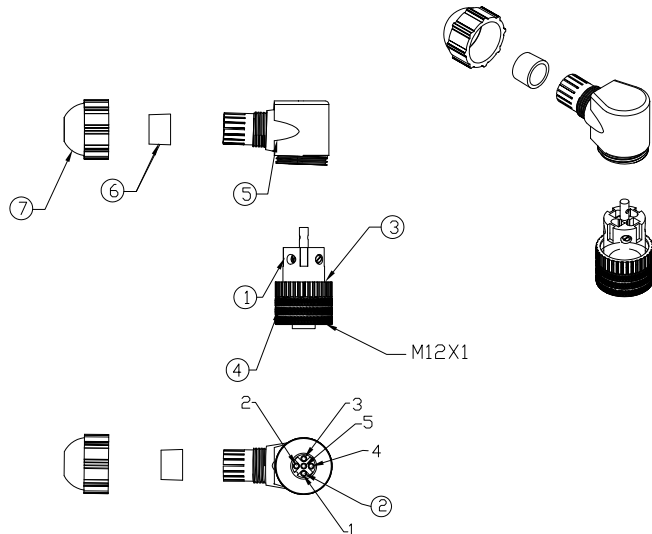
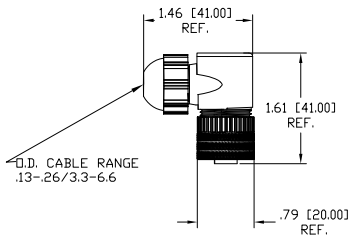

FEMALE FACE VIEW

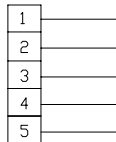

WIRING CHART

ITEM	QTY	COMPONENT	MATERIAL	FINISH
1	1	INSERT	POLYAMIDE	BLACK
2	5	CONTACTS	COPPER ALLOY	SILVER PLATED
3	1	O-RING	NITRILE	BLACK
4	1	COUPLING NUT	BRASS	NICKEL PLATED
5	1	MOLDED BODY	POLYAMIDE	BLACK
6	1	GROMMET	NITRILE	BLACK
7	1	CORD GRIP BODY	POLYAMIDE	BLACK

VOLTAGE RATING	30VAC/36VDC
AMPERAGE RATING	4 AMPS
PROTECTION	IP67
OPERATING TEMPERATURE	-25°C TO 90°C
CSA CERTIFICATIONS	CSA CERTIFIED, FILE NO. LR6837

RELEASE EC NO: WEL2010-0045 DRAWN: TWOLDEGE 01/01/09 CHECKED: BWOODMAN APPR: JHURPHY 20/09/07 REV: A	QUALITY SYMBOL ▽=0 ▽=0 ANGLAR ±---° DRAFT WHERE APPLICABLE MUST REMAIN WITHIN DIMENSIONS	GENERAL TOLERANCES (UNLESS SPECIFIED)		DIMENSION STYLE -----		SCALE	DESIGN UNITS	THIRD ANGLE PROJECTION	
		mm	INCH	-----	INCH	-----	-----	-----	
		4 PLACES	±---	±---	TWOLDEGE	2009/08/18	TITLE MIC 5P FEMALE ATTACH 90D .13-.26 O.D. CABLE RANGE PG7 CABLE FITTING		
		3 PLACES	±---	±---	BWOODMAN	2009/08/18	MOLEX INCORPORATED MATERIAL NO. 1200710044 DOCUMENT NO. SD-120071-010 SHEET NO. 1 OF 1		