

Excellent Integrated System Limited

Stocking Distributor

Click to view price, real time Inventory, Delivery & Lifecycle Information:

[Molex Connector Corporation](#)
[1200750016](#)

For any questions, you can email us directly:
sales@integrated-circuit.com

MATERIAL NUMBER	ENGINEERING NUMBER
1200750016	7A3001-31

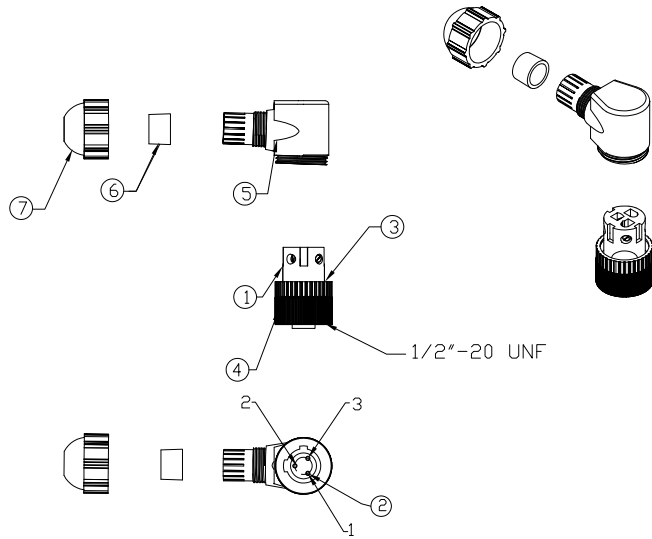
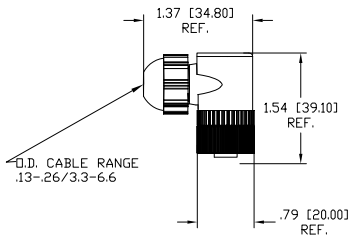

FEMALE FACE VIEW

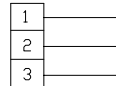

WIRING CHART

VOLTAGE RATING	250VAC/DC
AMPERAGE RATING	4 AMPS
PROTECTION	IP67
OPERATING TEMPERATURE	-40°C TO 185°C

ITEM	QTY	COMPONENT	MATERIAL	FINISH
1	1	INSERT	NYLON	BLACK
2	3	CONTACTS	COPPER ALLOY	GOLD PLATED
3	1	O-RING	NITRILE	BLACK
4	1	COUPLING NUT	BRASS	NICKEL PLATED
5	1	MOLDED BODY	NYLON	BLACK
6	1	GROMMET	NITRILE	BLACK
7	1	CORD GRIP BODY	NYLON	BLACK

RELEASE EC NO: WEL2010-0045 DRAWN: TWOLDEGE 02/01/09 CHECKED: BWOODMAN APPR: JHURPHY 20/09/02 DESCRIPTION REV: A	QUALITY SYMBOL ▽=0 ▽=0 ANGLAR ±.5° DRAFT WHERE APPLICABLE MUST REMAIN WITHIN DIMENSIONS	GENERAL TOLERANCES (UNLESS SPECIFIED)		DIMENSION STYLE -----		SCALE	DESIGN UNITS	THIRD ANGLE PROJECTION	
		mm	INCH	-----	INCH	-----	INCH	-----	-----
		4 PLACES	±.00	±.00	DRAWN BY: TWOLDEGE DATE: 2009/08/20		TITLE: MIC 3P FE DK ATTACH 90D .13-.26 O.D. CABLE RANGE PG7 CABLE FITTING		
		3 PLACES	±.00	±.01	CHECKED BY: BWOODMAN DATE: 2009/08/20		MOLEX INCORPORATED MATERIAL NO. 1200750016 DOCUMENT NO. SD-120075-002 SHEET NO. 1 OF 1		
2 PLACES	±.00	±.01	APPROVED BY: _____ DATE: _____		THIS DRAWING CONTAINS INFORMATION THAT IS PROPRIETARY TO MOLEX INCORPORATED AND SHOULD NOT BE USED WITHOUT WRITTEN PERMISSION				
1 PLACE	±0.3	±.01							