

Excellent Integrated System Limited

Stocking Distributor

Click to view price, real time Inventory, Delivery & Lifecycle Information:

[Weidmüller](#)
[1944000000](#)

For any questions, you can email us directly:
sales@integrated-circuit.com

Product catalogue | PCB connection systems | PCB plug-in connectors | Pitch 5.00 / 5.08 mm (0.197 / 0.200 inch) |
 Socket connectors, tension clamp connection, pitch 5.00/5.08 | BLZP 5.00/5.08/180 | BLZP 5.08/180 SN

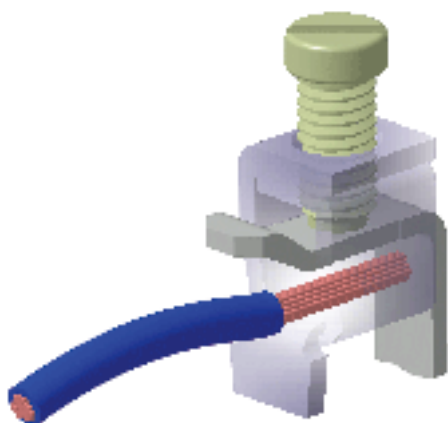
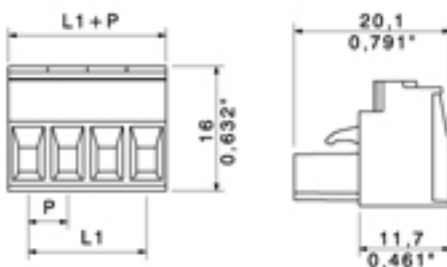

General ordering data

| | |
|------------------|--|
| Order No. | 1944000000 |
| Part designation | BLZP 5.08/21/180 SN BK BX |
| Version | PCB plug-in connector, Clamping yoke connection, Clamping range, max.: 4 mm ² , Pitch in mm: 5.08 mm, No. of poles: 21, 180°, Box |
| EAN | 4032248618187 |
| Qty. | 18 pc(s). |
| Packaging | Box |

System parameters

| | |
|---------------------------------|--------------------------|
| Conductor connection system | Clamping yoke connection |
| Outgoing direction of conductor | 180° |
| Pitch in mm | 5.08 mm |
| Pitch in inch | 0.2 inch |
| No. of poles | 21 |
| No. of rows | 1 |
| Screwdriver blade | 0.6 x 3.5 |

Product catalogue | PCB connection systems | PCB plug-in connectors | Pitch 5.00 / 5.08 mm (0.197 / 0.200 inch) | Socket connectors, tension clamp connection, pitch 5.00/5.08 | BLZP 5.00/5.08/180 | BLZP 5.08/180 SN

System parameters

| | |
|---|------------------------|
| Screwdriver blade standard | DIN 5264 |
| Tightening torque, min. | 0.4 Nm |
| Tightening torque, max. | 0.5 Nm |
| Clamping screw | M 2.5 |
| Stripping length | 7 mm |
| L1 in mm | 101.6 mm |
| L1 in inch | 4 inch |
| Electric shock protection to DIN VDE 57 106 | Safe from finger touch |

Material data

| | |
|--------------------------|--------------|
| Insulating material | PBT |
| Colour | black |
| Flammability class UL 94 | V-0 |
| CTI | >= 200 |
| Contact material | Copper alloy |
| Contact surface | tinned |
| Contact base material | Copper alloy |

Connectable conductors

| | |
|---|----------------------|
| Clamping range, min. | 0.13 mm ² |
| Clamping range, max. | 4 mm ² |
| Conductor connection cross-section AWG, min. | AWG 26 |
| Conductor connection cross-section AWG, max. | AWG 12 |
| Solid, min. H05(07) V-U | 0.2 mm ² |
| Solid, max. H05(07) V-U | 4 mm ² |
| Flexible, min. H05(07) V-K | 0.2 mm ² |
| Flexible, max. H05(07) V-K | 4 mm ² |
| w. wire end ferrule, DIN 46228 pt 1, min | 0.2 mm ² |
| with wire end ferrule, DIN 46228 pt 1, max. | 4 mm ² |
| w. plastic collar ferrule, DIN 46228 pt 4, min. | 0.2 mm ² |
| with plastic collar ferrule, DIN 46228 pt 4, max. | 2.5 mm ² |
| Gauge to EN 60999 a x b; ø | 2.8 mm x 2.4 mm |

DIN IEC rating data

| | |
|--|-------------------|
| Rated current, min. No. of poles (Tu=20°C) | 19 A |
| Rated current, max. No. of poles (Tu=20°C) | 15.5 A |
| Rated current, no. of poles (Tu=40°C), min. | 16 A |
| Rated current, no. of poles (Tu=40°C), max. | 13 A |
| Rated voltage for overvoltage class/pollution severity II/2 | 400 V |
| Rated voltage for overvoltage class/pollution severity III/2 | 320 V |
| Rated voltage at overvoltage category/pollution degree III/3 | 250 V |
| Rated impulse withstand voltage for overvoltage class/pollution severity II/2 | 4 kV |
| Rated impulse withstand voltage for overvoltage class/pollution severity III/2 | 4 kV |
| Rated impulse withstand voltage for overvoltage class/pollution severity III/3 | 4 kV |
| Short-time withstand current resistance | 3 x 1s with 120 A |

Product catalogue | PCB connection systems | PCB plug-in connectors | Pitch 5.00 / 5.08 mm (0.197 / 0.200 inch) | Socket connectors, tension clamp connection, pitch 5.00/5.08 | BLZP 5.00/5.08/180 | BLZP 5.08/180 SN

DIN IEC rating data

CSA rating data

| | |
|-------------------------------|--------|
| Rated voltage (Use group B) | 300 V |
| Rated current (use group B) | 10 A |
| Rated voltage (Use group C) | 50 V |
| Rated voltage (use group D) | 300 V |
| Rated current (use group D) | 10 A |
| Wire cross-section, AWG, min. | AWG 26 |
| Wire cross-section, AWG, max. | AWG 12 |

UL 1059 rating data

| | |
|-------------------------------|--------|
| Rated voltage (use group B) | 300 V |
| Rated current (use group B) | 10 A |
| Rated voltage (use group C) | 50 V |
| Rated voltage | 300 V |
| Rated current | 10 A |
| Wire cross-section, AWG, min. | AWG 26 |
| Wire cross-section, AWG, max. | AWG 12 |

Approvals

| | |
|----------------------|-------|
| Approvals institutes | CURUS |
|----------------------|-------|

Classifications

| | |
|------------|-------------|
| eClass 6.0 | 27-26-07-08 |
|------------|-------------|

Notes

Notes

Similar products

| Order No. | Part designation | Version |
|------------|---------------------------|--|
| 1943580000 | BLZP 5.08/02/180 SN OR BX | PCB plug-in connector, Clamping yoke connection, Clamping range, max.: 4 mm ² , Pitch in mm: 5.08 mm, No. of poles: 2, 180°, Box |
| 1943590000 | BLZP 5.08/03/180 SN OR BX | PCB plug-in connector, Clamping yoke connection, Clamping range, max.: 4 mm ² , Pitch in mm: 5.08 mm, No. of poles: 3, 180°, Box |
| 1943600000 | BLZP 5.08/04/180 SN OR BX | PCB plug-in connector, Clamping yoke connection, Clamping range, max.: 4 mm ² , Pitch in mm: 5.08 mm, No. of poles: 4, 180°, Box |
| 1943610000 | BLZP 5.08/05/180 SN OR BX | PCB plug-in connector, Clamping yoke connection, Clamping range, max.: 4 mm ² , Pitch in mm: 5.08 mm, No. of poles: 5, 180°, Box |
| 1943620000 | BLZP 5.08/06/180 SN OR BX | PCB plug-in connector, Clamping yoke connection, Clamping range, max.: 4 mm ² , Pitch in mm: 5.08 mm, No. of poles: 6, 180°, Box |
| 1943630000 | BLZP 5.08/07/180 SN OR BX | PCB plug-in connector, Clamping yoke connection, Clamping range, max.: 4 mm ² , Pitch in mm: 5.08 mm, No. of poles: 7, 180°, Box |
| 1943640000 | BLZP 5.08/08/180 SN OR BX | PCB plug-in connector, Clamping yoke connection, Clamping range, max.: 4 mm ² , Pitch in mm: 5.08 mm, No. of poles: 8, 180°, Box |
| 1943650000 | BLZP 5.08/09/180 SN OR BX | PCB plug-in connector, Clamping yoke connection, Clamping range, max.: 4 mm ² , Pitch in mm: 5.08 mm, No. of poles: 9, 180°, Box |
| 1943660000 | BLZP 5.08/10/180 SN OR BX | PCB plug-in connector, Clamping yoke connection, Clamping range, max.: 4 mm ² , Pitch in mm: 5.08 mm, No. of poles: 10, 180°, Box |

Product catalogue | PCB connection systems | PCB plug-in connectors | Pitch 5.00 / 5.08 mm (0.197 / 0.200 inch) | Socket connectors, tension clamp connection, pitch 5.00/5.08 | BLZP 5.00/5.08/180 | BLZP 5.08/180 SN

| | | |
|------------|---------------------------|--|
| 1943670000 | BLZP 5.08/11/180 SN OR BX | PCB plug-in connector, Clamping yoke connection, Clamping range, max.: 4 mm ² , Pitch in mm: 5.08 mm, No. of poles: 11, 180°, Box |
| 1943680000 | BLZP 5.08/12/180 SN OR BX | PCB plug-in connector, Clamping yoke connection, Clamping range, max.: 4 mm ² , Pitch in mm: 5.08 mm, No. of poles: 12, 180°, Box |
| 1943690000 | BLZP 5.08/13/180 SN OR BX | PCB plug-in connector, Clamping yoke connection, Clamping range, max.: 4 mm ² , Pitch in mm: 5.08 mm, No. of poles: 13, 180°, Box |
| 1943700000 | BLZP 5.08/14/180 SN OR BX | PCB plug-in connector, Clamping yoke connection, Clamping range, max.: 4 mm ² , Pitch in mm: 5.08 mm, No. of poles: 14, 180°, Box |
| 1943710000 | BLZP 5.08/15/180 SN OR BX | PCB plug-in connector, Clamping yoke connection, Clamping range, max.: 4 mm ² , Pitch in mm: 5.08 mm, No. of poles: 15, 180°, Box |
| 1943720000 | BLZP 5.08/16/180 SN OR BX | PCB plug-in connector, Clamping yoke connection, Clamping range, max.: 4 mm ² , Pitch in mm: 5.08 mm, No. of poles: 16, 180°, Box |
| 1943730000 | BLZP 5.08/17/180 SN OR BX | PCB plug-in connector, Clamping yoke connection, Clamping range, max.: 4 mm ² , Pitch in mm: 5.08 mm, No. of poles: 17, 180°, Box |
| 1943740000 | BLZP 5.08/18/180 SN OR BX | PCB plug-in connector, Clamping yoke connection, Clamping range, max.: 4 mm ² , Pitch in mm: 5.08 mm, No. of poles: 18, 180°, Box |
| 1943750000 | BLZP 5.08/19/180 SN OR BX | PCB plug-in connector, Clamping yoke connection, Clamping range, max.: 4 mm ² , Pitch in mm: 5.08 mm, No. of poles: 19, 180°, Box |
| 1943760000 | BLZP 5.08/20/180 SN OR BX | PCB plug-in connector, Clamping yoke connection, Clamping range, max.: 4 mm ² , Pitch in mm: 5.08 mm, No. of poles: 20, 180°, Box |
| 1943770000 | BLZP 5.08/21/180 SN OR BX | PCB plug-in connector, Clamping yoke connection, Clamping range, max.: 4 mm ² , Pitch in mm: 5.08 mm, No. of poles: 21, 180°, Box |
| 1943780000 | BLZP 5.08/22/180 SN OR BX | PCB plug-in connector, Clamping yoke connection, Clamping range, max.: 4 mm ² , Pitch in mm: 5.08 mm, No. of poles: 22, 180°, Box |
| 1943790000 | BLZP 5.08/23/180 SN OR BX | PCB plug-in connector, Clamping yoke connection, Clamping range, max.: 4 mm ² , Pitch in mm: 5.08 mm, No. of poles: 23, 180°, Box |
| 1943800000 | BLZP 5.08/24/180 SN OR BX | PCB plug-in connector, Clamping yoke connection, Clamping range, max.: 4 mm ² , Pitch in mm: 5.08 mm, No. of poles: 24, 180°, Box |